

Interval 60 Min. 15 Min.
 2 Tube Classification
 Lane No. 1 2
 1 Channel Tube A+B
 2 Channel Tube A, B
 Direction Channel A _____
 Direction Channel B _____
 Module No. 20202

Counter No. 5049 Count ID HPMS
 SR 501 RRT CO VANCVR MP 1.00
 Leg 1 Direction EB OSID _____

Station Description - ON SR501 (CO VANCVR) W/O C Street
COUPLET

Date	Day	Time	Comments
6/9/03	2	1227	Manual A <u>5</u> B _____ Counter A <u>5</u> B _____ <i>set o.k. JMIGH 6.6</i>
6/10	3	0736	Manual A <u>52</u> B _____ Counter A <u>52</u> B _____ <i>check o.k. JMIGH 6.7</i>
6/11	4	1204	Manual A <u>55</u> B _____ AC=1 Counter A <u>56</u> B _____ <i>check o.k. JMIGH 6.6</i>
6/12	5	1124	Manual A <u>73</u> B _____ AC=2 Counter A <u>75</u> B _____ <i>check o.k. JMIGH 6.6</i>
6/13	6	0703	Manual A _____ B _____ Counter A _____ B _____ <i>Tube up (broken)</i> PIU JMIGH 6.6

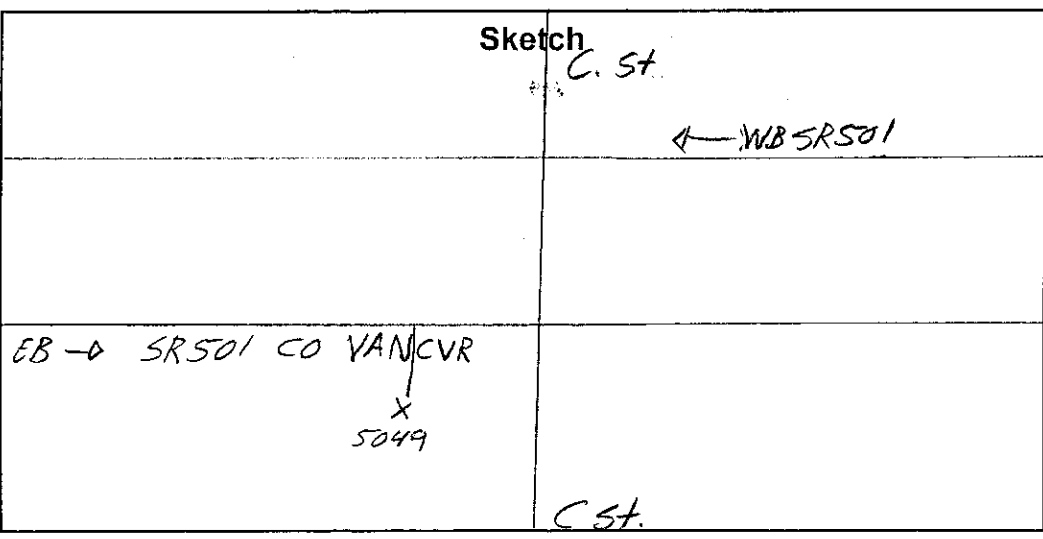

J. Mills / G. Heathcott
 Field Person

STATE OF WASHINGTON - DEPARTMENT OF TRANSPORTATION
TRIP SYSTEM
15 MINUTE TRAFFIC COUNT SUMMARY

SR 501 COVANCVR MP 001.00 OFF SYSTEM ID. LEG 1 DIRECTION OF TRAFFIC EASTBOUND LANE ALL OF

COUNT IDENTIFIER HPMS COUNTER NUMBER 005049 DESCRIPTION: ON SR 501 COUPLET (COVANCVR) W/O C ST

COUNT IDENTIFIER	HPMS	COUNTER NUMBER	AM HOURS												PM HOURS	AM TOTAL	PM TOTAL	DAILY TOTAL											
			1	2	3	4	5	6	7	8	9	10	11	12															
06/09/03 MONDAY			12	1	2	3	4	5	6	7	8	9	10	11	12	285	294	291	309	463	196	104	69	68	46	38			
			1	2	3	4	5	6	7	8	9	10	11	12	261	278	253	318	464	135	94	81	57	42	31	27			
															271	250	314	291	351	314	130	65	82	45	36	27			
															257	261	268	341	339	192	125	67	72	61	31	25			
TOT			528	1057	1154	1176	1317	1433	586	330	304	231	155	121	8392														

AM PEAK HOUR 0000 TO 0000 VOLUME 0
PM PEAK HOUR 0430 TO 0530 VOLUME 1617

COUNT IDENTIFIER	HPMS	COUNTER NUMBER	AM HOURS												PM HOURS	AM TOTAL	PM TOTAL	DAILY TOTAL													
			1	2	3	4	5	6	7	8	9	10	11	12																	
06/10/03 TUESDAY			12	1	2	3	4	5	6	7	8	9	10	11	12	212	215	226	252	345	267	268	280	332	472	204	111	93	78	59	42
			1	2	3	4	5	6	7	8	9	10	11	12	163	211	274	251	288	265	251	316	313	410	178	116	78	65	61	44	
															206	243	246	273	235	283	314	321	343	338	131	78	113	62	65	28	
															202	210	228	254	282	278	294	309	345	248	114	103	94	73	40	31	
TOT			783	879	974	1030	1150	1093	1127	1226	1333	1468	627	408	378	278	225	145	14720												

AM PEAK HOUR 1100 TO 1200 VOLUME 1030
PM PEAK HOUR 0430 TO 0530 VOLUME 1570

COUNT IDENTIFIER	HPMS	COUNTER NUMBER	AM HOURS												PM HOURS	AM TOTAL	PM TOTAL	DAILY TOTAL													
			1	2	3	4	5	6	7	8	9	10	11	12																	
06/11/03 WEDNESDAY			12	1	2	3	4	5	6	7	8	9	10	11	12	180	209	257	275	315	267	272	268	324	472	208	134	86	90	72	59
			1	2	3	4	5	6	7	8	9	10	11	12	144	211	243	264	286	267	308	278	293	446	166	109	81	92	67	51	
															159	241	246	256	284	246	314	291	314	314	119	102	95	63	64	49	
															167	225	226	335	269	271	295	324	325	263	134	86	94	63	44	55	
TOT			650	886	972	1130	1154	1051	1189	1161	1256	1495	627	431	356	308	247	214	14808												

AM PEAK HOUR 1100 TO 1200 VOLUME 1130
PM PEAK HOUR 0445 TO 0545 VOLUME 1557

SR 501 COVANCVR MP 001.00 OFF SYSTEM ID. LEG 1 DIRECTION OF TRAFFIC EASTBOUND LANE ALL OF

COUNT IDENTIFIER HPMS COUNTER NUMBER 005049 DESCRIPTION: ON SR 501 COUPLET (COVANCVR) W/O C ST

06/12/03	THURSDAY												DAILY													
	AM HOURS						PM HOURS																			
	1	2	3	4	5	6	7	8	9	10	11	12	1	2	3	4	5	6	7	8	9	10	11	12	TOTAL	
00-15	12	1	2	3	4	5	6	7	8	9	10	11	12	1	2	3	4	5	6	7	8	9	10	11	12	140
15-30	28	32	24	24	10	28	37	75	133	166	176	257	271	321	252	302	291	398	505	249	126	74	85	40		
30-45	39	24	19	19	35	61	74	150	208	185	242	289	348	274	301	323	306	465	165	124	107	67	58	42		
45-00	30	38	26	14	22	74	89	242	175	227	242	256	325	302	331	315	383	324	142	106	68	51	31	31		
TOT	20	41	14	8	25	63	129	226	194	242	243	290	282	286	291	305	368	234	137	97	83	63	46	27		
TOT	117	135	83	51	110	235	367	751	743	830	984	1106	1276	1114	1225	1234	1455	1528	693	453	332	283	232	15477		

06/13/03	FRIDAY												DAILY													
	AM HOURS						PM HOURS																			
	1	2	3	4	5	6	7	8	9	10	11	12	1	2	3	4	5	6	7	8	9	10	11	12	TOTAL	
00-15	12	1	2	3	4	5	6	7	8	9	10	11	12	1	2	3	4	5	6	7	8	9	10	11	12	113
15-30	34	31	24	24	10	28	37	75	133	166	176	257	271	321	252	302	291	398	505	249	126	74	85	40		
30-45	22	23	34	15	22	74	89	242	175	227	242	256	325	302	331	315	383	324	142	106	68	51	31	31		
45-00	21	37	8	8	25	63	129	226	194	242	243	290	282	286	291	305	368	234	137	97	83	63	46	27		
TOT	93	109	81	28	110	235	367	751	743	830	984	1106	1276	1114	1225	1234	1455	1528	693	453	332	283	232	15477		

06/09/03 THRU 06/13/03 89

3 DAYS

AVG WEEKDAY VOL 15002 X SEASONAL ADJ. FACTOR 0.9000 = 13502 X AXLE CORR FACTOR 0.9455 = ESTIMATED AVG DAILY TRAFFIC 12766

PEAK HOUR PERCENTAGES: K = 11.47 D = 100.00

PEAK HOUR LOCATION : VOLUME = 1721 DATE: 06/12/03 TIME: 04:30 PM

AM PEAK HOUR 0130 TO 0230 VOLUME 113

PM PEAK HOUR 0000 TO 0000 VOLUME 0

311



Interval 60 Min. 15 Min.
 2 Tube Classification
 Lane No. 1 2
 1 Channel Tube A+B
 2 Channel Tube A, B
 Direction Channel A _____
 Direction Channel B _____
 Module No. 70210

Counter No. 5006 Count ID HPMS
 SR 501 RRT CO VANCVR MP 1.00
 Leg 2 Direction EB OSID _____

Station Description - ON SR501 (CO VANCVR) E/O C. Street
COUPLET

Date	Day	Time	Comments
6/9/03	2	1232	Manual A 9 B _____ Counter A 9 B _____ Set o.k. JM/GH 6.6
6/10	3	0741	Manual A 55 B _____ SP=1 Counter A 54 B _____ check o.k. JM/GH 6.6
6/11	4	1208	Manual A 53 B _____ SP=3 Counter A 50 B _____ check o.k. JM/GH 6.5
6/12	5	1130	Manual A 57 B _____ Counter A 57 B _____ check o.k. JM/GH 6.6
6/13	6	0712	Manual A _____ B _____ Counter A _____ B _____ P/O o.k. JM/GH 6.6

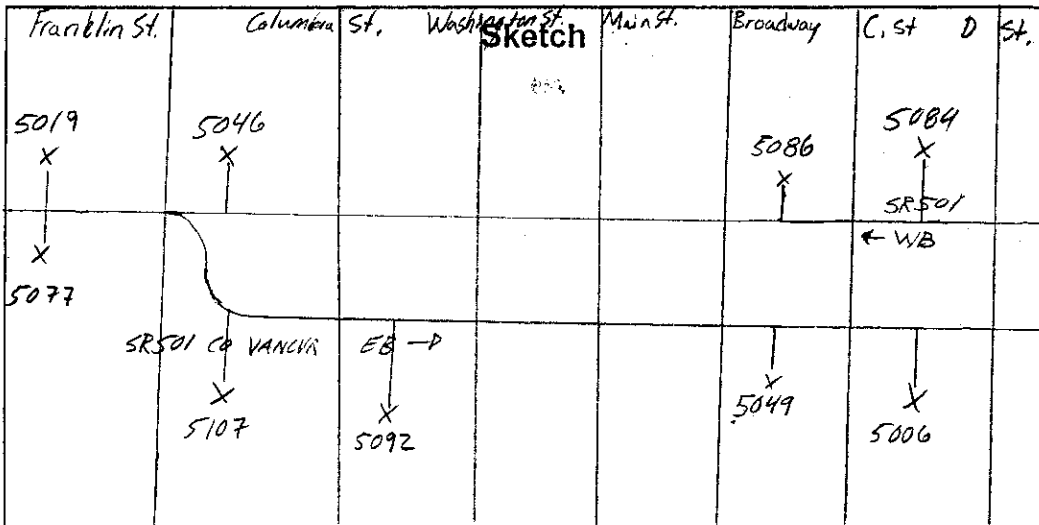

J. Mills / G. Heathscott
Field Person

SR 501 COVANCVR MP 001.00 OFF SYSTEM ID. LEG 2 DIRECTION OF TRAFFIC EASTBOUND LANE ALL OF
 COUNT IDENTIFIER HPMS COUNTER NUMBER 005006 DESCRIPTION: ON SR 501 COUPLET (COVANCVR) E/O C ST

COUNT	06/09/03 MONDAY												DAILY TOTAL																											
	1	2	3	4	5	6	7	8	9	10	11	12																												
00-15	12	1	2	3	4	5	6	7	8	9	10	11	12	309	307	334	355	504	238	130	87	85	64	50																
15-30	1	2	3	4	5	6	7	8	9	10	11	12	289	311	277	344	501	173	117	107	61	51	42	42																
30-45													272	306	310	411	379	180	92	102	58	58	34																	
45-00													270	279	294	373	377	246	145	89	81	83	42	27																
HOUR													270	1149	1218	1294	1487	1630	736	428	377	287	215	153	9244															
TOT													0													1793													0	9244

COUNT	06/10/03 TUESDAY												DAILY TOTAL																										
	1	2	3	4	5	6	7	8	9	10	11	12																											
00-15	12	1	2	3	4	5	6	7	8	9	10	11	12	231	218	234	272	366	282	290	297	363	505	244	136	101	94	64	45										
15-30	21	11	20	15	9	28	205	159	192	209	264	276	321	297	264	337	345	496	219	131	89	131	184	184	93	119	88	73	47										
30-45	22	14	24	15	25	57	204	204	217	238	257	296	271	300	291	327	375	384	184	103	103	301	123	103	100	74	70	39											
45-00	20	21	22	12	22	68	171	246	211	232	242	291	298	292	319	310	385	301	123	103	100	301	123	103	100	96	49	33											
HOUR	92	75	91	47	68	205	409	814	851	897	997	1135	1256	1171	1164	1271	1468	1686	770	463	409	352	256	164	16111														
TOT													1135													1770													5681

COUNT	06/11/03 WEDNESDAY												DAILY TOTAL																										
	1	2	3	4	5	6	7	8	9	10	11	12																											
00-15	12	1	2	3	4	5	6	7	8	9	10	11	12	185	219	245	283	360	322	301	305	348	530	268	157	115	104	85	51										
15-30	33	18	18	8	11	39	73	141	143	226	242	290	316	307	303	310	346	500	191	129	98	102	77	63	98	102	77	63											
30-45	15	19	23	18	22	58	110	239	164	241	265	283	315	274	324	335	354	345	153	110	104	85	65	44	104	104	85	65	44										
45-00	23	12	20	7	23	55	166	219	181	218	228	338	282	295	308	323	356	299	167	91	111	91	44	49	111	111	91	44	49										
HOUR	125	69	77	45	68	206	425	791	673	904	980	1194	1273	1198	1236	1273	1404	1674	779	487	428	382	271	207	16169														
TOT													1194													1740													5557

AM PEAK HOUR 1100 TO 1200 VOLUME 1194
 PM PEAK HOUR 0430 TO 0530 VOLUME 1740

AM PEAK HOUR 1100 TO 1200 VOLUME 1135
 PM PEAK HOUR 0445 TO 0545 VOLUME 1770

SR 501 COVANCVR MP 001.00 OFF SYSTEM ID. LEG 2 DIRECTION OF TRAFFIC EASTBOUND LANE ALL OF
 COUNT IDENTIFIER HPMS COUNTER NUMBER 005006 DESCRIPTION: ON SR 501 COUPLET (COVANCVR) E/O C ST

06/12/03 THURSDAY		AM HOURS												PM HOURS												DAILY TOTAL
COUNT	HPMS	1	2	3	4	5	6	7	8	9	10	11	12	1	2	3	4	5	6	7	8	9	10	11	12	TOT
122	123	86	53	101	204	386	798	742	884	946	1175	1380	1163	1236	1316	1569	1705	831	522	378	346	267	171	16504		
AM PEAK HOUR 1100 TO 1200 VOLUME 1175														PM PEAK HOUR 0430 TO 0530 VOLUME 1835												AM TOTAL 5620
PM PEAK HOUR 0600 TO 0700 VOLUME 382														PM PEAK HOUR 0000 TO 0000 VOLUME 0												PM TOTAL 10884

06/13/03 FRIDAY		AM HOURS												PM HOURS												DAILY TOTAL
COUNT	HPMS	1	2	3	4	5	6	7	8	9	10	11	12	1	2	3	4	5	6	7	8	9	10	11	12	TOT
100	109	84	51	83	210	382																			1019	
AM PEAK HOUR 0600 TO 0700 VOLUME 382														PM PEAK HOUR 0000 TO 0000 VOLUME 0												AM TOTAL 1019
PM PEAK HOUR 0000 TO 0000 VOLUME 0														PM PEAK HOUR 0000 TO 0000 VOLUME 0												PM TOTAL 0

06/09/03 THRU 06/13/03
 TOTAL HOURS FOR COUNT 90

3 DAYS
 AVG WEEKDAY VOL 16261 X SEASONAL ADJ. FACTOR 0.9000 = 14635 X AXLE CORR FACTOR 0.9455 = ESTIMATED AVG DAILY TRAFFIC 13837
 PEAK HOUR PERCENTAGES: K = 11.28 D = 100.00
 PEAK HOUR LOCATION : VOLUME = 1835 DATE: 06/12/03 TIME: 04:30 PM

FACTOR GROUP GR-02
 FACTOR GROUP GR-A2