



Washington State  
Department of Transportation

ONE DAY

Diamond Traffic Counter

Ru

Interval  60 min.  15 min.  
 Binned(CL/SP)  Count(volume)  
Lane No  1  2

Direction Channel 1 \_\_\_\_\_  
Direction Channel 2 \_\_\_\_\_  
Unique ID# \_\_\_\_\_

Counter No. 288686 Count ID 19-001  
SR 5 RRT/RRQ P5 00039 MP 0.47  
Leg 2 Direction NB OSID \_\_\_\_\_

Station Description ON SR 5 NB off ramp to 7th st

Date	Day	Time	Comments			
7/8/19	2	11:41	Manual (1) <u>3</u> (2) _____ Counter (1) <u>3</u> (2) _____	Set up ok	JDM/TPS	6.4v
7/9/19	3	10:33	Manual (1) <u>29</u> (2) _____ Counter (1) <u>29</u> (2) _____	Check ok	JDM/TSP	6.6v
7/10/19	4	11:20	Manual (1) <u>29</u> (2) _____ Counter (1) <u>29</u> (2) _____	Check ok nail up fixed @ 11:20	JDM/TSP	6.6v
7/11/19	5	08:09	Manual (1) <u>23</u> (2) _____ Counter (1) <u>23</u> (2) _____	Check ok	JDM/TSP	6.6v
7/12/19	6	06:42	Manual (1) _____ (2) _____ Counter (1) _____ (2) _____	P/U ok	JDM/TSP	6.5v

Sketch

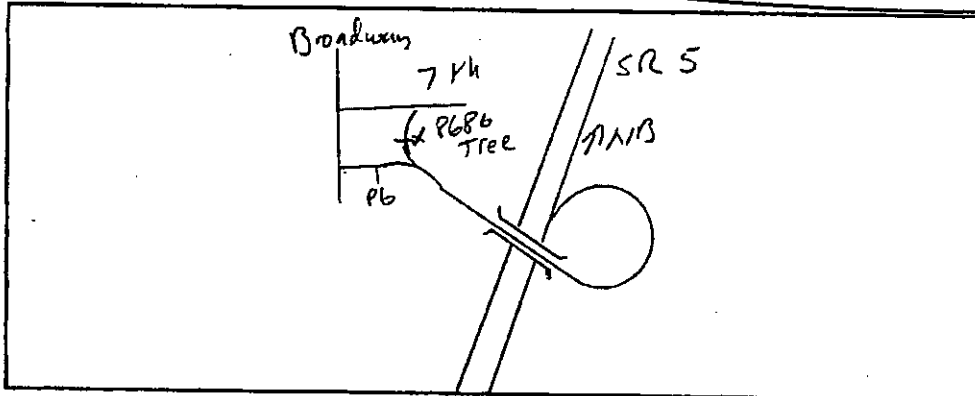

J. Mylar  
Field Person

STATE OF WASHINGTON - DEPARTMENT OF TRANSPORTATION  
TRIP SYSTEM  
15 MINUTE TRAFFIC COUNT SUMMARY

SR 005 P500039 MP 000.47 OFF SYSTEM ID. LEG 2 DIRECTION OF TRAFFIC NORTHBOUND LANE ALL OF

COUNT IDENTIFIER 19-001 COUNTER NUMBER 288686 DESCRIPTION: ON SR 5 NB OFF RAMP TO 7TH ST

07/08/19 MONDAY												PM HOURS												DAILY TOTAL
AM HOURS																								
12	1	2	3	4	5	6	7	8	9	10	11	12	1	2	3	4	5	6	7	8	9	10	11	
1	2	3	4	5	6	7	8	9	10	11	12	1	2	3	4	5	6	7	8	9	10	11	12	
00-15											67	70	84	64	53	60	43	35	32	18		1	<i>COUNT LOW</i>	
15-30											90	82	68	62	60	59	32	34	30	18	2	3		
30-45											74	86	95	67	59	64	40	36	21	2	1	3		
45-00											87	104	83	76	84	75	62	39	37	18	2	1		
HOUR	-----																							
TOT											87	335	321	323	277	247	245	154	142	101	38	5	8	2283

AM PEAK HOUR 0000 TO 0000 VOLUME 0 AM TOTAL 87  
PM PEAK HOUR 1245 TO 0145 VOLUME 342 PM TOTAL 2196

07/09/19 TUESDAY												PM HOURS												DAILY TOTAL
AM HOURS																								
12	1	2	3	4	5	6	7	8	9	10	11	12	1	2	3	4	5	6	7	8	9	10	11	
1	2	3	4	5	6	7	8	9	10	11	12	1	2	3	4	5	6	7	8	9	10	11	12	
00-15	1	2		7	4	11	50	90	146	89	81	81	76	81	76	83	72	76	43	41				
15-30		1		4	4	12	56	158	141	93	77	83	81	100	68	73	80	70	49	34				
30-45	2	1	1	1	6	32	63	140	132	97	91	84	87	79	82	73	70	70	38	40				
45-00	1	6		1	4	55	108	184	132	102	96	105	85	101	65	73	71	64	46	18				
HOUR	-----																							
TOT	4	10	1	13	18	110	277	572	551	381	345	353	329	361	291	302	293	280	176	133				4800

AM PEAK HOUR 0715 TO 0815 VOLUME 628 AM TOTAL 2635  
PM PEAK HOUR 0100 TO 0200 VOLUME 361 PM TOTAL 2165

07/10/19 WEDNESDAY												PM HOURS												DAILY TOTAL
AM HOURS																								
12	1	2	3	4	5	6	7	8	9	10	11	12	1	2	3	4	5	6	7	8	9	10	11	
1	2	3	4	5	6	7	8	9	10	11	12	1	2	3	4	5	6	7	8	9	10	11	12	
00-15												88	104	80	46	67	70	69	38	46	19	14	8	
15-30											44	88	71	68	73	75	63	58	38	27	17	11	7	
30-45											78	84	89	79	79	64	62	59	33	24	16	17	13	
45-00											88	118	91	75	81	80	61	59	29	29	12	11	7	
HOUR	-----																							
TOT											210	378	355	302	279	286	256	245	138	126	64	53	35	2727

*TUBE UP* AM PEAK HOUR 1100 TO 1200 VOLUME 210 AM TOTAL 210  
PM PEAK HOUR 1215 TO 0115 VOLUME 394 PM TOTAL 2517

STATE OF WASHINGTON - DEPARTMENT OF TRANSPORTATION  
 TRIPS SYSTEM  
 15 MINUTE TRAFFIC COUNT SUMMARY

SR 005 P500039 MP 000.47 OFF SYSTEM ID. LEG 2 DIRECTION OF TRAFFIC NORTHBOUND LANE ALL OF

COUNT IDENTIFIER 19-001 COUNTER NUMBER 288686 DESCRIPTION: ON SR 5 NB OFF RAMP TO 7TH ST

07/11/19 THURSDAY													PM HOURS												DAILY TOTAL
AM HOURS																									
12	1	2	3	4	5	6	7	8	9	10	11	12	1	2	3	4	5	6	7	8	9	10	11	12	
8	7	3	2	6	31	94	121	105	82	88	74	83	72	67	49	79	58	41	38	21	4	10	TUBE UP		
11	6	3	6	4	12	57	141	136	103	87	81	87	88	79	60	91	76	47	37	39	8	4		7	
5	1	1	1	4	30	69	132	99	66	78	83	94	84	68	74	67	63	50	48	28	7	4		4	
45-00	6	3	4	6	53	126	177	156	108	96	102	97	117	65	71	90	71	44	23	36	1	1		4	
TOT	30	17	4	14	16	101	283	544	512	382	343	354	352	372	284	272	297	289	199	149	141	37		9	21

AM PEAK HOUR 0715 TO 0815 VOLUME 571 AM TOTAL 2600  
 PM PEAK HOUR 0100 TO 0200 VOLUME 372 PM TOTAL 2422

07/12/19 FRIDAY													PM HOURS												DAILY TOTAL
AM HOURS																									
12	1	2	3	4	5	6	7	8	9	10	11	12	1	2	3	4	5	6	7	8	9	10	11	12	
1	2	3	4	5	6	7	8	9	10	11	12	1	2	3	4	5	6	7	8	9	10	11	12	TUBE UP	
00-15																									
15-30																									
30-45																									
45-00																									
TOT																									

AM PEAK HOUR 0000 TO 0000 VOLUME 0 AM TOTAL 0  
 PM PEAK HOUR 0000 TO 0000 VOLUME 0 PM TOTAL 0

07/08/19 THRU 07/12/19  
 TOTAL HOURS FOR COUNT 75

1 DAYS 5117 FACTOR GROUP P5S 4861 FACTOR GROUP P5S 4420  
 AVG WEEKDAY VOL 5022 X SEASONAL ADJ. FACTOR 0.9500 = 4771 X AXLE CORR FACTOR 0.9092 = ESTIMATED AVG DAILY TRAFFIC 4338

PEAK HOUR PERCENTAGES: K = 12.50 D = 100.00  
 PEAK HOUR LOCATION : VOLUME = 628 DATE: 07/09/19 TIME: 07:15 AM

NOTE: ONE DAY

*RU*

Interval  60 min.  15 min.  
 Binned(CL/SP)  Count(volume)  
Lane No  1  2

---

Direction Channel 1 \_\_\_\_\_  
Direction Channel 2 \_\_\_\_\_  
Unique ID# \_\_\_\_\_

Counter No. 282304 Count ID 19-001  
SR 5 RRT/RRQ P7 00039 MP 0.00  
Leg 2 Direction NB OSID \_\_\_\_\_

Station Description ON SR 5 NB off ramp to 7th st/Broadway st

Date	Day	Time	Comments			
7/8/19	2	11:29	Manual (1) 10 (2) _____ Counter (1) 10 (2)	Set up ok	JDM/TPS	6.4v
7/9/19	3	10:27	Manual (1) 25 (2) _____ Counter (1) 25 (2)	Check ok	JDM/TSP	7.1v
7/10/19	4	11:25	Manual (1) 28 (2) _____ Counter (1) 28 (2)	Check ok	JDM/TSP	6.9v
7/11/19	5	08:00	Manual (1) 50 (2) _____ Counter (1) 50 (2)	Check ok	JDM/TSP	6.7v
7/12/19	6	06:37	Manual (1) 1 (2) _____ Counter (1) 1 (2)	P/U ok	JDM/TSP	6.5v

Sketch

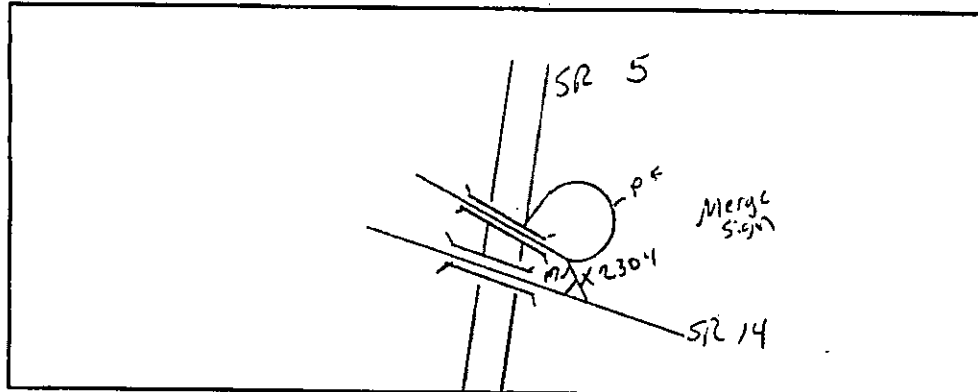

*J. Myler*  
Field Person

STATE OF WASHINGTON - DEPARTMENT OF TRANSPORTATION  
TRIP SYSTEM  
15 MINUTE TRAFFIC COUNT SUMMARY

SR 005 P700039 MP 000.00 OFF SYSTEM ID. LEG 2 DIRECTION OF TRAFFIC NORTHBOUND LANE ALL OF  
COUNT IDENTIFIER 19-001 COUNTER NUMBER 282304 DESCRIPTION: ON SR 5 NB OFF RAMP TO 7TH ST/BROADWAY ST

07/08/19 MONDAY												PM HOURS												DAILY TOTAL
AM HOURS																								
12	1	2	3	4	5	6	7	8	9	10	11	12	1	2	3	4	5	6	7	8	9	10	11	
1	2	3	4	5	6	7	8	9	10	11	12	1	2	3	4	5	6	7	8	9	10	11	12	5
00-15											83	95	108	81	76	90	59	40	27	21	2	5	<i>COUNT LOW</i>	
15-30											97	96	84	86	78	85	59	50	33	12	2			
30-45										62	106	98	100	94	79	69	63	42	30			5		
45-00										109	129	104	86	94	103	93	61	36	34	14				
HOUR	-----																							
TOT											171	415	393	378	355	336	337	242	168	124	47	4	10	2980

AM PEAK HOUR 0000 TO 0000 VOLUME 0 AM TOTAL 171  
PM PEAK HOUR 1215 TO 0115 VOLUME 427 PM TOTAL 2809

07/09/19 TUESDAY												PM HOURS												DAILY TOTAL	
AM HOURS																									
12	1	2	3	4	5	6	7	8	9	10	11	12	1	2	3	4	5	6	7	8	9	10	11		
1	2	3	4	5	6	7	8	9	10	11	12	1	2	3	4	5	6	7	8	9	10	11	12		
00-15	4	3	4		4	14	105	140	174	95	99	99	88	103	100	107	92	97	56	39	32	24	11	11	
15-30		3	5		6	71	123	180	192	107	84	98	101	105	77	93	109	103	64	43	28	18	13	10	
30-45					8	117	108	202	142	110	94	104	96	107	97	80	89	113	52	42	34	19	11	11	
45-00				3	9	127	169	260	148	129	108	98	110	120	84	96	110	99	63	43	30	21	5	9	
HOUR	-----																								
TOT	4	6	9	3	27	329	505	782	656	441	385	399	395	435	358	376	400	412	235	167	124	82	40	41	6611

*COUNT LOW*

AM PEAK HOUR 0730 TO 0830 VOLUME 828 AM TOTAL 3546  
PM PEAK HOUR 0100 TO 0200 VOLUME 435 PM TOTAL 3065

07/10/19 WEDNESDAY												PM HOURS												DAILY TOTAL	
AM HOURS																									
12	1	2	3	4	5	6	7	8	9	10	11	12	1	2	3	4	5	6	7	8	9	10	11		
1	2	3	4	5	6	7	8	9	10	11	12	1	2	3	4	5	6	7	8	9	10	11	12		
00-15	14		3	6	4	24	95	117	190	94	90	128	115	119	88	75	76	92	84	63	40	27	21	9	
15-30	4	4	3	1	2	67	112	182	165	112	92	127	114	91	69	105	110	94	89	44	38	16	9	4	
30-45	4	4	2	6	13	105	128	219	159	137	124	114	113	103	101	79	88	83	63	31	29	26	10	10	
45-00	7	4	3	6	9	106	182	271	150	109	147	138	124	101	121	94	117	96	70	44	29	14	16	6	
HOUR	-----																								
TOT	29	12	11	19	28	302	517	789	664	452	453	507	466	414	379	353	391	365	306	182	136	83	56	29	6943

AM PEAK HOUR 0715 TO 0815 VOLUME 862 AM TOTAL 3783  
PM PEAK HOUR 1215 TO 0115 VOLUME 470 PM TOTAL 3160

STATE OF WASHINGTON - DEPARTMENT OF TRANSPORTATION  
TRIPS SYSTEM  
15 MINUTE TRAFFIC COUNT SUMMARY

SR 005 P700039 MP 000.00 OFF SYSTEM ID. LEG 2 DIRECTION OF TRAFFIC NORTHBOUND LANE ALL OF  
COUNT IDENTIFIER 19-001 COUNTER NUMBER 282304 DESCRIPTION: ON SR 5 NB OFF RAMP TO 7TH ST/BROADWAY ST

07/11/19 THURSDAY	AM HOURS												PM HOURS												DAILY TOTAL		
	12	1	2	3	4	5	6	7	8	9	10	11	12	1	2	3	4	5	6	7	8	9	10	11		12	
00-15	10	3	1	3	3	11	92	119	162	120	87	107	108	108	100	98	91	140	97	66	41	19	1	3	<i>COUNT LOW</i>		
15-30	10	5	3	7	6	54	123	191	134	112	88	150	103	114	102	105	115	122	101	45	45	1					
30-45	9	3	2	4	8	108	111	197	98	130	99	142	114	122	84	119	108	123	100	53	30	20	2				
45-00	6	1	1	6	10	101	164	265	195	134	145	146	123	143	94	107	140	160	72	41	39	3	2				
TOT	35	12	7	20	27	274	490	772	589	496	419	545	448	487	380	429	454	545	370	205	155	40	6	5		7210	
AM PEAK HOUR 0715 TO 0815 VOLUME																815	AM TOTAL										3686
PM PEAK HOUR 0500 TO 0600 VOLUME																545	PM TOTAL										3524

07/12/19 FRIDAY	AM HOURS												PM HOURS												DAILY TOTAL												
	12	1	2	3	4	5	6	7	8	9	10	11	12	1	2	3	4	5	6	7	8	9	10	11		12											
00-15	2	4		3	2	8	71																														
15-30	5			1		20	104																														
30-45					1	63																															
45-00	1	3	2	4	6	93																															
TOT	8	7	2	8	9	184	175																		393												
<i>COUNT LOW</i>																AM PEAK HOUR 0530 TO 0630 VOLUME										331	AM TOTAL										393
																PM PEAK HOUR 0000 TO 0000 VOLUME										0	PM TOTAL										0

07/08/19 THRU 07/12/19  
TOTAL HOURS FOR COUNT 90

*2* DAYS *6847* FACTOR GROUP P5S *6505* FACTOR GROUP P5S *5914*  
AVG WEEKDAY VOL 6921 X SEASONAL ADJ. FACTOR 0.9500 = 6575 X AXLE CORR FACTOR 0.9092 = ESTIMATED AVG DAILY TRAFFIC 5978  
PEAK HOUR PERCENTAGES: K = *12.59* D = 100.00  
PEAK HOUR LOCATION : VOLUME = 862 DATE: 07/10/19 TIME: 07:15 AM

ONE DAY

Diamond Traffic Counter

REDUNDANT

Ru

Interval  60 min.  15 min.  
 Binned(CL/SP)  Count(volume)  
Lane No  1  2

10F2

Direction Channel 1 \_\_\_\_\_  
Direction Channel 2 \_\_\_\_\_  
Unique ID# \_\_\_\_\_

Counter No. 288695 Count ID ~~19-004~~ 19-002  
P5  
SR 5 RRT/RRQ P5 00039 MP 0.30  
~~0.00~~  
Leg 2 Direction NB OSID \_\_\_\_\_

Station Description \_ ON SR 5 NB off ramp to Broadway St / 7TH ST.

Date	Day	Time	Comments
7/8/19	2	11:49	Manual (1) <u>5</u> (2) _____ Set up ok JDM/TPS 6.4v Counter (1) <u>5</u> (2) _____
7/9/19	3	10:35	Manual (1) <u>35</u> (2) _____ Check ok JDM/TSP 6.4v Counter (1) <u>35</u> (2) _____
7/10/19	4	11:21	Manual (1) <u>25</u> (2) _____ Check ok JDM/TSP 6.4v Counter (1) <u>25</u> (2) _____ water in tube replaced @ 11:21
7/11/19	5	08:10	Manual (1) <u>30</u> (2) _____ Check ok JDM/TSP 6.4v Counter (1) <u>30</u> (2) _____
7/12/19	6	06:45	Manual (1) <u>1</u> (2) _____ P/U ok JDM/TSP 6.5v Counter (1) <u>1</u> (2) _____

Sketch

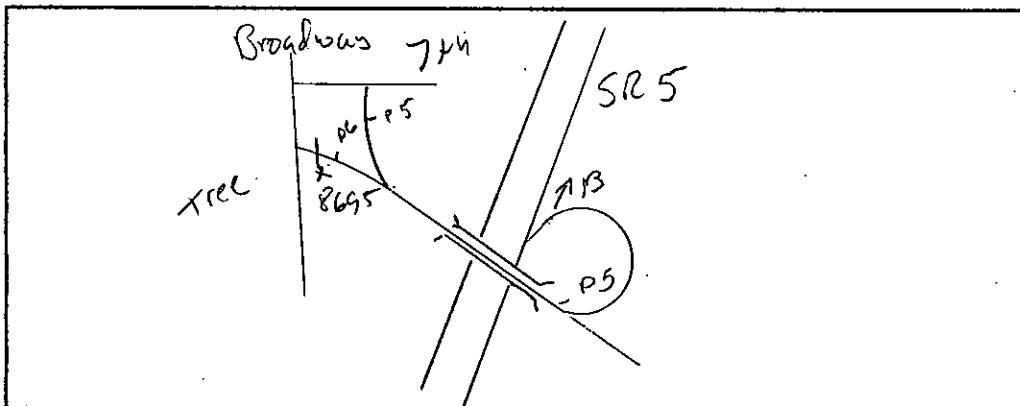

J. Mydler  
Field Person

Interval  60 min.  15 min.  
 Binned(CL/SP)  Count(volume)  
Lane No  1  2

*2 of 2*

Direction Channel 1 \_\_\_\_\_  
Direction Channel 2 \_\_\_\_\_  
Unique ID# \_\_\_\_\_

Counter No. 288686 Count ID ~~19-001~~ 19-002  
SR 5 RRT/RRQ P5 00039 MP ~~0.47~~ 0.30  
Leg 2 Direction NB OSID \_\_\_\_\_

Station Description ON SR 5 NB off ramp to 7th st / BROADWAY ST

Date	Day	Time	Comments
7/8/19	2	11:41	Manual (1) <u>3</u> (2) _____ Set up ok JDM/TPS 6.4v Counter (1) <u>3</u> (2) _____
7/9/19	3	10:33	Manual (1) <u>29</u> (2) _____ Check ok JDM/TSP 6.6v Counter (1) <u>29</u> (2) _____
7/10/19	4	11:20	Manual (1) <u>29</u> (2) _____ Check ok JDM/TSP 6.6v Counter (1) <u>29</u> (2) _____ <i>nail up fixed @ 11:20</i>
7/11/19	5	08:09	Manual (1) <u>23</u> (2) _____ Check ok JDM/TSP 6.6v Counter (1) <u>23</u> (2) _____
7/12/19	6	06:42	Manual (1) _____ (2) _____ P/U ok JDM/TSP 6.5v Counter (1) _____ (2) _____ <i>Tube up from grinding</i>

Sketch

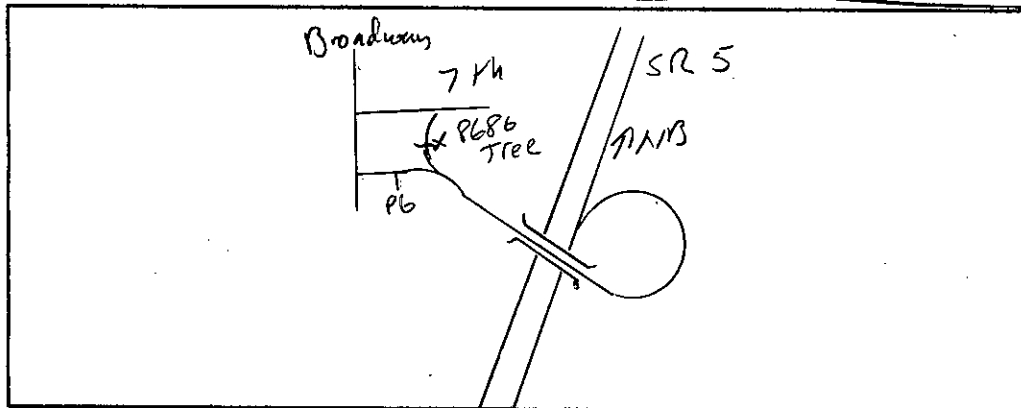

*J. Mylar*  
Field Person





STATE OF WASHINGTON - DEPARTMENT OF TRANSPORTATION  
TRIP SYSTEM  
15 MINUTE TRAFFIC COUNT SUMMARY

SR 005 P500039 MP 000.30 OFF SYSTEM ID. LEG 2 DIRECTION OF TRAFFIC NORTHBOUND LANE 1 OF 2  
COUNT IDENTIFIER 19-002 COUNJER NUMBER 288695 DESCRIPTION: ON SR 5 NB OFF RAMP TO BROADWAY ST/7TH ST

07/11/19 THURSDAY		AM HOURS											PM HOURS															
	12	1	2	3	4	5	6	7	8	9	10	11	12	1	2	3	4	5	6	7	8	9	10	11	12	DAILY	TOTAL	
00-15	10	4	2	5	3	14	79	68	126	80	82	83	96	105	74	79	74	109	93	70	45	34						
15-30	5	6	7	3	3	54	95	109	93	66	59	124	90	108	77	86	79	99	93	52	38	14	1					
30-45	9	5	7	5	6	100	75	138	92	69	67	118	94	99	60	77	87	107	90	64	46			1				
45-00	9	8	2	3	12	82	111	157	108	96	103	116	87	102	70	74	94	131	68	52	42	1						
HOUR	-----																											
TOT	33	23	18	16	24	250	360	472	419	311	311	441	367	414	281	316	334	446	344	238	171	49	1	1	5640			

COUNT LOW

AM PEAK HOUR 0715 TO 0815 VOLUME 530  
PM PEAK HOUR 0500 TO 0600 VOLUME 446

AM TOTAL 2678  
PM TOTAL 2962

07/12/19 FRIDAY		AM HOURS											PM HOURS															
	12	1	2	3	4	5	6	7	8	9	10	11	12	1	2	3	4	5	6	7	8	9	10	11	12	DAILY	TOTAL	
00-15						8	56																					
15-30						29	92																					
30-45						62																						
45-00					4	88																						
HOUR	-----																											
TOT					4	187	148																					339

COUNT LOW

AM PEAK HOUR 0530 TO 0630 VOLUME 298  
PM PEAK HOUR 0000 TO 0000 VOLUME 0

AM TOTAL 339  
PM TOTAL 0

STATE OF WASHINGTON - DEPARTMENT OF TRANSPORTATION  
T R I P S   S Y S T E M  
15 MINUTE TRAFFIC COUNT SUMMARY

SR 005 P500039 MP 000.30      OFF SYSTEM ID.      LEG 2      DIRECTION OF TRAFFIC NORTHBOUND      LANE 2      OF 2  
COUNT IDENTIFIER 19-002      COUNTER NUMBER 288686 \*      DESCRIPTION: ON SR 5 NB OFF RAMP TO BROADWAY ST/7TH ST

07/08/19 MONDAY												PM HOURS												DAILY TOTAL	
AM HOURS																									
12	1	2	3	4	5	6	7	8	9	10	11	12	1	2	3	4	5	6	7	8	9	10	11	12	
1	2	3	4	5	6	7	8	9	10	11	12	1	2	3	4	5	6	7	8	9	10	11	12		
												67	70	84	64	53	60	43	35	32	18		1	<i>CNT LOW</i>	
												90	82	68	62	60	59	32	34	30	18	2	3		
													74	86	95	67	59	64	40	36	21	2	1		3
												87	104	83	76	84	75	62	39	37	18	2	1		
HOUR												-----													
TOT												87	335	321	323	277	247	245	154	142	101	38	5	8	2283

AM PEAK HOUR 0000 TO 0000 VOLUME 0      AM TOTAL 87  
PM PEAK HOUR 1245 TO 0145 VOLUME 342      PM TOTAL 2196

07/09/19 TUESDAY												PM HOURS												DAILY TOTAL										
AM HOURS																																		
12	1	2	3	4	5	6	7	8	9	10	11	12	1	2	3	4	5	6	7	8	9	10	11	12										
1	2	3	4	5	6	7	8	9	10	11	12	1	2	3	4	5	6	7	8	9	10	11	12											
1	2		7	4	11	50	90	146	89	81	81	76	81	76	83	72	76	43	41					<i>TUBE UP</i>										
15-30		1	4	4	12	56	158	141	93	77	83	81	100	68	73	80	70	49	34															
30-45	2	1	1	1	6	32	63	140	132	97	91	84	87	79	82	73	70	70	38	40														
45-00	1	6		1	4	55	108	184	132	102	96	105	85	101	65	73	71	64	46	18														
HOUR												-----																						
TOT												4	10	1	13	18	110	277	572	551	381	345	353	329	361	291	302	293	280	176	133			4800

AM PEAK HOUR 0715 TO 0815 VOLUME 628      AM TOTAL 2635  
PM PEAK HOUR 0100 TO 0200 VOLUME 361      PM TOTAL 2165

07/10/19 WEDNESDAY												PM HOURS												DAILY TOTAL	
AM HOURS																									
12	1	2	3	4	5	6	7	8	9	10	11	12	1	2	3	4	5	6	7	8	9	10	11	12	
1	2	3	4	5	6	7	8	9	10	11	12	1	2	3	4	5	6	7	8	9	10	11	12		
												88	104	80	46	67	70	69	38	46	19	14	8	<i>TUBE UP</i>	
												44	88	71	68	73	75	63	58	38	27	17	11		7
												78	84	89	79	79	64	62	59	33	24	16	17		13
												88	118	91	75	81	80	61	59	29	29	12	11		7
HOUR												-----													
TOT												210	378	355	302	279	286	256	245	138	126	64	53	35	2727

AM PEAK HOUR 1100 TO 1200 VOLUME 210      AM TOTAL 210  
PM PEAK HOUR 1215 TO 0115 VOLUME 394      PM TOTAL 2517

STATE OF WASHINGTON - DEPARTMENT OF TRANSPORTATION  
TRIP SYSTEM  
15 MINUTE TRAFFIC COUNT SUMMARY

SR 005 P500039 MP 000.30 OFF SYSTEM ID. LEG 2 DIRECTION OF TRAFFIC NORTHBOUND LANE 2 OF 2

COUNT IDENTIFIER 19-002 COUNTER NUMBER 288686 \* DESCRIPTION: ON SR 5 NB OFF RAMP TO BROADWAY ST/7TH ST

07/11/19 THURSDAY													PM HOURS												DAILY TOTAL
AM HOURS																									
12	1	2	3	4	5	6	7	8	9	10	11	12	1	2	3	4	5	6	7	8	9	10	11	12	
00-15	8	7	3	2	6	31	94	121	105	82	88	74	83	72	67	49	79	58	41	38	21	4	10		
15-30	11	6	3	6	4	12	57	141	136	103	87	81	87	88	79	60	91	76	47	37	39	8	4	7	
30-45	5	1	1	1	4	30	69	132	99	66	78	83	94	84	68	74	67	63	50	48	28	7	4	4	
45-00	6	3	4	6	53	126	177	156	108	96	102	97	117	65	71	90	71	44	23	36	1	1	1	1	
TOT	30	17	4	14	16	101	283	544	512	382	343	354	352	372	284	272	297	289	199	149	141	37	9	21	5022

TUBE UP

AM PEAK HOUR 0715 TO 0815 VOLUME 571  
PM PEAK HOUR 0100 TO 0200 VOLUME 372

AM TOTAL 2600  
PM TOTAL 2422

07/12/19 FRIDAY													PM HOURS												DAILY TOTAL
AM HOURS																									
12	1	2	3	4	5	6	7	8	9	10	11	12	1	2	3	4	5	6	7	8	9	10	11	12	
00-15																									
15-30																									
30-45																									
45-00																									
TOT																									

TUBE UP

AM PEAK HOUR 0000 TO 0000 VOLUME 0  
PM PEAK HOUR 0000 TO 0000 VOLUME 0

AM TOTAL 0  
PM TOTAL 0

STATE OF WASHINGTON - DEPARTMENT OF TRANSPORTATION  
TRIP SYSTEM  
15 MINUTE TRAFFIC COUNT SUMMARY

SR 005 P500039 MP 000.30 OFF SYSTEM ID. LEG 2 DIRECTION OF TRAFFIC NORTHBOUND LANE 12 OF 2  
COUNT IDENTIFIER 19-002 COUNTER NUMBER: 288686 \* DESCRIPTION: ON SR 5 NB OFF RAMP TO BROADWAY ST/7TH ST

07/08/19 MONDAY												PM HOURS												DAILY TOTAL
AM HOURS																								
12	1	2	3	4	5	6	7	8	9	10	11	12	1	2	3	4	5	6	7	8	9	10	11	12
1	2	3	4	5	6	7	8	9	10	11	12	1	2	3	4	5	6	7	8	9	10	11	12	
00-15												142	152	162	135	111	121	88	76	54	37		1	<i>COUNT LOW</i>
15-30												163	160	131	124	119	119	76	80	65	33	3	5	
30-45												161	163	157	134	109	108	97	78	50	5	1	3	
45-00												211	166	131	133	153	129	93	77	51		2	1	
HOUR	-----																							
TOT												677	641	581	526	492	477	354	311	220	75	6	10	4370

AM PEAK HOUR 0000 TO 0000 VOLUME 0 AM TOTAL 0  
PM PEAK HOUR 1215 TO 0115 VOLUME 687 PM TOTAL 4370

07/09/19 TUESDAY												PM HOURS												DAILY TOTAL	
AM HOURS																									
12	1	2	3	4	5	6	7	8	9	10	11	12	1	2	3	4	5	6	7	8	9	10	11	12	
1	2	3	4	5	6	7	8	9	10	11	12	1	2	3	4	5	6	7	8	9	10	11	12		
00-15	1	2		9	7	18	131	188	248	156	148	149	159	170	154	150	133	141	43	41		2	1	1	<i>TUBE UP</i>
15-30		1		4	6	80	151	250	279	175	147	174	152	186	139	128	147	78	50	34	1	2			
30-45	2	1	1	2	14	144	134	277	218	169	174	153	173	168	143	110	130	73	38	42	1		1	1	
45-00	1	6		2	16	153	212	351	237	186	178	174	181	189	127	135	140	65	47	20	1		1	1	
HOUR	-----																								
TOT	4	10	1	17	43	395	628	1066	982	686	647	650	665	713	563	523	550	357	178	137	3	4	3	3	8828

*COUNT LOW*

AM PEAK HOUR 0730 TO 0830 VOLUME 1155 AM TOTAL 5129  
PM PEAK HOUR 0100 TO 0200 VOLUME 713 PM TOTAL 3699

07/10/19 WEDNESDAY												PM HOURS												DAILY TOTAL	
AM HOURS																									
12	1	2	3	4	5	6	7	8	9	10	11	12	1	2	3	4	5	6	7	8	9	10	11	12	
1	2	3	4	5	6	7	8	9	10	11	12	1	2	3	4	5	6	7	8	9	10	11	12		
00-15												1	186	197	140	118	117	133	141	94	85	53	33	15	<i>TUBE UP</i>
15-30												57	178	160	116	144	157	143	127	82	69	43	24	15	
30-45												177	171	179	152	134	119	116	110	69	59	39	27	24	
45-00												196	236	172	169	149	162	126	121	74	61	36	33	13	
HOUR	-----																								
TOT												431	771	708	577	545	555	518	499	319	274	171	117	67	5552

*TUBE UP*

AM PEAK HOUR 1100 TO 1200 VOLUME 431 AM TOTAL 431  
PM PEAK HOUR 1215 TO 0115 VOLUME 782 PM TOTAL 5121

STATE OF WASHINGTON - DEPARTMENT OF TRANSPORTATION  
TRIP SYSTEM  
15 MINUTE TRAFFIC COUNT SUMMARY

SR 005 P5000390 MP 000.30 OFF SYSTEM ID. LEG 2 DIRECTION OF TRAFFIC NORTHBOUND LANE 12 OF 2  
COUNT IDENTIFIER 19-002 COUNTER NUMBER 288686 \* DESCRIPTION: ON SR 5 NB OFF RAMP TO BROADWAY ST/7TH ST

	AM HOURS											PM HOURS											DAILY TOTAL		
	12	1	2	3	4	5	6	7	8	9	10	11	12	1	2	3	4	5	6	7	8	9		10	11
00-15	18	11	2	8	5	20	110	162	247	185	164	171	170	188	146	146	123	188	151	111	83	55	4	10	<i>COUNT LOW</i>
15-30	16	12	10	9	7	66	152	250	229	169	146	205	177	196	156	146	170	175	140	89	77	22	5	7	
30-45	14	6	8	6	10	130	144	270	191	135	145	201	188	183	128	151	154	170	140	112	74	7	1	5	
45-00	15	11	2	7	18	135	237	334	264	204	199	218	184	219	135	145	184	202	112	75	78	2	1	7	
TOT	63	40	22	30	40	351	643	1016	931	693	654	795	719	786	565	588	631	735	543	387	312	86	10	22	

AM PEAK HOUR 0715 TO 0815 VOLUME 1101  
PM PEAK HOUR 0100 TO 0200 VOLUME 786

AM TOTAL 5278  
PM TOTAL 5384

	AM HOURS											PM HOURS											DAILY TOTAL		
	12	1	2	3	4	5	6	7	8	9	10	11	12	1	2	3	4	5	6	7	8	9		10	11
00-15						8	56																		
15-30						29																			
30-45						62																			
45-00					4	88																			
TOT					4	187	56																		247

*COUNT LOW*

AM PEAK HOUR 0515 TO 0615 VOLUME 235  
PM PEAK HOUR 0000 TO 0000 VOLUME 0

AM TOTAL 247  
PM TOTAL 0

07/08/19 THRU 07/12/19  
TOTAL HOURS FOR COUNT 75

1 DAYS *10399* FACTOR GROUP P5S *9879* FACTOR GROUP P5S *8982*  
AVG WEEKDAY VOL 10662 X SEASONAL ADJ. FACTOR 0.9500 = 10129 X AXLE CORR FACTOR 0.9092 = ESTIMATED AVG DAILY TRAFFIC 9209

PEAK HOUR PERCENTAGES: K = *11.11* D = 100.00  
PEAK HOUR LOCATION: VOLUME = 1155 DATE: 07/09/19 TIME: 07:30 AM

*NOTE: ONE DAY*



Washington State  
Department of Transportation

# Diamond Traffic Counter

*RU*

Interval  60 min.  15 min.  
 Binned(CL/SP)  Count(volume)  
 Lane No  1  2

*10F2*

Direction Channel 1 \_\_\_\_\_  
 Direction Channel 2 \_\_\_\_\_  
 Unique ID# \_\_\_\_\_

Counter No. 281690 Count ID 19-001  
 SR 5 RRT/RRQ P5 00039 MP 0.30  
 Leg 2 Direction NB OSID \_\_\_\_\_

Station Description \_ ON SR 5 NB off ramp to 7th st/Broadway st

Date	Day	Time	Comments
7/8/19	2	11:33	Manual (1) <u>10</u> (2) _____ Counter (1) <u>10</u> (2) _____ Set up ok JDM/TPS 6.4v
7/9/19	3	10:27	Manual (1) <u>33</u> (2) _____ Counter (1) <u>33</u> (2) _____ Check ok JDM/TSP 7.2v Tube up fixed @ 10:27, ramp closed from 900 to 500 for repaving
7/10/19	4	11:15	Manual (1) <u>21</u> (2) _____ Counter (1) <u>21</u> (2) _____ Check ok JDM/TSP 7.0v
7/11/19	5	08:00	Manual (1) <u>32</u> (2) _____ Counter (1) <u>32</u> (2) _____ Check ok JDM/TSP 6.7v
7/12/19	6	06:37	Manual (1) <u>1</u> (2) _____ Counter (1) <u>1</u> (2) _____ P/U ok JDM/TSP 6.5v

Sketch

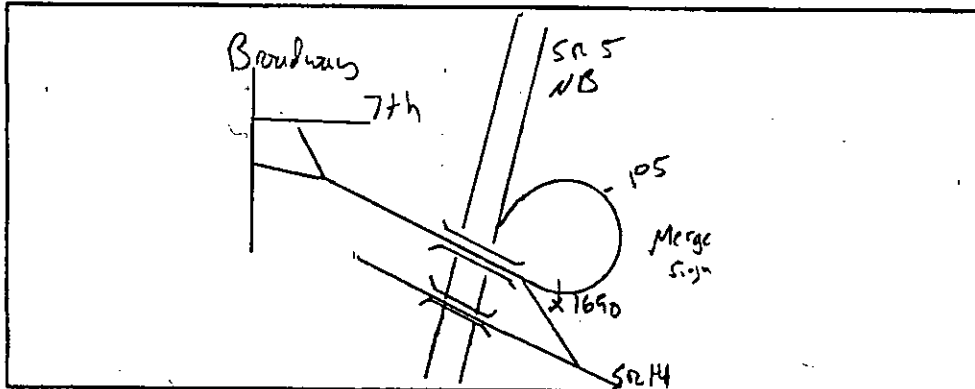

*J. Mydler*  
Field Person



Interval  60 min.  15 min.  
 Binned(CL/SP)  Count(volume)  
 Lane No  1  2

*1 OF 2*

Direction Channel 1 \_\_\_\_\_  
 Direction Channel 2 \_\_\_\_\_  
 Unique ID# \_\_\_\_\_

Counter No. 282304 Count ID 19-001  
 SR 5 RRT/RRQ P5 PT00039 MP 0.30  
 Leg 2 Direction NB OSID \_\_\_\_\_

Station Description ON SR 5 NB off ramp to 7th st/Broadway st

Date	Day	Time	Comments
7/8/19	2	11:29	Manual (1) 10 (2) _____ Set up ok JDM/TPS 6.4v Counter (1) 10 (2)
7/9/19	3	10:27	Manual (1) 25 (2) _____ Check ok JDM/TSP 7.1v Counter (1) 25 (2)
7/10/19	4	11:25	Manual (1) 28 (2) _____ Check ok JDM/TSP 6.9v Counter (1) 28 (2)
7/11/19	5	08:00	Manual (1) 50 (2) _____ Check ok JDM/TSP 6.7v Counter (1) 50 (2)
7/12/19	6	06:37	Manual (1) 1 (2) _____ P/U ok JDM/TSP 6.5v Counter (1) 1 (2)

Sketch

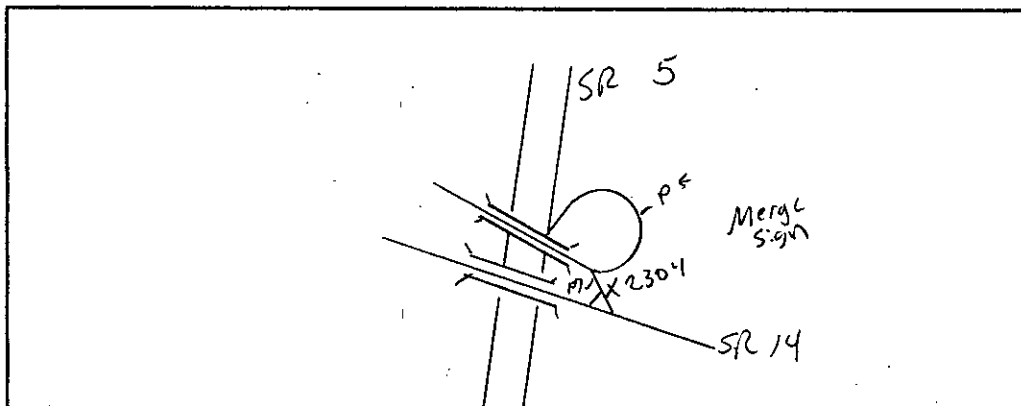

*J. Myler*  
Field Person



STATE OF WASHINGTON - DEPARTMENT OF TRANSPORTATION  
TRIPS SYSTEM  
15 MINUTE TRAFFIC COUNT SUMMARY

SR 005 P500039 MP 000.30 OFF SYSTEM ID. LEG 2 DIRECTION OF TRAFFIC NORTHBOUND LANE 1 OF 2

COUNT IDENTIFIER 19-001 COUNTER NUMBER 281690 DESCRIPTION: ON SR 5 NB OFF RAMP TO 7TH ST/BROADWAY ST

07/08/19 MONDAY												PM HOURS												DAILY TOTAL
AM HOURS																								
12	1	2	3	4	5	6	7	8	9	10	11	12	1	2	3	4	5	6	7	8	9	10	11	12
1	2	3	4	5	6	7	8	9	10	11	12	1	2	3	4	5	6	7	8	9	10	11	12	
00-15												52	56	51	57	38	34	24	35	27	16	6		
15-30												71	62	48	37	38	34	18	31	33	26	7		
30-45												59	70	59	45	33	39	35	38	21	5			
45-00												70	87	63	45	38	46	41	33	39	17			
HOUR																								
TOT												70	269	251	203	177	155	148	110	143	98	47	13	1684

TUBE UP

AM PEAK HOUR 0000 TO 0000 VOLUME 0  
PM PEAK HOUR 1245 TO 0145 VOLUME 275  
AM TOTAL 70  
PM TOTAL 1614

07/09/19 TUESDAY												PM HOURS												DAILY TOTAL		
AM HOURS																										
12	1	2	3	4	5	6	7	8	9	10	11	12	1	2	3	4	5	6	7	8	9	10	11	12		
1	2	3	4	5	6	7	8	9	10	11	12	1	2	3	4	5	6	7	8	9	10	11	12			
00-15												53	69	74	54	42	46	45	40	45	51	27	13	10		
15-30												22	69	58	75	55	37	35	50	34	23	37	20	15	15	
30-45												78	54	76	67	49	31	38	34	37	36	43	16	12	5	
45-00												75	77	71	65	43	38	33	50	33	31	26	16	10	6	
HOUR																										
TOT												175	253	274	281	201	148	152	179	144	135	157	79	50	36	2264

TUBE UP

AM PEAK HOUR 1030 TO 1130 VOLUME 275  
PM PEAK HOUR 1230 TO 0130 VOLUME 296  
AM TOTAL 428  
PM TOTAL 1836

07/10/19 WEDNESDAY												PM HOURS												DAILY TOTAL	
AM HOURS																									
12	1	2	3	4	5	6	7	8	9	10	11	12	1	2	3	4	5	6	7	8	9	10	11	12	
1	2	3	4	5	6	7	8	9	10	11	12	1	2	3	4	5	6	7	8	9	10	11	12		
00-15	7	10	4	5	9	20	45	78	58	38	57	70	67	54	45	39	42	54	32	43	25	14	5		
15-30	1	2	4	4	2	10	24	67	72	73	78	70	60	65	47	37	49	49	40	38	31	27	14	11	
30-45	5	3	4	2	9	17	31	69	82	73	59	60	60	80	50	53	31	33	48	37	29	16	17	16	
45-00	5	8	2	1	10	42	65	79	87	71	65	60	94	67	48	59	40	34	46	33	32	19	17	5	
HOUR																									
TOT	18	23	14	7	26	78	140	260	319	275	240	247	284	279	199	194	159	158	188	140	135	87	62	37	3569

AM PEAK HOUR 0800 TO 0900 VOLUME 319  
PM PEAK HOUR 1245 TO 0145 VOLUME 306  
AM TOTAL 1647  
PM TOTAL 1922

STATE OF WASHINGTON - DEPARTMENT OF TRANSPORTATION  
 TRIP SYSTEM  
 15 MINUTE TRAFFIC COUNT SUMMARY

SR 005 P500039 MP 000.30 OFF SYSTEM ID. LEG 2 DIRECTION OF TRAFFIC NORTHBOUND LANE 1 OF 2

COUNT IDENTIFIER 19-001 COUNTER NUMBER 281690 DESCRIPTION: ON SR 5 NB OFF RAMP TO 7TH ST/BROADWAY ST

07/11/19 THURSDAY												PM HOURS												DAILY TOTAL
AM HOURS																								
12	1	2	3	4	5	6	7	8	9	10	11	12	1	2	3	4	5	6	7	8	9	10	11	
1	2	3	4	5	6	7	8	9	10	11	12	1	2	3	4	5	6	7	8	9	10	11	12	
00-15	8	6	2	5	2	8	20	46	78	65	73	62	61	81	51	49	32	46	52	43	39	39		
15-30	7	8	7	2	1	13	27	66	96	61	58	57	76	77	50	39	58	52	40	42	33	21		
30-45	5	2	5	3	3	21	33	75	87	1	48	63	71	64	43	35	44	45	44	58	42	1		
45-00	9	10	1	1	7	35	71	73	73	73	53	65	61	75	41	37	49	42	39	35	42			
HOUR	-----																							
TOT	29	26	15	11	13	77	151	260	334	200	232	247	269	297	185	160	183	185	175	178	156	61		

COUNT LOW

AM PEAK HOUR 0745 TO 0845 VOLUME 334  
 PM PEAK HOUR 0100 TO 0200 VOLUME 297

AM TOTAL 1595  
 PM TOTAL 1849

07/12/19 FRIDAY												PM HOURS												DAILY TOTAL
AM HOURS																								
12	1	2	3	4	5	6	7	8	9	10	11	12	1	2	3	4	5	6	7	8	9	10	11	
1	2	3	4	5	6	7	8	9	10	11	12	1	2	3	4	5	6	7	8	9	10	11	12	
00-15					7	14																		
15-30					19	29																		
30-45			2	1	14																			
45-00				7	34																			
HOUR	-----																							
TOT			2	8	74	43																	127	

COUNT LOW

AM PEAK HOUR 0530 TO 0630 VOLUME 91  
 PM PEAK HOUR 0000 TO 0000 VOLUME 0

AM TOTAL 127  
 PM TOTAL 0

STATE OF WASHINGTON - DEPARTMENT OF TRANSPORTATION  
TRIP SYSTEM  
15 MINUTE TRAFFIC COUNT SUMMARY

SR 005 P500039 MP 000.30 OFF SYSTEM ID. LEG 2 DIRECTION OF TRAFFIC NORTHBOUND LANE 2 OF 2  
COUNT IDENTIFIER 19-001 COUNTER NUMBER 282304 \* DESCRIPTION: ON SR 5 NB OFF RAMP TO 7TH ST/BROADWAY ST

07/08/19 MONDAY												PM HOURS												DAILY TOTAL	
AM HOURS																									
12	1	2	3	4	5	6	7	8	9	10	11	12	1	2	3	4	5	6	7	8	9	10	11	12	
1	2	3	4	5	6	7	8	9	10	11	12	1	2	3	4	5	6	7	8	9	10	11	12	5	
												83	95	108	81	76	90	59	40	27	21	2	5	<i>COUNT LOW</i>	
												97	96	84	86	78	85	59	50	33	12	2			
												62	106	98	100	94	79	69	63	42	30		5		
												109	129	104	86	94	103	93	61	36	34	14			
TOT												171	415	393	378	355	336	337	242	168	124	47	4		10

AM PEAK HOUR 0000 TO 0000 VOLUME 0 AM TOTAL 171  
PM PEAK HOUR 1215 TO 0115 VOLUME 427 PM TOTAL 2809

07/09/19 TUESDAY												PM HOURS												DAILY TOTAL												
AM HOURS																																				
12	1	2	3	4	5	6	7	8	9	10	11	12	1	2	3	4	5	6	7	8	9	10	11	12												
1	2	3	4	5	6	7	8	9	10	11	12	1	2	3	4	5	6	7	8	9	10	11	12													
4	3	4		4	14	105	140	174	95	99	99	88	103	100	107	92	97	56	39	32	24	11	11													
	3	5		6	71	123	180	192	107	84	98	101	105	77	93	109	103	64	43	28	18	13	10													
				8	117	108	202	142	110	94	104	96	107	97	80	89	113	52	42	34	19	11	11													
			3	9	127	169	260	148	129	108	98	110	120	84	96	110	99	63	43	30	21	5	9													
TOT												4	6	9	3	27	329	505	782	656	441	385	399	395	435	358	376	400	412	235	167	124	82	40	41	6611

*COUNT LOW*

AM PEAK HOUR 0730 TO 0830 VOLUME 828 AM TOTAL 3546  
PM PEAK HOUR 0100 TO 0200 VOLUME 435 PM TOTAL 3065

07/10/19 WEDNESDAY												PM HOURS												DAILY TOTAL												
AM HOURS																																				
12	1	2	3	4	5	6	7	8	9	10	11	12	1	2	3	4	5	6	7	8	9	10	11	12												
1	2	3	4	5	6	7	8	9	10	11	12	1	2	3	4	5	6	7	8	9	10	11	12													
14		3	6	4	24	95	117	190	94	90	128	115	119	88	75	76	92	84	63	40	27	21	9													
4	4	3	1	2	67	112	182	165	112	92	127	114	91	69	105	110	94	89	44	38	16	9	4													
4	4	2	6	13	105	128	219	159	137	124	114	113	103	101	79	88	83	63	31	29	26	10	10													
7	4	3	6	9	106	182	271	150	109	147	138	124	101	121	94	117	96	70	44	29	14	16	6													
TOT												29	12	11	19	28	302	517	789	664	452	453	507	466	414	379	353	391	365	306	182	136	83	56	29	6943

AM PEAK HOUR 0715 TO 0815 VOLUME 862 AM TOTAL 3783  
PM PEAK HOUR 1215 TO 0115 VOLUME 470 PM TOTAL 3160

STATE OF WASHINGTON - DEPARTMENT OF TRANSPORTATION  
TRIP SYSTEM  
15 MINUTE TRAFFIC COUNT SUMMARY

SR 005 P500039 MP 000.30 OFF SYSTEM ID. LEG 2 DIRECTION OF TRAFFIC NORTHBOUND LANE 2 OF 2

COUNT IDENTIFIER 19-001 COUNTER NUMBER 282304 \* DESCRIPTION: ON SR 5 NB OFF RAMP TO 7TH ST/BROADWAY ST

	07/11/19 THURSDAY AM HOURS												PM HOURS												DAILY TOTAL
	12	1	2	3	4	5	6	7	8	9	10	11	12	1	2	3	4	5	6	7	8	9	10	11	
00-15	10	3	1	3	3	11	92	119	162	120	87	107	108	108	100	98	91	140	97	66	41	19	1	3	<i>COUNT LOW</i>
15-30	10	5	3	7	6	54	123	191	134	112	88	150	103	114	102	105	115	122	101	45	45	1			
30-45	9	3	2	4	8	108	111	197	98	130	99	142	114	122	84	119	108	123	100	53	30	20	2		
45-00	6	1	1	6	10	101	164	265	195	134	145	146	123	143	94	107	140	160	72	41	39		3	2	
TOT	35	12	7	20	27	274	490	772	589	496	419	545	448	487	380	429	454	545	370	205	155	40	6	5	

AM PEAK HOUR 0715 TO 0815 VOLUME 815  
PM PEAK HOUR 0500 TO 0600 VOLUME 545

AM TOTAL 3686  
PM TOTAL 3524

	07/12/19 FRIDAY AM HOURS												PM HOURS												DAILY TOTAL
	12	1	2	3	4	5	6	7	8	9	10	11	12	1	2	3	4	5	6	7	8	9	10	11	
00-15	2	4		3	2	8	71																		
15-30	5			1		20	104																		
30-45					1	63																			
45-00	1	3	2	4	6	93																			
TOT	8	7	2	8	9	184	175																		393

*COUNT LOW*

AM PEAK HOUR 0530 TO 0630 VOLUME 331  
PM PEAK HOUR 0000 TO 0000 VOLUME 0

AM TOTAL 393  
PM TOTAL 0

STATE OF WASHINGTON - DEPARTMENT OF TRANSPORTATION  
TRIP SYSTEM  
15 MINUTE TRAFFIC COUNT SUMMARY

SR 005 P500039 MP 000.30 OFF SYSTEM ID. LEG 2 DIRECTION OF TRAFFIC NORTHBOUND LANE 12 OF 2  
COUNT IDENTIFIER 19-001 COUNTER NUMBER 282304 \* DESCRIPTION: ON SR 5 NB OFF RAMP TO 7TH ST/BROADWAY ST

07/08/19 MONDAY												PM HOURS												DAILY TOTAL
AM HOURS																								
12	1	2	3	4	5	6	7	8	9	10	11	12	1	2	3	4	5	6	7	8	9	10	11	12
1	2	3	4	5	6	7	8	9	10	11	12	1	2	3	4	5	6	7	8	9	10	11	12	
00-15												135	151	159	138	114	124	83	75	54	37	8		
15-30												168	158	132	123	116	119	77	81	66	38	9		
30-45												165	168	159	139	112	108	98	80	51	5			
45-00												179	216	167	131	132	149	134	94	75	51	14		
HOUR	-----																							
TOT												179	684	644	581	532	491	485	352	311	222	94	17	4592

TUBE UP

AM PEAK HOUR 0000 TO 0000 VOLUME 0 AM TOTAL 179  
PM PEAK HOUR 1215 TO 0115 VOLUME 700 PM TOTAL 4413

07/09/19 TUESDAY												PM HOURS												DAILY TOTAL		
AM HOURS																										
12	1	2	3	4	5	6	7	8	9	10	11	12	1	2	3	4	5	6	7	8	9	10	11	12		
1	2	3	4	5	6	7	8	9	10	11	12	1	2	3	4	5	6	7	8	9	10	11	12			
00-15												99	152	157	177	154	149	138	142	96	84	83	51	24	21	
15-30												106	167	159	180	132	130	144	153	98	66	65	38	28	25	
30-45												172	158	172	174	146	111	127	147	89	78	77	35	23	16	
45-00												183	175	181	185	127	134	143	149	96	74	56	37	15	15	
HOUR	-----																									
TOT												560	652	669	716	559	524	552	591	379	302	281	161	90	77	6113

TUBE UP

AM PEAK HOUR 1030 TO 1130 VOLUME 674 AM TOTAL 1212  
PM PEAK HOUR 0100 TO 0200 VOLUME 716 PM TOTAL 4901

07/10/19 WEDNESDAY												PM HOURS												DAILY TOTAL	
AM HOURS																									
12	1	2	3	4	5	6	7	8	9	10	11	12	1	2	3	4	5	6	7	8	9	10	11	12	
1	2	3	4	5	6	7	8	9	10	11	12	1	2	3	4	5	6	7	8	9	10	11	12		
00-15	21	10	7	6	9	33	115	162	268	152	128	185	185	186	142	120	115	134	138	95	83	52	35	14	
15-30	5	6	7	5	4	77	136	249	237	185	170	197	174	156	116	142	159	143	129	82	69	43	23	15	
30-45	9	7	6	8	22	122	159	288	241	210	183	174	173	183	151	132	119	116	111	68	58	42	27	26	
45-00	12	12	5	7	19	148	247	350	237	180	212	198	218	168	169	153	157	130	116	77	61	33	33	11	
HOUR	-----																								
TOT	47	35	25	26	54	380	657	1049	983	727	693	754	750	693	578	547	550	523	494	322	271	170	118	66	10512

AM PEAK HOUR 0715 TO 0815 VOLUME 1155 AM TOTAL 5430  
PM PEAK HOUR 1215 TO 0115 VOLUME 751 PM TOTAL 5082

STATE OF WASHINGTON - DEPARTMENT OF TRANSPORTATION  
T R I P S S Y S T E M  
15 MINUTE TRAFFIC COUNT SUMMARY

SR 005 P500039 MP 000.30 OFF SYSTEM ID. LEG 2 DIRECTION OF TRAFFIC NORTHBOUND LANE 12 OF 2  
COUNT IDENTIFIER 19-001 COUNTER NUMBER 282304 \* DESCRIPTION: ON SR 5 NB OFF RAMP TO 7TH ST/BROADWAY ST

07/11/19 THURSDAY												PM HOURS												DAILY TOTAL
AM HOURS																								
12	1	2	3	4	5	6	7	8	9	10	11	12	1	2	3	4	5	6	7	8	9	10	11	12
00-15	18	9	3	8	5	19	112	165	240	185	160	169	169	189	151	147	123	186	149	109	80	58	1	3
15-30	17	13	10	9	7	67	150	257	230	173	146	207	179	191	152	144	173	174	141	87	78	22		
30-45	14	5	7	7	11	129	144	272	185	131	147	205	185	186	127	154	152	168	144	111	72	21	2	
45-00	15	11	2	7	17	136	235	338	268	207	198	211	184	218	135	144	189	202	111	76	81		3	2
TOT	64	38	22	31	40	351	641	1032	923	696	651	792	717	784	565	589	637	730	545	383	311	101	6	5

COUNT LOW

AM PEAK HOUR 0715 TO 0815 VOLUME 1107  
PM PEAK HOUR 0100 TO 0200 VOLUME 784

AM TOTAL 5281  
PM TOTAL 5373

07/12/19 FRIDAY												PM HOURS												DAILY TOTAL
AM HOURS																								
12	1	2	3	4	5	6	7	8	9	10	11	12	1	2	3	4	5	6	7	8	9	10	11	12
00-15	2	4		3	2	15	85																	
15-30	5			1		39	133																	
30-45				2	2	77																		
45-00	1	3	2	4	13	127																		
TOT	8	7	2	10	17	258	218																	520

COUNT LOW

AM PEAK HOUR 0530 TO 0630 VOLUME 422  
PM PEAK HOUR 0000 TO 0000 VOLUME 0

AM TOTAL 520  
PM TOTAL 0

07/08/19 THRU 07/12/19  
TOTAL HOURS FOR COUNT 79

2 DAYS 10347 FACTOR GROUP P5S 9830 FACTOR GROUP P5S 8937  
AVG WEEKDAY VOL 10583 X SEASONAL ADJ. FACTOR 0.9500 = 10054 X AXLE CORR FACTOR 0.9092 = ESTIMATED AVG DAILY TRAFFIC 9141

PEAK HOUR PERCENTAGES: K = 10.91 D = 100.00  
PEAK HOUR LOCATION : VOLUME = 1155 DATE: 07/10/19 TIME: 07:15 AM

RU

Interval  60 min.  15 min.  
 Binned(CL/SP)  Count(volume)  
Lane No  1  2

Direction Channel 1 \_\_\_\_\_  
Direction Channel 2 \_\_\_\_\_  
Unique ID# \_\_\_\_\_

Counter No. 288695 Count ID 19-001  
SR 5 RRT/RRQ P6 00039 MP 0.00  
Leg 2 Direction NB OSID \_\_\_\_\_

Station Description ON SR 5 NB off ramp to Broadway St

Date	Day	Time	Comments
7/8/19	2	11:49	Manual (1) <u>5</u> (2) _____ Counter (1) <u>5</u> (2) _____ Set up ok JDM/TPS 6.4v
7/9/19	3	10:35	Manual (1) <u>35</u> (2) _____ Counter (1) <u>35</u> (2) _____ Check ok JDM/TSP 6.4v
7/10/19	4	11:21	Manual (1) <u>25</u> (2) _____ Counter (1) <u>25</u> (2) _____ Check ok JDM/TSP 6.4v water in tube replaced @ 11:21
7/11/19	5	08:10	Manual (1) <u>30</u> (2) _____ Counter (1) <u>30</u> (2) _____ Check ok JDM/TSP 6.4v
7/12/19	6	06:45	Manual (1) <u>1</u> (2) _____ Counter (1) <u>1</u> (2) _____ P/U ok JDM/TSP 6.5v

Sketch

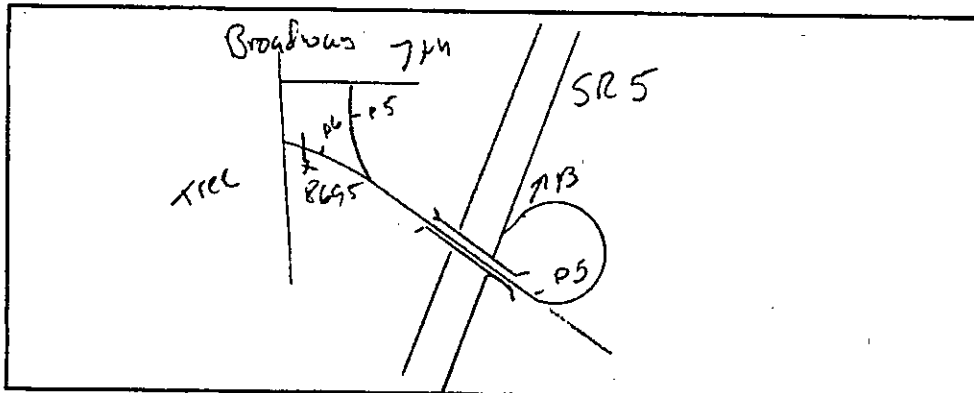

J. Myer  
Field Person

STATE OF WASHINGTON - DEPARTMENT OF TRANSPORTATION  
TRIPS SYSTEM  
15 MINUTE TRAFFIC COUNT SUMMARY

SR 005 P600039 MP 000.00 OFF SYSTEM ID. LEG 2 DIRECTION OF TRAFFIC NORTHBOUND LANE ALL OF  
COUNT IDENTIFIER 19-001 COUNTER NUMBER 288695 DESCRIPTION: ON SR 5 NB OFF RAMP TO BROADWAY ST

07/08/19 MONDAY												PM HOURS												DAILY TOTAL																																																																																																																							
AM HOURS																																																																																																																																															
12	1	2	3	4	5	6	7	8	9	10	11	12	1	2	3	4	5	6	7	8	9	10	11																																																																																																																								
1	2	3	4	5	6	7	8	9	10	11	12	1	2	3	4	5	6	7	8	9	10	11	12																																																																																																																								
00-15												75	82	78	71	58	61	45	41	22	19			<i>COUNT LOW</i>																																																																																																																							
15-30												73	78	63	62	59	60	44	46	35	15	1	2																																																																																																																								
30-45												87	77	62	67	50	44	57	42	29	3																																																																																																																										
45-00												107	83	55	49	78	67	54	40	33																																																																																																																											
HOUR	-----																																																																																																																																														
TOT	342											320											258											249											245											232											200											169											119											37											1											2											2174										

AM PEAK HOUR 0000 TO 0000 VOLUME 0 AM TOTAL 0  
PM PEAK HOUR 1230 TO 0130 VOLUME 354 PM TOTAL 2174

07/09/19 TUESDAY												PM HOURS												DAILY TOTAL																																																																																																																																																																																																																										
AM HOURS																																																																																																																																																																																																																																																		
12	1	2	3	4	5	6	7	8	9	10	11	12	1	2	3	4	5	6	7	8	9	10	11																																																																																																																																																																																																																											
1	2	3	4	5	6	7	8	9	10	11	12	1	2	3	4	5	6	7	8	9	10	11	12																																																																																																																																																																																																																											
00-15				2	3	7	81	98	102	67	67	68	83	89	78	67	61	65				2	1	1																																																																																																																																																																																																																										
15-30					2	68	95	92	138	82	70	91	71	86	71	55	67	8	1			2																																																																																																																																																																																																																												
30-45				1	8	112	71	137	86	72	83	69	86	89	61	37	60	3			2	1	1	1																																																																																																																																																																																																																										
45-00				1	12	98	104	167	105	84	82	69	96	88	62	62	69	1	1	2	1		1	1																																																																																																																																																																																																																										
HOUR	-----																																																																																																																																																																																																																																																	
TOT	4											25											285											351											494											431											305											302											297											336											352											272											221											257											77											2											4											3											4											3											3											4028										

*COUNT LOW*

AM PEAK HOUR 0730 TO 0830 VOLUME 544  
PM PEAK HOUR 1245 TO 0145 VOLUME 360

*TUBE UP*

AM TOTAL 2494  
PM TOTAL 1534

07/10/19 WEDNESDAY												PM HOURS												DAILY TOTAL																																																																																																																																																																																																																										
AM HOURS																																																																																																																																																																																																																																																		
12	1	2	3	4	5	6	7	8	9	10	11	12	1	2	3	4	5	6	7	8	9	10	11																																																																																																																																																																																																																											
1	2	3	4	5	6	7	8	9	10	11	12	1	2	3	4	5	6	7	8	9	10	11	12																																																																																																																																																																																																																											
00-15	1			1		5	1	3	2	3	1	98	93	60	72	50	63	72	56	39	34	19	7																																																																																																																																																																																																																											
15-30				1		1	3	1	2		13	90	89	48	71	82	80	69	44	42	26	13	8																																																																																																																																																																																																																											
30-45	2			1		2	3	2	2	1	99	87	90	73	55	55	54	51	36	35	23	10	11																																																																																																																																																																																																																											
45-00					3	2	4		2	1	108	118	81	94	68	82	65	62	45	32	24	22	6																																																																																																																																																																																																																											
HOUR	-----																																																																																																																																																																																																																																																	
TOT	3											2											7											11											10											6											8											5											221											393											353											275											266											269											262											254											181											148											107											64											32											2877										

*TUBE UP*

AM PEAK HOUR 1100 TO 1200 VOLUME 221  
PM PEAK HOUR 1200 TO 0100 VOLUME 393

AM TOTAL 273  
PM TOTAL 2604



STATE OF WASHINGTON - DEPARTMENT OF TRANSPORTATION  
TRIPS SYSTEM  
15 MINUTE TRAFFIC COUNT SUMMARY

SR 005 P600039 MP 000.00 OFF SYSTEM ID. LEG 2 DIRECTION OF TRAFFIC NORTHBOUND LANE ALL OF

COUNT IDENTIFIER 19-001 COUNTER NUMBER 288695 DESCRIPTION: ON SR 5 NB OFF RAMP TO BROADWAY ST

07/11/19 THURSDAY												PM HOURS												DAILY TOTAL	
AM HOURS																									
12	1	2	3	4	5	6	7	8	9	10	11	12	1	2	3	4	5	6	7	8	9	10	11	12	
1	2	3	4	5	6	7	8	9	10	11	12	1	2	3	4	5	6	7	8	9	10	11	12		
00-15	10	4	2	5	3	14	79	68	126	80	82	83	96	105	74	79	74	109	93	70	45	34			
15-30	5	6	7	3	3	54	95	109	93	66	59	124	90	108	77	86	79	99	93	52	38	14	1		
30-45	9	5	7	5	6	100	75	138	92	69	67	118	94	99	60	77	87	107	90	64	46		1		
45-00	9	8	2	3	12	82	111	157	108	96	103	116	87	102	70	74	94	131	68	52	42	1			
HOUR	-----																								
TOT	33	23	18	16	24	250	360	472	419	311	311	441	367	414	281	316	334	446	344	238	171	49	1	1	5640

AM PEAK HOUR 0715 TO 0815 VOLUME 530 AM TOTAL 2678  
PM PEAK HOUR 0500 TO 0600 VOLUME 446 PM TOTAL 2982

07/12/19 FRIDAY												PM HOURS												DAILY TOTAL
AM HOURS																								
12	1	2	3	4	5	6	7	8	9	10	11	12	1	2	3	4	5	6	7	8	9	10	11	12
1	2	3	4	5	6	7	8	9	10	11	12	1	2	3	4	5	6	7	8	9	10	11	12	
00-15					8	56																		
15-30					29	92																		
30-45					62																			
45-00				4	88																			
HOUR	-----																							
TOT				4	187	148																		339

COUNT LOW

AM PEAK HOUR 0530 TO 0630 VOLUME 298 AM TOTAL 339  
PM PEAK HOUR 0000 TO 0000 VOLUME 0 PM TOTAL 0

07/08/19 THRU 07/12/19  
 TOTAL HOURS FOR COUNT 90  
 DAYS 5  
 AVG WEEKDAY VOL 4182 X SEASONAL ADJ. FACTOR 0.9500 = 3973 X AXLE CORR FACTOR 0.9092 = ESTIMATED AVG DAILY TRAFFIC 3612  
 PEAK HOUR PERCENTAGES: K = 10.30 D = 100.00  
 PEAK HOUR LOCATION : VOLUME = 544 DATE: 07/09/19 TIME: 07:30 AM

NOTE: ONE DAY



*RW*

Interval  60 min.  15 min.  
 Binned(CL/SP)  Count(volume)  
Lane No  1  2

---

Direction Channel 1 \_\_\_\_\_  
Direction Channel 2 \_\_\_\_\_  
Unique ID# \_\_\_\_\_

Counter No. 281692 Count ID 19-001  
SR 5 RRT/RRQ P1 00028 MP 0.00  
Leg 2 Direction NB OSID \_\_\_\_\_

Station Description \_ ON SR 5 NB off ramp to SR 14 EB

Date	Day	Time	Comments
7/8/19	2	12:14	Manual (1) <u>10</u> (2) _____ Counter (1) <u>10</u> (2) _____ Set up ok JDM/TSP 6.5v
7/9/19	3	10:57	Manual (1) <u>50</u> (2) _____ Counter (1) <u>50</u> (2) _____ Check ok JDM/TSP 6.7v Tube split in half fixed @ 10:57
7/10/19	4	11:45	Manual (1) <u>43</u> (2) _____ Counter (1) <u>43</u> (2) _____ Check ok JDM/TSP 6.8v
7/11/19	5	08:39	Manual (1) <u>50</u> (2) _____ Counter (1) <u>50</u> (2) _____ Check ok JDM/TSP 7.0
7/12/19	6	06:56	Manual (1) <u>1</u> (2) _____ Counter (1) <u>1</u> (2) _____ P/U ok JDM/TSP 6.6v

Sketch

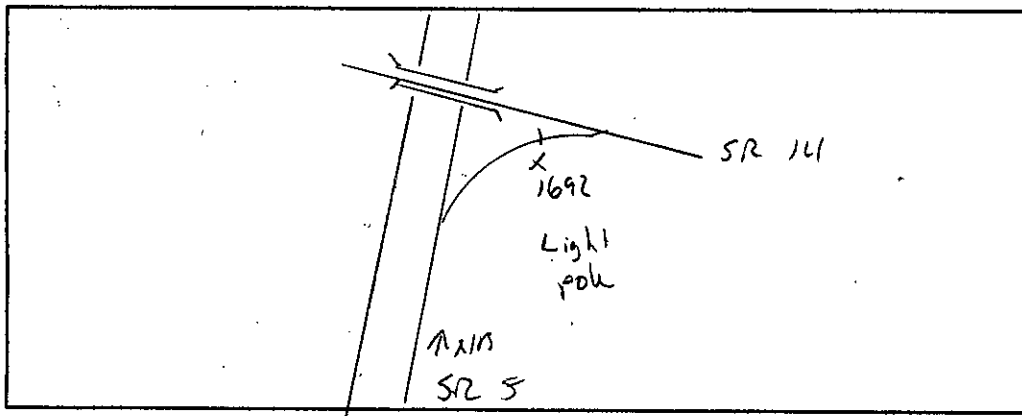

*J. Myler*  
Field Person

STATE OF WASHINGTON - DEPARTMENT OF TRANSPORTATION  
T R I P S S Y S T E M  
15 MINUTE TRAFFIC COUNT SUMMARY

SR 005 P100028 MP 000.00	OFF SYSTEM ID.	LEG 2	DIRECTION OF TRAFFIC NORTHBOUND												LANE ALL	OF											
COUNT IDENTIFIER 19-001	COUNTER NUMBER 281692	DESCRIPTION: ON SR 5 NB OFF RAMP TO SR 14 EB																									
07/08/19 MONDAY	AM HOURS												PM HOURS														
	12	1	2	3	4	5	6	7	8	9	10	11	12	1	2	3	4	5	6	7	8	9	10	11	12	DAILY	TOTAL
00-15														242	251	241	267	262	245	213	162	144	95	74			
15-30													216	239	225	227	245	244	224	206	168	133	98	59			
30-45													256	229	236	250	254	246	214	184	147	132	87	52			
45-00													252	263	261	262	276	249	172	190	159	104	78	46			
HOUR	-----																										
TOT													724	973	973	980	1042	1001	855	793	636	513	358	231	9079		

AM PEAK HOUR 0000 TO 0000 VOLUME 0 AM TOTAL 0  
PM PEAK HOUR 0400 TO 0500 VOLUME 1042 PM TOTAL 9079

07/09/19 TUESDAY	AM HOURS												PM HOURS														
	12	1	2	3	4	5	6	7	8	9	10	11	12	1	2	3	4	5	6	7	8	9	10	11	12	DAILY	TOTAL
00-15	42	23	33	20	29	33	121	172	194	194	222	254	241	225	233	232	225	228	187	204	119	103	95				
15-30	39	22	21	18	22	49	130	178	181	180	258	235	233	247	232	230	250	227	204	187	146	86	77				
30-45	44	23	32	25	38	96	207	228	193	96	226	277	239	251	254	248	232	224	196	144	120	96	57				
45-00	35	21	20	20	53	86	169	211	176		34	223	241	247	250	265	252	234	229	197	138	95	99	44			
HOUR	-----																										
TOT	160	89	106	83	142	264	627	789	744	470	34	929	1007	960	973	984	962	941	908	784	673	480	384	273	13766		

AM PEAK HOUR 1100 TO 1200 VOLUME 929 AM TOTAL 4437  
PM PEAK HOUR 1200 TO 0100 VOLUME 1007 PM TOTAL 9329

07/10/19 WEDNESDAY	AM HOURS												PM HOURS														
	12	1	2	3	4	5	6	7	8	9	10	11	12	1	2	3	4	5	6	7	8	9	10	11	12	DAILY	TOTAL
00-15	47	23	22	18	22	52	113	168	209	208	191	188	250	266	239	250	290	264	244	202	204	162	107	75			
15-30	46	24	26	10	34	58	130	183	214	193	249	226	269	271	238	244	270	277	263	230	185	149	123	61			
30-45	37	24	17	17	41	90	215	196	192	196	180	266	262	222	213	275	272	267	259	217	170	145	86	65			
45-00	46	16	17	26	42	91	158	224	222	159	203	248	241	256	239	277	271	256	207	186	161	143	89	44			
HOUR	-----																										
TOT	176	87	82	71	139	291	616	771	837	756	823	928	1022	1015	929	1046	1103	1064	973	835	720	599	405	245	15533		

AM PEAK HOUR 1100 TO 1200 VOLUME 928 AM TOTAL 5577  
PM PEAK HOUR 0330 TO 0430 VOLUME 1112 PM TOTAL 9956

STATE OF WASHINGTON - DEPARTMENT OF TRANSPORTATION  
 TRIP SYSTEM  
 15 MINUTE TRAFFIC COUNT SUMMARY

SR 005 P100028 MP 000.00 OFF SYSTEM ID. LEG 2 DIRECTION OF TRAFFIC NORTHBOUND LANE ALL OF  
 COUNT IDENTIFIER 19-001 COUNTER NUMBER 281692 DESCRIPTION: ON SR 5 NB OFF RAMP TO SR 14 EB

07/11/19 THURSDAY				AM HOURS								PM HOURS								DAILY TOTAL				
12	1	2	3	4	5	6	7	8	9	10	11	12	1	2	3	4	5	6	7		8	9	10	11
00-15	48	25	24	17	28	36	120	187	237	189	225	260	221	242	260	255	236	227	167	193	176	159	81	
15-30	37	27	16	23	38	56	141	201	229	180	212	212	249	255	236	245	243	225	202	177	179	186	119	72
30-45	41	31	23	22	36	119	199	227	199	11	201	206	277	271	243	224	220	206	186	180	173	149	110	60
45-00	33	26	25	15	32	85	182	233	191	229	237	216	258	248	224	247	265	218	180	152	186	150	95	57
TOT	159	109	88	77	134	296	642	848	856	609	875	859	1044	995	945	976	983	885	795	676	731	661	483	270

14996

AM PEAK HOUR 0730 TO 0830 VOLUME 926 AM TOTAL 5552  
 PM PEAK HOUR 1200 TO 0100 VOLUME 1044 PM TOTAL 9444

07/12/19 FRIDAY				AM HOURS								PM HOURS								DAILY TOTAL				
12	1	2	3	4	5	6	7	8	9	10	11	12	1	2	3	4	5	6	7		8	9	10	11
00-15	46	32	29	24	29	32	114																	
15-30	47	23	27	14	26	47	160																	
30-45	50	29	32	15	27	78	184																	
45-00	40	16	39	29	49	90																		
TOT	183	100	127	82	131	247	458																	1328

AM PEAK HOUR 0545 TO 0645 VOLUME 548 AM TOTAL 1328  
 PM PEAK HOUR 0000 TO 0000 VOLUME 0 PM TOTAL 0

07/08/19 THRU 07/12/19  
 TOTAL HOURS FOR COUNT 89

2 1/2 DAYS 15265 FACTOR GROUP P5S 14502 FACTOR GROUP P5S 13185  
 AVG WEEKDAY VOL 14765 X SEASONAL ADJ. FACTOR 0.9500 = 14027 X AXLE CORR FACTOR 0.9092 = ESTIMATED AVG DAILY TRAFFIC 12753

PEAK HOUR PERCENTAGES: K = 7.25 D = 100.00  
 PEAK HOUR LOCATION : VOLUME = 1112 DATE: 07/10/19 TIME: 03:30 PM

*RW*

Interval  60 min.  15 min.  
 Binned(CL/SP)  Count(volume)  
Lane No  1  2

---

Direction Channel 1 \_\_\_\_\_  
Direction Channel 2 \_\_\_\_\_  
Unique ID# \_\_\_\_\_

Counter No. 288682 Count ID 19-001  
SR 5 RRT/RRQ Q1 00068 MP 0.00  
Leg 2 Direction NB OSID \_\_\_\_\_

Station Description ON SR 5 NB on ramp from SR 14 WB

Date	Day	Time	Comments
7/8/19	2	11:27	Manual (1) <u>10</u> (2) _____ Counter (1) <u>10</u> (2) _____ Set up ok JDM/TPS 6.8v
7/9/19	3	10:18	Manual (1) <u>50</u> (2) _____ Counter (1) <u>50</u> (2) _____ Check ok JDM/TSP 6.4v
7/10/19	4	11:09	Manual (1) <u>50</u> (2) _____ Counter (1) <u>50</u> (2) _____ Check ok JDM/TSP 6.9v
7/11/19	5	07:51	Manual (1) <u>50</u> (2) _____ Counter (1) <u>50</u> (2) _____ <i>Tube split</i> Check ok JDM/TSP 6.7v
7/12/19	6	06:30	Manual (1) <u>1</u> (2) _____ Counter (1) <u>1</u> (2) _____ P/U ok JDM/TSP 6.5v

Sketch

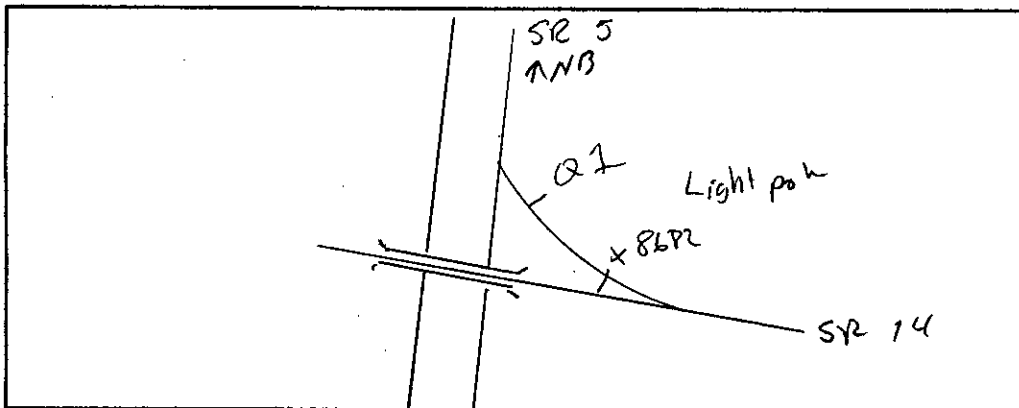

*J. Myer*  
Field Person

STATE OF WASHINGTON - DEPARTMENT OF TRANSPORTATION  
TRIPS SYSTEM  
15 MINUTE TRAFFIC COUNT SUMMARY

SR 005 Q100068 MP 000.00 OFF SYSTEM ID. LEG 2 DIRECTION OF TRAFFIC NORTHBOUND LANE ALL OF

COUNT IDENTIFIER 19-001 COUNTER NUMBER 288682 DESCRIPTION: ON SR 5 NB ON RAMP FROM SR 14 WB

07/08/19 MONDAY												PM HOURS											DAILY TOTAL	
AM HOURS																								
12	1	2	3	4	5	6	7	8	9	10	11	12	1	2	3	4	5	6	7	8	9	10	11	
1	2	3	4	5	6	7	8	9	10	11	12	1	2	3	4	5	6	7	8	9	10	11		
00-15												251	296	279	336	405	434	289	217	180	131	105	66	
15-30												252	271	300	341	385	456	297	186	162	104	95	57	
30-45												245	278	265	330	425	449	390	249	172	137	117	87	
45-00												241	292	284	311	404	424	355	240	160	129	101	66	
HOUR																								
TOT												486	1073	1116	1220	1506	1663	1635	1075	735	608	453	353	221

AM PEAK HOUR 0000 TO 0000 VOLUME 0 AM TOTAL 486  
PM PEAK HOUR 0430 TO 0530 VOLUME 1763 PM TOTAL 11658

07/09/19 TUESDAY												PM HOURS											DAILY TOTAL
AM HOURS																							
12	1	2	3	4	5	6	7	8	9	10	11	12	1	2	3	4	5	6	7	8	9	10	11
1	2	3	4	5	6	7	8	9	10	11	12	1	2	3	4	5	6	7	8	9	10	11	
00-15	41	22	30	12	24	37	158	244	257	200	214	229	252	243	277	313	409	440	316	239	175	116	91
15-30	40	20	11	19	33	74	232	268	281	199	230	243	278	281	302	346	423	441	325	203	167	110	86
30-45	32	19	28	27	47	131	266	302	275	244	244	231	261	241	303	412	464	381	293	206	174	109	90
45-00	28	27	23	42	59	175	300	340	272	257	263	253	318	292	344	376	461	384	242	184	119	94	60
HOUR																							
TOT	141	88	92	100	163	417	956	1154	1085	900	951	956	1109	1057	1226	1447	1757	1646	1176	832	635	429	327

AM PEAK HOUR 0730 TO 0830 VOLUME 1180 AM TOTAL 7003  
PM PEAK HOUR 0430 TO 0530 VOLUME 1806 PM TOTAL 11830

07/10/19 WEDNESDAY												PM HOURS											DAILY TOTAL
AM HOURS																							
12	1	2	3	4	5	6	7	8	9	10	11	12	1	2	3	4	5	6	7	8	9	10	11
1	2	3	4	5	6	7	8	9	10	11	12	1	2	3	4	5	6	7	8	9	10	11	
00-15	41	19	17	17	34	48	146	275	255	210	214	247	273	256	288	321	450	416	316	240	184	129	124
15-30	49	28	15	15	26	90	220	296	267	228	222	273	238	298	309	346	387	451	331	220	166	135	83
30-45	29	31	15	12	41	148	248	269	236	223	225	258	267	263	355	387	397	390	272	198	158	129	99
45-00	20	16	15	20	48	177	255	358	292	268	274	271	298	303	342	379	404	329	252	171	162	107	76
HOUR																							
TOT	139	94	62	64	149	463	869	1198	1050	929	935	1049	1076	1120	1294	1433	1638	1586	1171	829	670	500	382

AM PEAK HOUR 0700 TO 0800 VOLUME 1198 AM TOTAL 7001  
PM PEAK HOUR 0430 TO 0530 VOLUME 1668 PM TOTAL 11929

18833

18930

STATE OF WASHINGTON - DEPARTMENT OF TRANSPORTATION  
TRIP SYSTEM  
15 MINUTE TRAFFIC COUNT SUMMARY

SR 005 Q100068 MP 000.00 OFF SYSTEM ID. LEG 2 DIRECTION OF TRAFFIC NORTHBOUND LANE ALL OF

COUNT IDENTIFIER 19-001 COUNTER NUMBER 288682 DESCRIPTION: ON SR 5 NB ON RAMP FROM SR 14 WB

07/11/19 THURSDAY	AM HOURS											PM HOURS											DAILY TOTAL		
	12	1	2	3	4	5	6	7	8	9	10	11	12	1	2	3	4	5	6	7	8	9		10	11
00-15	42	25	22	17	33	52	173	249	253	253	188	235	268	282	292	305	415	481	331	238	176	182	130	85	
15-30	34	22	14	17	20	65	220	243	210	209	201	250	292	276	319	371	416	455	322	256	174	149	114	63	
30-45	31	26	21	22	38	143	260	85	176	256	241	293	260	285	305	426	479	454	268	223	181	157	96	53	
45-00	25	15	19	26	42	158	244	188	314	243	274	287	303	302	323	386	456	376	258	217	166	150	79	61	
HOUR	-----																								
TOT	132	88	76	82	133	418	897	765	953	961	904	1065	1123	1145	1239	1488	1766	1766	1179	934	697	638	419	262	19130

*COUNT LOW* AM PEAK HOUR 1100 TO 1200 VOLUME 1065 AM TOTAL 6474  
PM PEAK HOUR 0430 TO 0530 VOLUME 1871 PM TOTAL 12656

07/12/19 FRIDAY	AM HOURS											PM HOURS											DAILY TOTAL		
	12	1	2	3	4	5	6	7	8	9	10	11	12	1	2	3	4	5	6	7	8	9		10	11
00-15	44	23	26	16	42	69	110																		
15-30	43	29	23	21	40	69	205																		
30-45	38	31	17	20	35	107																			
45-00	33	33	20	31	38	173																			
HOUR	-----																								
TOT	158	116	86	88	155	418	315																		1336

AM PEAK HOUR 0530 TO 0630 VOLUME 595 AM TOTAL 1336  
PM PEAK HOUR 0000 TO 0000 VOLUME 0 PM TOTAL 0

07/08/19 THRU 07/12/19  
TOTAL HOURS FOR COUNT 90

*2* DAYS *18882* FACTOR GROUP P5S *17938* FACTOR GROUP P5S *16309*  
AVG WEEKDAY VOL 18964 X SEASONAL ADJ. FACTOR 0.9500 = 18016 X AXLE CORR FACTOR 0.9092 = ESTIMATED AVG DAILY TRAFFIC 16380

PEAK HOUR PERCENTAGES: K = *9.91* D = 100.00  
PEAK HOUR LOCATION : VOLUME = 1871 DATE: 07/11/19 TIME: 04:30 PM

ONE DAY

**Diamond Traffic Counter**

*Ru*

Interval  60 min.  15 min.  
 Binned(CL/SP)  Count(volume)  
Lane No  1  2

---

Direction Channel 1 \_\_\_\_\_  
Direction Channel 2 \_\_\_\_\_  
Unique ID# \_\_\_\_\_

Counter No. 285878 Count ID 19-001  
SR 5 RRT/RRQ S6 00029 MP 0.00  
Leg 2 Direction SB OSID \_\_\_\_\_

Station Description ON SR 5 SB on ramp from Washington st

Date	Day	Time	Comments			
7/8/19	2	11:55	Manual (1) 10 (2) _____ Counter (1) 10 (2) _____	Set up ok	JDM/TPS	6.5v
7/9/19	3	10:43	Manual (1) 12 (2) _____ Counter (1) 12 (2) _____	Check ok	JDM/TSP	6.5v
7/10/19	4	11:33	Manual (1) 14 (2) _____ Counter (1) 14 (2) _____	Check ok Water in tube replaced @ 11:33	JDM/TSP	6.8v
7/11/19	5	08:17	Manual (1) 14 (2) _____ Counter (1) 14 (2) _____	Check ok	JDM/TSP	6.7v
7/12/19	6	06:48	Manual (1) 1 (2) _____ Counter (1) 1 (2) _____	P/U ok	JDM/TSP	6.5v

Sketch

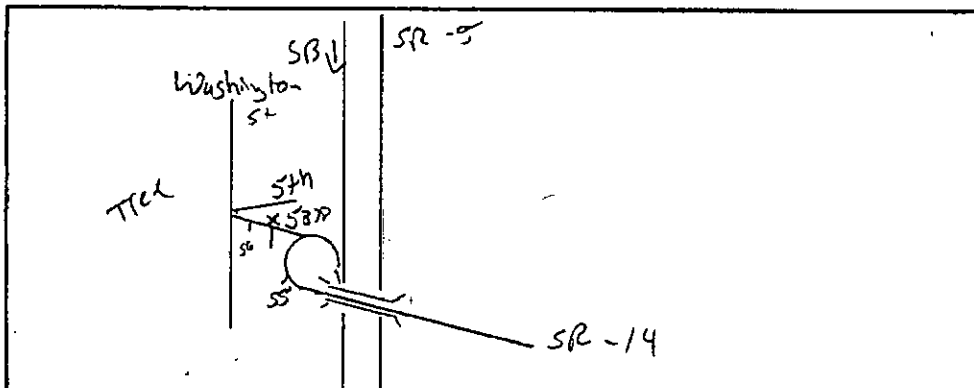

North

*J. Myler*  
Field Person



STATE OF WASHINGTON - DEPARTMENT OF TRANSPORTATION  
TRIP SYSTEM  
15 MINUTE TRAFFIC COUNT SUMMARY

SR 005 S600029 MP 000.00		OFF SYSTEM ID.	LEG 2		DIRECTION OF TRAFFIC SOUTHBOUND															LANE ALL OF						
COUNT IDENTIFIER 19-001		COUNTER NUMBER 285878	DESCRIPTION: ON SR 5 SB ON RAMP FROM WASHINGTON ST																							
07/08/19 MONDAY		AM HOURS									PM HOURS									DAILY						
12	1	2	3	4	5	6	7	8	9	10	11	12	1	2	3	4	5	6	7	8	9	10	11	12	TOTAL	
1	2	3	4	5	6	7	8	9	10	11	12	1	2	3	4	5	6	7	8	9	10	11	12	15		
00-15										73	66	68	76	59	96	57	38	21	20	13	15					
15-30										56	59	49	61	62	87	51	19	22	24	15	8					
30-45										63	48	71	54	72	64	34	23	23	24	9	8					
45-00										68	67	61	46	67	43	41	22	28	8	10	4					
HOUR	-----																									
TOT										260	240	249	237	260	290	183	102	94	76	47	35	2073				

AM PEAK HOUR 0000 TO 0000 VOLUME 0 AM TOTAL 0  
PM PEAK HOUR 0430 TO 0530 VOLUME 322 PM TOTAL 2073

07/09/19 TUESDAY		AM HOURS									PM HOURS									DAILY						
12	1	2	3	4	5	6	7	8	9	10	11	12	1	2	3	4	5	6	7	8	9	10	11	12	TOTAL	
1	2	3	4	5	6	7	8	9	10	11	12	1	2	3	4	5	6	7	8	9	10	11	12	15		
00-15	7	2	3	2	4	65	67	60	41	47	71	83	64	49	80	71	88	52	39	36	6	4	2			
15-30	5	1	1	1	3	64	59	65	53	37	52	68	79	67	61	53	64	100	38	32	41	6	5	1		
30-45	6	4	2	2	9	66	54	65	41	45	45	62	77	57	54	50	68	73	35	30	26	2	5	1		
45-00	2	5	3	3	9	68	62	56	33	42	50	66	61	68	31	44	64	66	37	28	14	3	6	1		
HOUR	-----																									
TOT	20	12	9	6	23	202	240	253	187	165	194	267	300	256	195	227	267	327	162	129	117	17	20	5	3600	

AM PEAK HOUR 1100 TO 1200 VOLUME 267 AM TOTAL 1578  
PM PEAK HOUR 0500 TO 0600 VOLUME 327 PM TOTAL 2022

07/10/19 WEDNESDAY		AM HOURS									PM HOURS									DAILY						
12	1	2	3	4	5	6	7	8	9	10	11	12	1	2	3	4	5	6	7	8	9	10	11	12	TOTAL	
1	2	3	4	5	6	7	8	9	10	11	12	1	2	3	4	5	6	7	8	9	10	11	12	15		
00-15			1	1		33	22	15	2	1	1	84	65	85	70	83	94	53	45	38	27	19	18			
15-30					1	29	27	2			3	73	74	69	49	65	86	57	32	40	35	15	9			
30-45	1	1	1		8	14	37	2		5	52	61	68	70	54	59	74	44	30	18	32	15	8			
45-00				1	18	20	33	2	1	16	70	63	61	57	38	67	57	42	26	39	15	16	16			
HOUR	-----																									
TOT	1	1	2	1	1	27	96	119	21	3	22	126	281	268	281	211	274	311	196	133	135	109	65	51	2735	

TUBE UP

AM PEAK HOUR 1100 TO 1200 VOLUME 126 AM TOTAL 420  
PM PEAK HOUR 0445 TO 0545 VOLUME 321 PM TOTAL 2315

TUBE UP

AM LOW

STATE OF WASHINGTON - DEPARTMENT OF TRANSPORTATION  
TRIP SYSTEM  
15 MINUTE TRAFFIC COUNT SUMMARY

SR 005 S600029 MP 000.00 OFF SYSTEM ID. LEG 2 DIRECTION OF TRAFFIC SOUTHBOUND LANE ALL OF  
COUNT IDENTIFIER 19-001 COUNTER NUMBER 285878 DESCRIPTION: ON SR 5 SB ON RAMP FROM WASHINGTON ST

07/11/19 THURSDAY												AM HOURS												PM HOURS												DAILY TOTAL																																																																																																																					
12	1	2	3	4	5	6	7	8	9	10	11	12	1	2	3	4	5	6	7	8	9	10	11	12	1	2	3	4	5	6	7	8	9	10	11		12																																																																																																																				
00-15	5	12	3	2	1	12	81	102	62	41	51	72	85	70	76	72	82	102	47	48	31	31	16	15	15-30	4	6	8	4	6	37	103	103	46	46	68	113	66	68	70	50	65	68	55	38	42	48	21	6	30-45	10	4	4	2	5	96	113	79	39	61	68	104	59	76	73	65	72	61	37	32	51	28	27	13	45-00	8	4	1	1	6	90	122	70	24	45	77	134	63	80	56	61	60	58	53	42	43	32	19	8	HOUR		-----																								TOT		27	26	16	9	18	235	419	354	171	193	264	423	273	294	275	248	279	289	192	160	167	139	83	42	4596	
HOUR		-----																																																																																																																																																							
TOT		27	26	16	9	18	235	419	354	171	193	264	423	273	294	275	248	279	289	192	160	167	139	83	42	4596																																																																																																																															

AM PEAK HOUR 0615 TO 0715 VOLUME 440 AM TOTAL 2155  
PM PEAK HOUR 0430 TO 0530 VOLUME 302 PM TOTAL 2441

07/12/19 FRIDAY												AM HOURS												PM HOURS												DAILY TOTAL																																																																																																																													
12	1	2	3	4	5	6	7	8	9	10	11	12	1	2	3	4	5	6	7	8	9	10	11	12	1	2	3	4	5	6	7	8	9	10	11		12																																																																																																																												
00-15	11	8	4	2	5	7	48																				15-30	14	4	3	2	3	12	96																				30-45	9	2	9	4	3	56	89																				45-00	7	2	4	1	6	70																				HOUR		-----																								TOT		41	16	20	9	17	145	233																				481
HOUR		-----																																																																																																																																																															
TOT		41	16	20	9	17	145	233																				481																																																																																																																																					

AM PEAK HOUR 0545 TO 0645 VOLUME 303 AM TOTAL 481  
PM PEAK HOUR 0000 TO 0000 VOLUME 0 PM TOTAL 0

07/08/19 THRU 07/12/19  
TOTAL HOURS FOR COUNT 90

1/3 DAYS 4596 FACTOR GROUP P55 4366 FACTOR GROUP P55 3970  
AVG WEEKDAY VOL 3644 X SEASONAL ADJ. FACTOR 0.9500 = 3462 X AXLE CORR FACTOR 0.9092 = ESTIMATED AVG DAILY TRAFFIC 3148

PEAK HOUR PERCENTAGES: K = 12.07 D = 100.00  
PEAK HOUR LOCATION : VOLUME = 440 DATE: 07/11/19 TIME: 06:15 AM

NOTE: ONE DAY



*RU*

Interval  60 min.  15 min.  
 Binned(CL/SP)  Count(volume)  
 Lane No  1  2

---

Direction Channel 1 \_\_\_\_\_  
 Direction Channel 2 \_\_\_\_\_  
 Unique ID# \_\_\_\_\_

Counter No. 284912 Count ID 19-001  
 SR 5 RRT/RRQ R1 00079 MP 0.00  
 Leg 2 Direction SB OSID \_\_\_\_\_

Station Description \_ ON SR 5 SB off ramp to SR 14 EB

Date	Day	Time	Comments			
7/8/19	2	11:10	Manual (1) 10 (2) _____ Counter (1) 10 (2) _____	Set up ok	JDM/TPS	6.4v
7/9/19	3	12:15	Manual (1) 50 (2) _____ Counter (1) 50 (2) _____	Check ok	JDM/TSP	6.4v
7/10/19	4	11:02	Manual (1) 50 (2) _____ Counter (1) 50 (2) _____	Check ok	JDM/TSP	6.4v
7/11/19	5	10:15	Manual (1) 50 (2) _____ Counter (1) 50 (2) _____	Check ok	JDM/TSP	6.4v
7/12/19	6	08:01	Manual (1) _____ (2) _____ Counter (1) _____ (2) _____	P/Uok	JDM/TSP	6.4v

*Tube had hole in it*

Sketch

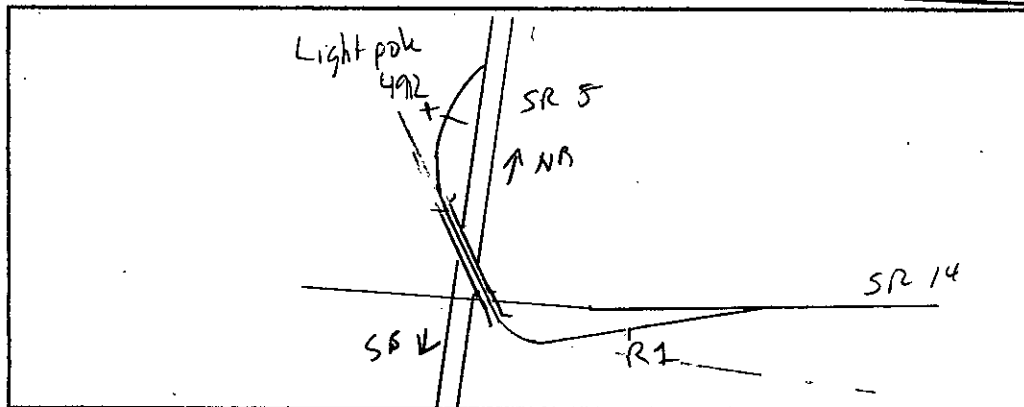

*T. M. [Signature]*  
Field Person

STATE OF WASHINGTON - DEPARTMENT OF TRANSPORTATION  
TRIP SYSTEM  
15 MINUTE TRAFFIC COUNT SUMMARY

SR 005 R100079 MP 000.00 OFF SYSTEM ID. LEG 2 DIRECTION OF TRAFFIC SOUTHBOUND LANE ALL OF  
COUNT IDENTIFIER 19-001 COUNTER NUMBER 284912 DESCRIPTION: ON SR 5 SB OFF RAMP TO SR 14 EB

07/08/19 MONDAY												PM HOURS											DAILY			
AM HOURS																							TOTAL			
12	1	2	3	4	5	6	7	8	9	10	11	12	1	2	3	4	5	6	7	8	9	10	11			
1	2	3	4	5	6	7	8	9	10	11	12	1	2	3	4	5	6	7	8	9	10	11	12			
00-15												301	275	280	312	369	434	264	209	132	117	77	43			
15-30												230	258	279	255	278	338	351	239	173	120	129	79	38		
30-45												271	261	262	324	317	404	320	195	157	113	100	63	35		
45-00												265	268	243	300	343	348	258	200	134	109	76	53	37		
HOUR	-----																									
TOT												766	1088	1059	1159	1250	1459	1363	898	673	474	422	272	153	11036	

AM PEAK HOUR 0000 TO 0000 VOLUME 0 AM TOTAL 766  
PM PEAK HOUR 0430 TO 0530 VOLUME 1537 PM TOTAL 10270

07/09/19 TUESDAY												PM HOURS											DAILY		
AM HOURS																							TOTAL		
12	1	2	3	4	5	6	7	8	9	10	11	12	1	2	3	4	5	6	7	8	9	10	11		
1	2	3	4	5	6	7	8	9	10	11	12	1	2	3	4	5	6	7	8	9	10	11	12		
00-15	25	23	9	30	42	79	108	97	190	231	226	280	293	300	292	324	370	438	265	188	159	111	60	76	
15-30	22	11	21	29	62	113	92	83	250	223	219	264	306	275	262	289	387	361	236	163	112	120	36	38	
30-45	19	12	15	34	63	142	79	118	272	273	253	276	254	269	316	345	419	350	213	120	110	103	51	44	
45-00	21	13	14	25	91	115	69	165	250	245	237	280	294	291	325	291	327	274	172	140	120	66	46	34	
HOUR	-----																								
TOT	87	59	59	118	258	449	348	463	962	972	935	1100	1147	1135	1195	1249	1503	1423	886	611	501	400	193	192	16245

AM PEAK HOUR 1100 TO 1200 VOLUME 1100 AM TOTAL 5810  
PM PEAK HOUR 0415 TO 0515 VOLUME 1571 PM TOTAL 10435

07/10/19 WEDNESDAY												PM HOURS											DAILY		
AM HOURS																							TOTAL		
12	1	2	3	4	5	6	7	8	9	10	11	12	1	2	3	4	5	6	7	8	9	10	11		
1	2	3	4	5	6	7	8	9	10	11	12	1	2	3	4	5	6	7	8	9	10	11	12		
00-15	33	19	15	35	48	91	110	85	229	235	235	279	295	291	271	348	367	450	306	195	142	93	76	67	
15-30	27	12	18	23	55	103	89	116	222	220	241	261	281	297	278	304	336	409	264	202	151	91	72	51	
30-45	17	14	14	37	81	148	83	150	284	250	245	267	280	300	307	342	403	346	206	168	126	107	49	42	
45-00	27	10	18	35	91	108	102	199	238	246	276	318	301	257	293	339	381	303	190	142	116	77	46	29	
HOUR	-----																								
TOT	104	55	65	130	275	450	384	550	973	951	997	1125	1157	1145	1149	1333	1487	1508	966	707	535	368	243	189	16846

AM PEAK HOUR 1100 TO 1200 VOLUME 1125 AM TOTAL 6059  
PM PEAK HOUR 0430 TO 0530 VOLUME 1643 PM TOTAL 10787

DOT-RNB515A-B

STATE OF WASHINGTON - DEPARTMENT OF TRANSPORTATION  
TRIP SYSTEM  
15 MINUTE TRAFFIC COUNT SUMMARY

DATE 07/16/19  
TIME 07:42:19  
PAGE 12

SR 005 R100079 MP 000.00 OFF SYSTEM ID. LEG 2 DIRECTION OF TRAFFIC SOUTHBOUND LANE ALL OF

COUNT IDENTIFIER 19-001 COUNTER NUMBER 284912 DESCRIPTION: ON SR 5 SB OFF RAMP TO SR 14 EB

07/11/19 THURSDAY												07/11/19 THURSDAY												DAILY TOTAL	
AM HOURS						PM HOURS						PM HOURS													
12	1	2	3	4	5	6	7	8	9	10	11	12	1	2	3	4	5	6	7	8	9	10	11		
1	2	3	4	5	6	7	8	9	10	11	12	1	2	3	4	5	6	7	8	9	10	11	12		
00-15	33	17	11	25	46	100	92	87	196	271	235	263	307	246	236	257	308	308	164	111	102	61	60	38	
15-30	28	14	9	31	58	113	110	80	282	255	259	278	259	293	218	260	273	266	170	109	94	71	54	42	
30-45	37	14	28	31	74	130	92	159	310	248	254	275	279	223	233	296	303	231	157	107	81	53	40	33	
45-00	22	20	22	35	91	134	96	158	311	258	225	288	238	207	267	285	258	200	129	92	85	54	40	37	
TOT	120	65	70	122	269	477	390	484	1099	1032	973	1104	1083	969	954	1098	1142	1005	620	419	362	239	194	150	14440

AM PEAK HOUR 0815 TO 0915 VOLUME 1174  
PM PEAK HOUR 0345 TO 0445 VOLUME 1169

HOLE IN TUBE

AM TOTAL 6205  
PM TOTAL 8235

07/12/19 FRIDAY												07/12/19 FRIDAY												DAILY TOTAL	
AM HOURS						PM HOURS						PM HOURS													
12	1	2	3	4	5	6	7	8	9	10	11	12	1	2	3	4	5	6	7	8	9	10	11		
1	2	3	4	5	6	7	8	9	10	11	12	1	2	3	4	5	6	7	8	9	10	11	12		
00-15	28	19	13	16	23	36	75	97																	
15-30	23	11	8	14	26	66	84	100																	
30-45	17	10	13	16	33	89	73	139																	
45-00	14	4	20	21	41	82	81	142																	
TOT	82	44	54	67	123	273	313	478																	1434

HOLE IN THE TUBE

AM PEAK HOUR 0700 TO 0800 VOLUME 478  
PM PEAK HOUR 0000 TO 0000 VOLUME 0

AM TOTAL 1434  
PM TOTAL 0

07/08/19 THRU 07/12/19  
TOTAL HOURS FOR COUNT 92

21 DAYS 16546 FACTOR GROUP P5S 15719 FACTOR GROUP P5S 14292  
AVG WEEKDAY VOL 15844 X SEASONAL ADJ. FACTOR 0.9500 = 15052 X AXLE CORR FACTOR 0.9092 = ESTIMATED AVG DAILY TRAFFIC 13685

PEAK HOUR PERCENTAGES: K = 10.37 D = 100.00  
PEAK HOUR LOCATION : VOLUME = 1643 DATE: 07/10/19 TIME: 04:30 PM



*RU*

Interval  60 min.  15 min.  
 Binned(CL/SP)  Count(volume)  
Lane No  1  2

---

Direction Channel 1 \_\_\_\_\_  
Direction Channel 2 \_\_\_\_\_  
Unique ID# \_\_\_\_\_

Counter No. 282300 Count ID 19-001  
SR 5 RRT/RRQ S5 00029 MP 0.00  
Leg 2 Direction SB OSID \_\_\_\_\_

Station Description \_ ON SR 5 SB on ramp from SR 14 WB

Date	Day	Time	Comments		
7/8/19	2	11:27	Manual (1) <u>10</u> (2) _____ Counter (1) <u>10</u> (2) _____	Set up ok	JDM/TPS 6.8v <i>TWO FILES</i>
7/9/19	3	10:23	Manual (1) <u>50</u> (2) _____ Counter (1) <u>50</u> (2) _____	Check ok	JDM/TSP 6.5v
7/10/19	4	11:14	Manual (1) <u>50</u> (2) _____ Counter (1) <u>50</u> (2) _____	Check ok	JDM/TSP 6.7v
7/11/19	5	<i>06:00</i>	Manual (1) <u>32</u> (2) _____ Counter (1) <u>32</u> (2) _____	Check ok	JDM/TSP <sup>6.5</sup> <i>2ND FILE STARTS AT 8:15</i> <i>#282301</i>
7/12/19	6	<i>06:35</i>	Manual (1) <u>1</u> (2) _____ Counter (1) <u>1</u> (2) _____	P/U ok	JDM/TSP 6.3v

Sketch

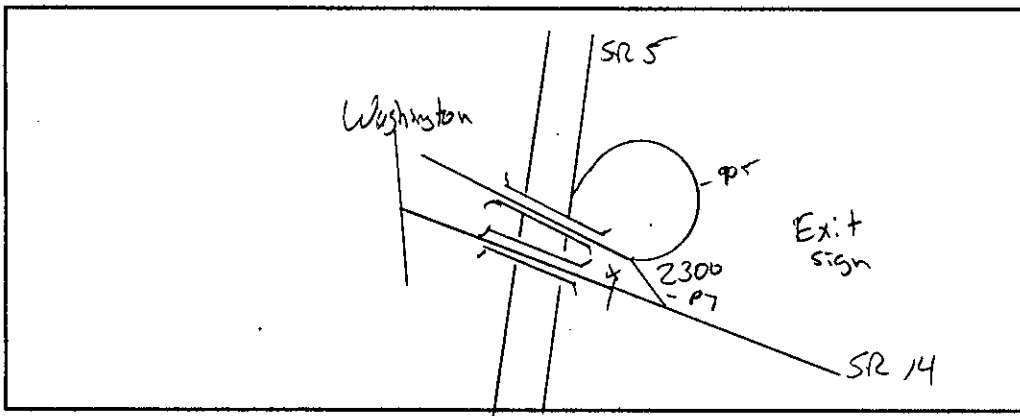

*J. Mueller*  
Field Person

STATE OF WASHINGTON - DEPARTMENT OF TRANSPORTATION  
T R I P S S Y S T E M  
15 MINUTE TRAFFIC COUNT SUMMARY

SR 005 S500029 MP 000.00	OFF SYSTEM ID.	LEG 2	DIRECTION OF TRAFFIC SOUTHBOUND																		LANE ALL OF					
COUNT IDENTIFIER 19-001	COUNTER NUMBER 282300	DESCRIPTION: ON SR 5 SB ON RAMP FROM SR 14 WB																								
07/08/19 MONDAY				AM HOURS								PM HOURS								DAILY TOTAL						
	12	1	2	3	4	5	6	7	8	9	10	11	12	1	2	3	4	5	6	7	8	9	10	11	12	
00-15													188	236	201	180	200	245	166	143	114	69	86	44		
15-30													204	212	203	164	234	232	208	112	100	105	65	32		
30-45												210	204	221	178	219	233	171	107	74	89	59	25			
45-00												204	174	173	187	209	189	162	116	102	93	60	33			
HOUR	-----																									
TOT												414	770	835	798	709	862	899	707	478	390	356	270	134	7622	

AM PEAK HOUR 0000 TO 0000 VOLUME 0 AM TOTAL 414  
 PM PEAK HOUR 0445 TO 0545 VOLUME 919 PM TOTAL 7208

07/09/19 TUESDAY				AM HOURS								PM HOURS								DAILY TOTAL						
	12	1	2	3	4	5	6	7	8	9	10	11	12	1	2	3	4	5	6	7	8	9	10	11	12	
00-15	23	22	20	23	61	205	127	125	126	195	219	191	217	221	185	158	212	233	212	143	111	67	49	38		
15-30	28	14	16	35	83	157	128	138	149	178	201	221	219	237	206	181	205	214	188	130	86	78	45	26		
30-45	22	28	14	31	109	130	127	129	159	215	187	219	219	210	181	192	237	262	174	137	91	87	45	21		
45-00	14	25	20	55	125	127	120	134	161	205	183	217	214	215	181	206	228	243	143	113	73	83	32	21		
HOUR	-----																									
TOT	87	89	70	144	378	619	502	526	595	793	790	848	869	883	753	737	882	952	717	523	361	315	171	106	12710	

AM PEAK HOUR 1100 TO 1200 VOLUME 848 AM TOTAL 5441  
 PM PEAK HOUR 0500 TO 0600 VOLUME 952 PM TOTAL 7269

07/10/19 WEDNESDAY				AM HOURS								PM HOURS								DAILY TOTAL						
	12	1	2	3	4	5	6	7	8	9	10	11	12	1	2	3	4	5	6	7	8	9	10	11	12	
00-15	24	14	19	26	52	198	121	125	131	174	215	170	152	193	211	182	239	225	196	155	133	83	65	39		
15-30	23	14	14	33	70	154	128	127	147	247	222	217	160	209	217	181	234	235	204	133	107	105	62	23		
30-45	22	21	16	39	116	126	130	121	144	212	127	208	252	209	192	190	211	211	169	119	79	103	44	22		
45-00	11	18	23	36	140	130	140	127	181	216	131	178	213	187	179	199	227	222	173	98	88	72	43	19		
HOUR	-----																									
TOT	80	67	72	134	378	608	519	500	603	849	695	773	777	798	799	752	911	893	742	505	407	363	214	103	12542	

AM PEAK HOUR 0915 TO 1015 VOLUME 890 AM TOTAL 5278  
 PM PEAK HOUR 0400 TO 0500 VOLUME 911 PM TOTAL 7264

STATE OF WASHINGTON - DEPARTMENT OF TRANSPORTATION  
TRIP SYSTEM  
15 MINUTE TRAFFIC COUNT SUMMARY

SR 005 S500029 MP 000.00 OFF SYSTEM ID. LEG 2 DIRECTION OF TRAFFIC SOUTHBOUND LANE ALL OF

COUNT IDENTIFIER 19-001 COUNTER NUMBER 282301 \* DESCRIPTION: ON SR 5 SB ON RAMP FROM SR 14 WB

07/11/19 THURSDAY

	AM HOURS											PM HOURS											DAILY TOTAL		
	12	1	2	3	4	5	6	7	8	9	10	11	12	1	2	3	4	5	6	7	8	9		10	11
00-15	32	15	15	26	42	181	126	132	218	199	218	191	204	232	158	213	258	207	156	112	117	102	43		
15-30	11	13	20	27	80	181	120	134	132	243	246	146	180	185	217	212	223	277	205	148	100	126	60	44	
30-45	15	17	19	35	122	127	130	125	128	196	206	147	196	171	215	206	215	249	208	124	107	124	52	41	
45-00	24	13	21	43	149	132	133	202	193	168	149	191	161	166	225	249	233	164	128	83	92	53	29		
TOT	82	58	75	131	393	621	509	391	462	850	819	660	758	721	830	801	900	1017	784	556	402	459	267	157	12703

AM PEAK HOUR 0845 TO 0945 VOLUME 859 AM TOTAL 5051  
 PM PEAK HOUR 0445 TO 0545 VOLUME 1033 PM TOTAL 7652

07/12/19 FRIDAY

	AM HOURS											PM HOURS											DAILY TOTAL	
	12	1	2	3	4	5	6	7	8	9	10	11	12	1	2	3	4	5	6	7	8	9		10
00-15	30	18	14	24	50	166	159																	
15-30	33	20	8	42	70	167	132																	
30-45	35	25	28	27	119	148																		
45-00	21	11	25	39	151	141																		
TOT	119	74	75	132	390	622	291																	1703

AM PEAK HOUR 0445 TO 0545 VOLUME 632 AM TOTAL 1703  
 PM PEAK HOUR 0000 TO 0000 VOLUME 0 PM TOTAL 0

07/08/19 THRU 07/12/19  
 TOTAL HOURS FOR COUNT 88

2 DAYS FACTOR GROUP P5S FACTOR GROUP P5S  
 AVG WEEKDAY VOL 12626 X SEASONAL ADJ. FACTOR 0.9500 = 11995 X AXLE CORR FACTOR 0.9092 = ESTIMATED AVG DAILY TRAFFIC 10906

PEAK HOUR PERCENTAGES: K = 8.18 D = 100.00  
 PEAK HOUR LOCATION : VOLUME = 1033 DATE: 07/11/19 TIME: 04:45 PM