



Interval 60 min. 15 min.
 Binned(CL/SP) Count(volume)
Lane No 1 2

Direction Channel 1 _____
Direction Channel 2 _____
Data Hog # _____

Counter No. 405868 Count ID HPMS
SR 500 RRT/RRQ Q1 00089 MP 0.00
Leg 2 Direction EB OSID _____

Station Description _ ON SR 500 EB ON RAMP FROM NE 15TH AVE

Date	Day	Time	Comments			
9/28/09	2	1137	Manual (1) <u>2</u> (2) _____ Counter (1) <u>2</u> (2)	SET OK	DB/RT	6.6
9/29	3	0756	Manual (1) <u>50</u> (2) _____ Counter (1) <u>50</u> (2)	CHECK OK	DB/RT	6.4
10/01 9/30	4	0950	Manual (1) <u>22</u> (2) _____ Counter (1) <u>22</u> (2)	CHECK OK	DB/RT	6.6
10/02 10/01	5	1118	Manual (1) <u>29</u> (2) _____ Counter (1) <u>29</u> (2)	CHECK OK	DB/RT	6.9
10/03 10/02	6	0740	Manual (1) <u>1</u> (2) _____ Counter (1) <u>1</u> (2)	P/U OK	DB/RT	6.4

Sketch

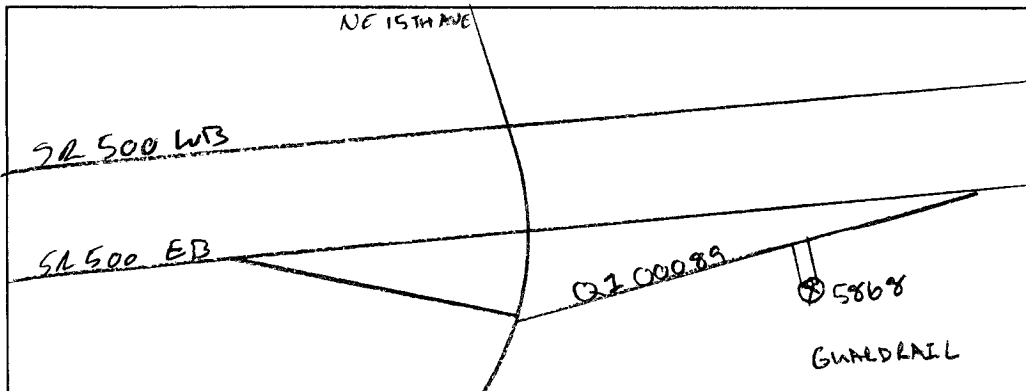

DB/RT
Field Person

SR 500 Q100089 MP 000.00 OFF SYSTEM ID. LEG 2 DIRECTION OF TRAFFIC EASTBOUND LANE ALL OF

COUNT IDENTIFIER HPMS COUNTER NUMBER 405868 DESCRIPTION: ON SR 500 EB ON RAMP FROM NE 15TH AVE

AM HOURS	CARS PICKUPS	BUS	SINGLE MED	UNITS HVY	4+	SINGLE UNIT %	DOUBLE 4-	UNITS 5	6+	DOUBLE UNIT %	5-	TRAINS 6	7+	TRAIN %	TRUCK %	CLASS UNKNOWN	TOTAL VEHICLES
09-28-09																	
MONDAY																	
1 - 1	404	1	14	2		4.0	1	1		.5					4.5		423
2 - 2	421	2	21			5.2	1		1	.4					5.6		446
3 - 3	501		28			5.3	1			.2					5.5		530
4 - 4	521	1	29			5.4	1	1		.4					5.8		553
5 - 5	503	1	44			8.2	1			.2					8.4		549
6 - 6	506	4	13			3.2			1	.2					3.6		525
7 - 7	466	2	10			2.5	1			.3					2.7	1	480
8 - 8	313	1	9			3.1		1		.3					3.4		325
9 - 9	258	1	4			1.9			1	.5					1.9		263
10 - 10	181		8			4.2				.8					4.7		191
11 - 11	120	1	3			3.2	1			.1					4.0		125
12 - 12	88		1			1.1									1.1		89
AM TOTAL	4282	14	184	2		4.4	7	3	3	.3	1				4.8		4499
PM TOTAL	4282	14	184	2		4.4	7	3	3	.3	1				4.8	3	4499
DAY TOTAL	4282	14	184	2		4.4	7	3	3	.3	1				4.8	3	4499
																2-AXLE EQUIVALENT	4519

STATE OF WASHINGTON - DEPARTMENT OF TRANSPORTATION
 TRIP SYSTEM
 HOURLY TRAFFIC CLASSIFICATION SUMMARY

SR 500 Q100089	MP 000.00	OFF SYSTEM ID.	LEG 2	DIRECTION OF TRAFFIC	EASTBOUND	LANE ALL OF												
COUNT IDENTIFIER	HPMS	COUNTER NUMBER	405868	DESCRIPTION: ON SR 500 EB ON RAMP FROM NE 15TH AVE														
09-29-09																		
TUESDAY																		
AM HOURS	CARS PICKUPS	BUS	SINGLE MED	UNITS HYV	4+	SINGLE UNIT %	DOUBLE 4-	5	6+	DOUBLE UNIT %	5-	TRAINS 6	7+	TRAIN %	TRUCK %	CLASS UNKNOWN	TOTAL VEHICLES	
12 - 1	53		4			7.0									7.0		57	
1 - 2	26																26	
2 - 3	26																26	
3 - 4	23		3			11.1											27	
4 - 5	49																27	
5 - 6	126		7			5.2	1										50	
6 - 7	297		8			3.1											134	
7 - 8	587		18			2.6	1										305	
8 - 9	497		50	1		9.4	1		1								607	
9 - 10	389		30			7.1	1		2								552	
10 - 11	368		26			6.5	1		1								423	
11 - 12	436	1	19			4.4			2								398	
PM HOURS																	458	
12 - 1	443		18			4.1	2		1								466	
1 - 2	456	1	24	1		5.3	1		2								486	
2 - 3	537		34	2		6.2	1		2								577	
3 - 4	497		33	1		6.4	1		3								535	
4 - 5	531		46			7.9	1		1								581	
5 - 6	508		16			3.6			2								527	
6 - 7	448	3	8			2.6			1								460	
7 - 8	384	4	12			3.8			2								399	
8 - 9	279	1	9	1		3.8			1								290	
9 - 10	230	1	6			2.5			1								236	
10 - 11	107		4			4.4											113	
11 - 12	101	1	1			1.0											102	
AM TOTAL	2877	3	165	1		5.5	5	6	4								3063	
PM TOTAL	4521	13	211	6		4.8	6	9	6								4772	
DAY TOTAL	7398	16	376	7		5.1	11	15	10								7835	
																		7895

2-AXLE EQUIVALENT

STATE OF WASHINGTON - DEPARTMENT OF TRANSPORTATION
 TRIP SYSTEM
 HOURLY TRAFFIC CLASSIFICATION SUMMARY

SR 500 Q100089	MP 000.00	OFF SYSTEM ID.	LEG 2	DESCRIPTION: ON SR 500 EB ON RAMP FROM NE 15TH AVE	DIRECTION OF TRAFFIC: EASTBOUND	LANE ALL OF							
COUNT IDENTIFIER	HPMS	COUNTER NUMBER	405868										
10-01-09													
THURSDAY													
AM HOURS	CARS PICKUPS	BUS	SINGLE MED	HVY	4+	SINGLE UNIT %	DOUBLE UNITS 4- 5 6+	DOUBLE UNIT %	5- TRAINS 6 7+	TRAIN %	TRUCK %	CLASS UNKNOWN	TOTAL VEHICLES
12 -	43												43
1 -	38												38
2 -	22												22
3 -	22												22
4 -	38		1			4.0							38
5 -	140					2.1							143
6 -	263		3			3.0							271
7 -	533		8			3.6	3	1	2				559
8 -	504		20			8.1	2	3	2	1			556
9 -	427	1	43			10.0	2	3	2				482
10 -	378	2	14			3.8	2	3	1				399
11 -	484		24			4.7	1	1	1				510
PM HOURS													
12 -	475		23			4.6	2	1	2				503
1 -	479	1	28			5.7	1	1	1				512
2 -	543	1	32			5.7	1						578
3 -	582	1	27			4.6	2						613
4 -	568	1	48			7.9	1		1				617
5 -	541	4	9			2.3		1					558
6 -	498	4	11			2.5							511
7 -	376	2	10			2.8		1					388
8 -	262	1	6			2.2			1				270
9 -	163	2	6			2.6							269
10 -	104		3			3.0			1				169
11 -	104	2	1			1.0							105
AM TOTAL	2892	3	158	2	1	5.3	9	13	6				3086
PM TOTAL	4853	13	204	1	1	4.3	7	3	5				5093
DAY TOTAL	7745	16	362	3	1	4.7	16	16	11				8179
												2-AXLE EQUIVALENT	8251

STATE OF WASHINGTON - DEPARTMENT OF TRANSPORTATION
TRIP SYSTEM
HOURLY TRAFFIC CLASSIFICATION SUMMARY

SR 500 Q100089 MP 000.00 OFF SYSTEM ID. LEG 2 DIRECTION OF TRAFFIC EASTBOUND LANE ALL OF

COUNT IDENTIFIER HPMS COUNTER NUMBER 405868 DESCRIPTION: ON SR 500 EB ON RAMP FROM NE 15TH AVE

FRIDAY AM HOURS	CARS PICKUPS	BUS	SINGLE MED	UNITS HVY	4+	SINGLE UNIT %	DOUBLE UNITS	4-	5	6+	DOUBLE UNIT %	5-	6	7+	TRAIN %	TRUCK %	CLASS UNKNOWN	TOTAL VEHICLES
12 - 1	53		1	6		1.9										1.9		54
11 - 2	41					12.8										12.8		47
10 - 3	22									1	4.3					4.3		23
9 - 4	32					3.0										3.0		33
8 - 5	39					2.4				1	2.4					4.9		41
7 - 6	116					4.1				2	1.6					5.7		123
6 - 7	278					3.1				1	1.0					4.1		290
5 - 8																		
4 - 9																		
3 - 10																		
2 - 11																		
1 - 12																		
PM HOURS																		
12 - 1																		
11 - 2																		
10 - 3																		
9 - 4																		
8 - 5																		
7 - 6																		
6 - 7																		
5 - 8																		
4 - 9																		
3 - 10																		
2 - 11																		
1 - 12																		
AM TOTAL	581		1	22		3.8		3	3	1	1.1					4.9		611
PM TOTAL																		
DAY TOTAL	581		1	22		3.8		3	3	1	1.1					4.9		611

09-28-09 THRU 10-02-09

AVERAGE WEEKDAY CLASSIFICATION VOLUMES *****

CARS PICKUPS	BUS	SINGLE MED	UNITS HVY	4+	SINGLE UNIT %	DOUBLE UNITS	4-	5	6+	DOUBLE UNIT %	5-	6	7+	TRAIN %	TRUCK %	CLASS UNKNOWN	TOTAL VEHICLES
7491		17	366	5	1	4.9		16	13	8	.5		1				7922
TOTAL HOURS FOR COUNT 91																	
3 DAYS																	
AVG WEEKDAY VOL 7922 X SEASONAL ADJ. FACTOR 0.9200 = ESTIMATED AVG DAILY TRAFFIC 7288																	
AWD 2-AXLE EQUIVALENT 4																	

PEAK HOUR PERCENTAGES: K = 7.79 D = 100.00 T = 7.94
PEAK HOUR LOCATION : VOLUME = 617 DATE: 10/01/09 TIME: 04:00 PM