

# Roadway Survey Field Sheet

TS Project # \_\_\_\_\_ Map \_\_\_\_\_ Grid \_\_\_\_\_ Start Time **11:30** # Of Days **3**

Location: **NE 49TH ST @ NE 137TH AVE**  
 City: **VANCOUVER**  
 Location ID: **#17**

Type Of Survey:  
 Volume  
 Speed  
 Classification

Start Date: **3/24/14** Counters **4**  
 End Date: **3/26/14** Tubes **8**

SITE EVALUATION			POSTED SPEED		DWELL TIME																																									
Vehicles Crossing Tube Perpendicular	<input checked="" type="checkbox"/> YES	<input type="checkbox"/> NO	<input type="checkbox"/> ???	<input type="checkbox"/> None	<input type="checkbox"/> 40 Mph	<table border="1"> <thead> <tr> <th>LOWEST SPEED</th> <th colspan="5">HIGHEST SPEED</th> <th>(TAD, TBD)</th> </tr> <tr> <th>MPH</th> <th>10-20</th> <th>15-30</th> <th>25-40</th> <th>35-45</th> <th>&gt; 45</th> <th></th> </tr> </thead> <tbody> <tr> <td>Standing Queue</td> <td>200</td> <td>130</td> <td>100</td> <td>80</td> <td>40</td> <td><b>A</b></td> </tr> <tr> <td>5 - 10 MPH</td> <td>130</td> <td>90</td> <td>70</td> <td>60</td> <td>40</td> <td><b>B</b></td> </tr> <tr> <td>&gt; 10 MPH</td> <td>100</td> <td>80</td> <td>60</td> <td>40</td> <td>40</td> <td><b>M</b></td> </tr> </tbody> </table>						LOWEST SPEED	HIGHEST SPEED					(TAD, TBD)	MPH	10-20	15-30	25-40	35-45	> 45		Standing Queue	200	130	100	80	40	<b>A</b>	5 - 10 MPH	130	90	70	60	40	<b>B</b>	> 10 MPH	100	80	60	40	40	<b>M</b>
LOWEST SPEED	HIGHEST SPEED					(TAD, TBD)																																								
MPH	10-20	15-30	25-40	35-45	> 45																																									
Standing Queue	200	130	100	80	40	<b>A</b>																																								
5 - 10 MPH	130	90	70	60	40	<b>B</b>																																								
> 10 MPH	100	80	60	40	40	<b>M</b>																																								
Do You Anticipate Queing Across Tube	<input type="checkbox"/>	<input checked="" type="checkbox"/>	<input type="checkbox"/>	<input type="checkbox"/> 25 Mph	<input type="checkbox"/> 45 Mph	DWELL (TAD, TBD) <b>60</b>																																								
Speed Greater Than 20 Miles / Hour	<input type="checkbox"/>	<input checked="" type="checkbox"/>	<input type="checkbox"/>	<input checked="" type="checkbox"/> 30 Mph	<input type="checkbox"/> 50 Mph	Use 2 Counters if Traffic Conditions are different in each direction.																																								
Tube Crosses More Than 2 Lanes	<input checked="" type="checkbox"/>	<input type="checkbox"/>	<input type="checkbox"/>	<input type="checkbox"/> 35 Mph	<input type="checkbox"/> 55 Mph																																									
SPEED: High _____ Mph Low _____ Mph			<input type="checkbox"/> Other: _____																																											

AXLE STRIKE COUNT	SYSTEM DELAY LOGIC	SPEED LOW VOL	VEHICLE SPEED / CLASSIFICATION			
<b>G M D A B</b>	<b>D</b>	<b>G M B</b>	<b>M B</b>	<b>G</b>	<b>L</b>	
<input type="checkbox"/> Tube equal length <input type="checkbox"/> Use proper spacing <input type="checkbox"/> One Lane only except Low Volume Speed Surveys ADT 2,000						

COUNTER / SET DOWN

Type: **MC**

No.: **25, 34, 51, 26**

Box: \_\_\_\_\_

Tube Length: **40'**

Hammer Test

CHECK	DATE	TIME
P F		
P F		
P F		
P F		
P F		

PICK-UP

Hammer Test

Date: \_\_\_\_\_ Time: \_\_\_\_\_

FILE NAMES

**26 VANM 25**

**26 VANM 34**

~~26 VANM 51~~

~~26 VANM 26~~

**26 VANM 51**

DIRECTION:  East Bound  West Bound  North Bound  South Bound  Approach

COMBINED:  East / West  North / South DRWY:  Combined  In-Bound  Out-Bound

ROAD:  Dry  Wet  Asphalt  Concrete  Broken  Rutted  Curved

REDUNDANT SET-UP

Remarks: WEATHER:  Sunny  Overcast  Rain  Snow

Surveyed By: **MS**

**TRAFFIC SMITHY**  
 1225 NW Murray Blvd. Suite 111  
 Portland, OR 97229  
 Phone: 503/641-6333 - Fax: 503/643-8866

**TRAFFIC SMITHY, INC**

1225 NW MURRAY BLVD

PORTLAND, OR 97209

Phone: 503-641-6333 Fax: 503-643-8866

Roadway: NE 49TH STREET

Location: EAST OF NE 137TH AVENUE

Date: 03/25/04

Day of Week: Thursday

## EB Traffic

TIME	:00	:05	:10	:15	:20	:25	:30	:35	:40	:45	:50	:55	Total
00:00	3	4	2	2	1	3	2	1	2	2	1	1	24
01:00	0	2	2	1	2	0	0	2	1	2	1	1	14
02:00	0	0	0	1	0	1	1	0	0	0	1	4	8
03:00	1	1	1	1	1	1	0	1	2	1	2	1	13
04:00	1	2	1	0	3	0	0	1	1	1	0	3	13
05:00	0	1	0	1	0	5	2	1	6	1	2	6	25
06:00	1	1	1	1	1	3	3	5	4	5	7	10	42
07:00	6	3	5	7	14	10	10	12	15	10	18	16	126
08:00	11	8	9	15	14	11	14	14	15	4	8	5	128
09:00	9	8	9	8	8	8	6	11	7	11	13	8	106
10:00	8	9	2	8	13	7	12	7	10	12	11	12	111
11:00	16	13	12	13	22	14	12	10	12	12	8	19	163
12:00	9	16	10	22	11	18	11	17	14	11	13	19	171
13:00	16	12	8	15	16	18	8	11	14	8	7	13	146
14:00	12	12	15	17	21	21	13	9	13	24	28	23	208
15:00	15	27	18	27	22	19	21	18	19	22	22	32	262
16:00	27	26	19	28	21	29	24	33	23	24	35	30	319
17:00	19	31	18	30	22	33	27	23	27	24	26	28	308
18:00	25	19	25	25	30	29	27	22	14	25	30	21	292
19:00	19	27	20	21	23	9	21	10	15	13	16	10	204
20:00	16	13	8	11	17	14	15	20	19	12	11	13	169
21:00	9	17	14	12	26	9	16	8	12	4	10	5	142
22:00	9	5	13	7	13	12	4	2	4	6	5	4	84
23:00	6	6	7	3	1	3	2	4	0	5	1	3	41

Daily Total: 3119

AM Peak Hour: 163 (11:00 - 12:00)

5.22% Of Daily Total

PM Peak Hour: 325 (16:35 - 17:35)

10.4% Of Daily Total

4th Highest Hour: 262 (15:00 - 16:00)

8.40% Of Daily Total

8th Highest Hour: 169 (20:00 - 21:00)

5.41% Of Daily Total

**TRAFFIC SMITHY, INC**

1225 NW MURRAY BLVD

PORTLAND, OR 97209

Phone: 503-641-6333 Fax: 503-643-8866

Roadway: NE 49TH STREET  
 Location: EAST OF NE 137TH AVENUE

Date: 03/25/04  
 Day of Week: Thursday

WB Traffic

TIME	:00	:05	:10	:15	:20	:25	:30	:35	:40	:45	:50	:55	Total
00:00	0	0	1	1	1	0	2	4	2	1	0	0	12
01:00	0	0	0	2	1	0	2	1	2	1	1	1	11
02:00	0	0	1	0	1	2	1	1	1	0	1	1	9
03:00	0	1	0	1	1	1	0	0	1	1	3	2	11
04:00	2	3	5	1	3	2	4	3	3	7	3	8	44
05:00	5	5	9	7	6	14	15	8	9	15	8	22	123
06:00	18	11	23	18	13	19	19	26	22	22	13	24	228
07:00	31	33	32	22	35	23	26	21	21	22	15	18	299
08:00	16	15	17	19	21	19	27	31	20	27	13	17	242
09:00	15	9	12	14	10	11	16	18	12	10	9	12	148
10:00	11	10	11	9	13	4	9	20	13	8	14	10	132
11:00	14	8	9	12	10	11	25	13	12	12	17	13	156
12:00	13	11	15	16	19	7	14	9	9	18	15	11	157
13:00	14	10	6	6	8	10	8	5	13	13	14	4	111
14:00	22	15	15	18	14	12	13	12	10	19	17	19	186
15:00	28	25	21	28	23	15	24	22	19	21	17	20	263
16:00	22	11	12	14	18	19	15	21	23	17	18	23	213
17:00	19	24	23	22	18	19	15	23	26	22	17	21	249
18:00	9	14	19	16	12	13	15	19	16	16	11	10	170
19:00	12	11	10	10	8	13	6	11	9	5	13	5	113
20:00	4	6	6	5	14	5	9	6	9	9	14	3	90
21:00	9	6	10	7	9	4	4	6	4	6	7	5	77
22:00	8	8	4	2	6	1	4	3	3	4	3	0	46
23:00	5	5	2	5	1	0	1	2	2	0	1	2	26

Daily Total: 3116

AM Peak Hour: 309 (06:35 - 07:35)

9.91% Of Daily Total

PM Peak Hour: 263 (15:00 - 16:00)

8.44% Of Daily Total

4th Highest Hour: 242 (08:00 - 09:00)

7.76% Of Daily Total

8th Highest Hour: 170 (18:00 - 19:00)

5.45% Of Daily Total

**TRAFFIC SMITHY, INC**  
 1225 NW MURRAY BLVD  
 PORTLAND, OR 97209  
 Phone: 503-641-6333 Fax: 503-643-8866

Roadway: NE 137TH AVENUE  
 Location: SOUTH OF NE 49TH STREET

Date: 03/25/04  
 Day of Week: Thursday

SB Traffic

TIME	:00	:05	:10	:15	:20	:25	:30	:35	:40	:45	:50	:55	Total
00:00	5	4	4	6	6	3	2	3	3	3	3	0	42
01:00	2	1	3	3	1	3	2	1	2	1	0	1	20
02:00	1	3	1	1	3	4	4	1	2	0	2	1	23
03:00	0	2	1	2	3	2	0	1	3	2	1	3	20
04:00	1	1	3	2	3	-1	3	2	6	2	0	7	29
05:00	4	8	7	7	6	11	7	14	14	16	16	4	114
06:00	16	19	18	28	19	27	26	29	34	28	25	25	294
07:00	36	34	31	38	41	45	48	33	30	33	29	31	429
08:00	23	37	34	46	33	28	28	49	36	36	33	34	417
09:00	25	24	26	22	32	21	22	29	21	17	21	34	294
10:00	28	26	18	10	27	15	30	39	40	28	32	20	313
11:00	45	33	30	30	35	27	49	26	44	31	37	27	414
12:00	37	21	34	34	36	27	35	21	31	28	45	29	378
13:00	33	27	34	34	25	36	26	37	36	25	38	29	380
14:00	25	33	31	38	43	35	37	39	40	40	49	44	454
15:00	44	39	36	39	42	40	42	48	55	47	40	41	513
16:00	44	42	50	46	36	33	42	43	45	45	32	31	489
17:00	39	37	39	44	38	40	39	40	46	34	35	39	470
18:00	41	60	40	47	44	37	38	44	35	32	29	23	470
19:00	26	33	33	33	35	23	17	25	26	22	18	24	315
20:00	25	20	21	21	19	24	27	26	10	17	21	18	249
21:00	24	19	12	18	14	23	15	17	14	11	21	12	200
22:00	16	17	13	17	11	9	12	11	9	8	9	3	135
23:00	6	6	8	6	2	6	8	3	7	7	3	2	64

Daily Total: 6526

AM Peak Hour: 430 (07:20 - 08:20)

6.58% Of Daily Total

PM Peak Hour: 537 (15:20 - 16:20)

8.22% Of Daily Total

4th Highest Hour: 470 (18:00 - 19:00)

7.20% Of Daily Total

8th Highest Hour: 414 (11:00 - 12:00)

6.34% Of Daily Total

**TRAFFIC SMITHY, INC**

1225 NW MURRAY BLVD

PORTLAND, OR 97209

Phone: 503-641-6333 Fax: 503-643-8866

Roadway: NE 137TH AVENUE

Location: SOUTH OF NE 49TH STREET

Date: 03/25/04

Day of Week: Thursday

## NB Traffic

TIME	:00	:05	:10	:15	:20	:25	:30	:35	:40	:45	:50	:55	Total
00:00	2	2	4	5	1	7	3	6	6	5	2	3	46
01:00	1	0	2	0	3	2	3	0	0	3	1	1	16
02:00	1	2	1	1	3	1	5	1	2	2	1	0	20
03:00	4	1	2	2	4	2	1	0	1	3	5	1	26
04:00	3	0	2	3	1	5	4	3	6	6	3	5	41
05:00	7	5	11	10	13	14	5	15	18	17	14	15	144
06:00	23	20	21	15	21	28	28	40	36	33	34	29	328
07:00	35	25	48	39	28	33	30	38	45	37	50	33	441
08:00	32	31	30	28	25	27	28	18	28	41	26	31	345
09:00	17	24	31	25	29	26	34	32	28	35	45	39	365
10:00	35	44	20	28	33	25	34	34	31	30	36	37	387
11:00	31	25	40	36	28	36	33	40	27	42	54	36	428
12:00	33	41	30	35	36	37	33	44	26	37	33	28	413
13:00	25	33	32	39	41	44	43	45	40	41	42	51	476
14:00	47	44	52	48	40	45	29	40	41	39	32	31	488
15:00	36	40	51	33	37	48	51	44	40	39	41	38	498
16:00	51	48	38	45	56	47	52	50	49	48	51	51	586
17:00	55	43	50	40	51	37	49	37	43	43	49	32	529
18:00	28	42	36	46	40	43	36	29	28	42	41	30	441
19:00	20	30	33	32	26	37	31	21	17	16	29	28	320
20:00	20	25	23	23	19	13	26	29	45	24	21	14	282
21:00	26	17	26	27	24	13	13	13	19	14	14	8	214
22:00	13	14	6	16	16	20	22	6	6	8	12	3	142
23:00	7	4	7	7	7	5	3	5	4	4	7	4	64

Daily Total: 7040

AM Peak Hour: 444 (07:10 - 08:10)

6.30% Of Daily Total

PM Peak Hour: 597 (16:15 - 17:15)

8.48% Of Daily Total

4th Highest Hour: 488 (14:00 - 15:00)

6.93% Of Daily Total

8th Highest Hour: 428 (11:00 - 12:00)

6.07% Of Daily Total

# Roadway Survey Field Sheet

TS Project # 04-108 Map - Grid - Start Time 11:00 # Of Days 3

Location: NE 49TH @ NE 137TH  
 Location ID: LOC 17 City: VANCOUVER

Type Of Survey  
 Volume  
 Speed  
 Classification

Start Date: 3/30/14 Counters 2  
 S M T W T F S  
 End Date: 4/1/14 Tubes 4  
 S M T W T F S

SITE EVALUATION			POSTED SPEED		DWELL TIME																																			
Vehicles Crossing Tube Perpendicular	<input checked="" type="checkbox"/> YES	<input type="checkbox"/> NO	<input type="checkbox"/> None	<input type="checkbox"/> 40 Mph	<table border="1"> <thead> <tr> <th>LOWEST SPEED</th> <th colspan="5">HIGHEST SPEED</th> </tr> <tr> <th>MPH</th> <th>10-20</th> <th>15-30</th> <th>25-40</th> <th>35-45</th> <th>&gt; 45</th> </tr> </thead> <tbody> <tr> <td>Standing Queue</td> <td>200</td> <td>130</td> <td>100</td> <td>80</td> <td>40</td> </tr> <tr> <td>5 - 10 MPH</td> <td>130</td> <td>90</td> <td>70</td> <td>60</td> <td>40</td> </tr> <tr> <td>&gt; 10 MPH</td> <td>100</td> <td>80</td> <td>60</td> <td>40</td> <td>40</td> </tr> </tbody> </table>						LOWEST SPEED	HIGHEST SPEED					MPH	10-20	15-30	25-40	35-45	> 45	Standing Queue	200	130	100	80	40	5 - 10 MPH	130	90	70	60	40	> 10 MPH	100	80	60	40	40
LOWEST SPEED	HIGHEST SPEED																																							
MPH	10-20	15-30	25-40	35-45	> 45																																			
Standing Queue	200	130	100	80	40																																			
5 - 10 MPH	130	90	70	60	40																																			
> 10 MPH	100	80	60	40	40																																			
Do You Anticipate Queuing Across Tube	<input type="checkbox"/>	<input type="checkbox"/>	<input type="checkbox"/> 25 Mph	<input type="checkbox"/> 45 Mph	(TAD, TBD)																																			
Speed Greater Than 20 Miles / Hour	<input checked="" type="checkbox"/>	<input type="checkbox"/>	<input type="checkbox"/> 30 Mph	<input type="checkbox"/> 50 Mph	A																																			
Tube Crosses More Than 2 Lanes	<input checked="" type="checkbox"/>	<input type="checkbox"/>	<input checked="" type="checkbox"/> 35 Mph	<input type="checkbox"/> 55 Mph	B																																			
SPEED: High _____ Mph Low _____ Mph			<input type="checkbox"/> Other: _____	Use 2 Counters if Traffic Conditions are different in each direction.																																				
				DWELL (TAD, TBD) <u>60</u>																																				

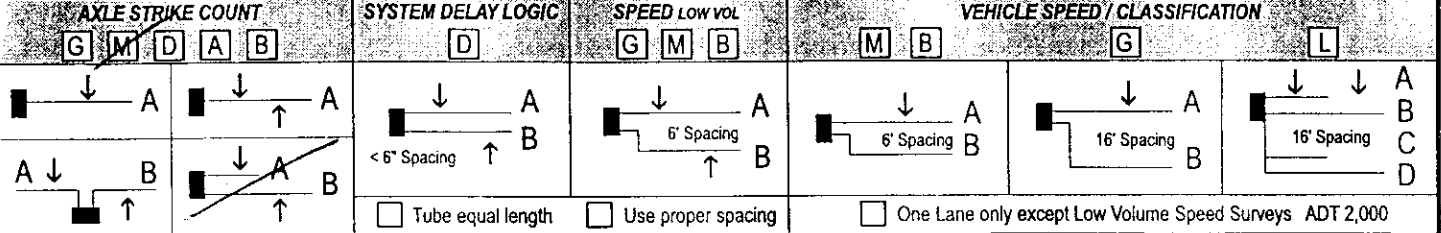

**COUNTER / SET DOWN**

Type: MC

No.: 77, 70

Box: \_\_\_\_\_

Tube Length: 40'

Hammer Test

CHECK	DATE	TIME
P F		
P F		
P F		
P F		
P F		

**PICK-UP**

Hammer Test

Date: 3/1/14 Time: \_\_\_\_\_

**FILE NAMES**

013777

70

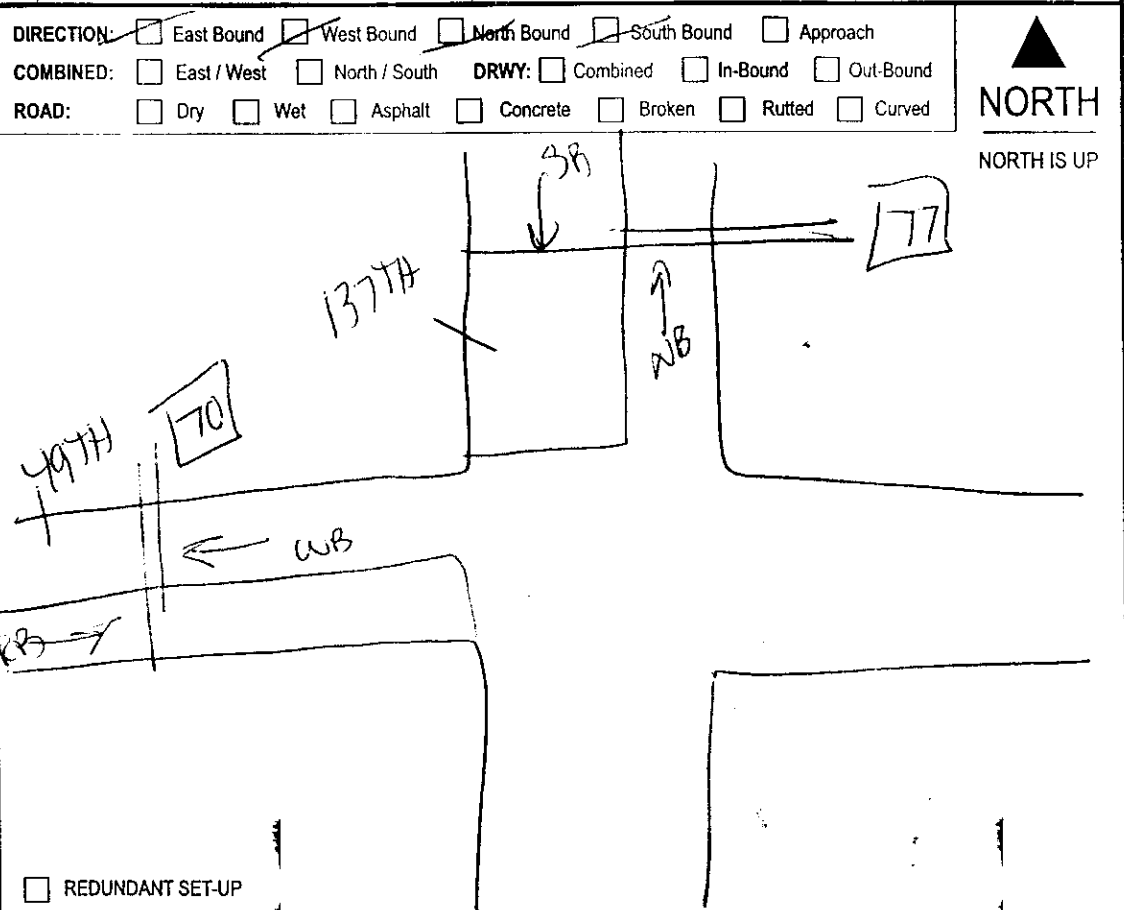

Remarks: \_\_\_\_\_ WEATHER:  Sunny  Overcast  Rain  Snow

Surveyed By: me

**TRAFFIC SMITHY, Inc.**  
 1225 NW Murray Blvd. Suite 111  
 Portland, OR 97229  
 Phone: 503/641-6333 - Fax: 503/643-8866

**TRAFFIC SMITHY, INC**

626- 120TH AVENUE NE SUITE B102

BELLEVUE, WA 98005

PHONE- 425-688-7888 FAX- 425-688-7784

oadway: NE 137TH AVENUE  
 Location: NORTH OF NE 49TH STREET

Date: 03/31/04

Day of Week: Wednesday

## SB Traffic

TIME	:00	:05	:10	:15	:20	:25	:30	:35	:40	:45	:50	:55	Total
00:00	3	4	6	3	3	1	2	0	1	0	2	1	26
01:00	1	0	0	1	0	1	0	2	2	0	5	1	13
02:00	1	4	1	1	1	4	0	3	1	1	1	2	20
03:00	0	0	2	2	1	1	1	1	1	1	2	0	12
04:00	0	0	3	0	3	2	4	1	6	1	4	1	25
05:00	1	2	4	5	7	10	7	10	8	22	8	16	100
06:00	13	15	20	16	13	22	19	19	24	35	34	20	250
07:00	18	24	42	34	38	45	33	43	43	33	45	26	424
08:00	20	23	30	34	29	24	35	40	36	29	38	29	367
09:00	30	29	17	32	30	20	17	29	30	29	14	3	280
10:00	27	30	21	23	21	19	38	17	33	32	31	41	333
11:00	28	33	28	25	20	22	25	27	26	30	33	13	310
12:00	43	18	25	28	36	14	44	10	37	38	12	28	333
13:00	30	27	25	27	32	22	28	40	26	20	22	36	335
14:00	34	31	26	32	38	11	16	39	27	34	31	48	367
15:00	35	25	38	42	37	30	47	36	41	44	47	38	460
16:00	43	37	47	47	39	51	41	25	33	47	37	34	481
17:00	38	36	35	46	43	39	40	47	49	39	26	41	479
18:00	42	36	41	40	40	32	29	39	47	31	33	29	439
19:00	31	32	29	32	27	18	30	16	28	8	21	24	296
20:00	28	30	36	30	30	40	32	31	35	22	28	28	370
21:00	49	19	32	33	34	19	22	23	18	19	19	14	301
22:00	21	16	21	12	11	8	20	10	6	12	15	6	158
23:00	9	11	9	5	6	12	6	6	5	7	4	7	87

Daily Total: 6266

AM Peak Hour: 426 (07:05 - 08:05)

PM Peak Hour: 517 (15:30 - 16:30)

4th Highest Hour: 439 (18:00 - 19:00)

8th Highest Hour: 367 (14:00 - 15:00)

6.79% Of Daily Total

8.25% Of Daily Total

7.00% Of Daily Total

5.85% Of Daily Total

**TRAFFIC SMITHY, INC**  
 626- 120TH AVENUE NE SUITE B102  
 BELLEVUE, WA 98005  
 PHONE- 425-688-7888 FAX- 425-688-7784

roadway: NE 137TH AVENUE  
 Location: NORTH OF NE 49TH STREET

Date: 03/31/04  
 Day of Week: Wednesday

NB Traffic

TIME	:00	:05	:10	:15	:20	:25	:30	:35	:40	:45	:50	:55	Total
00:00	2	3	1	1	1	2	2	7	4	1	3	3	30
01:00	1	2	3	3	0	3	5	3	0	6	2	0	28
02:00	1	2	1	2	0	4	0	1	0	2	1	1	15
03:00	2	0	1	1	0	0	2	0	4	0	4	0	14
04:00	1	2	1	1	0	4	1	5	3	5	2	4	29
05:00	5	6	3	3	7	5	10	9	9	12	16	18	103
06:00	11	8	23	16	20	13	19	28	25	24	29	34	250
07:00	39	33	38	21	32	37	31	35	39	32	23	26	386
08:00	20	25	26	19	30	25	29	38	29	37	31	25	334
09:00	18	29	24	17	22	30	31	30	24	25	16	24	290
10:00	22	21	32	25	37	27	17	31	18	22	17	30	299
11:00	31	16	20	24	32	36	36	31	34	24	33	30	347
12:00	28	32	22	29	16	25	27	24	34	30	23	21	311
13:00	18	27	31	26	22	39	29	25	34	35	31	31	348
14:00	26	32	30	34	32	32	26	37	28	41	39	24	381
15:00	39	31	28	32	34	40	52	39	30	52	32	41	450
16:00	43	36	36	38	44	45	35	49	47	45	51	39	508
17:00	45	42	49	40	51	37	35	37	39	40	38	36	489
18:00	32	32	45	36	44	41	47	37	28	39	47	22	450
19:00	32	27	29	22	30	23	20	34	22	20	22	21	302
20:00	26	19	17	23	16	24	22	24	27	20	25	18	261
21:00	22	20	12	16	19	19	19	19	11	13	14	12	196
22:00	12	13	7	5	11	10	15	9	5	7	9	9	112
23:00	6	6	3	6	6	3	6	3	5	4	2	5	55

Daily Total: 5988

AM Peak Hour: 400 (06:50 - 07:50)

PM Peak Hour: 538 (16:25 - 17:25)

4th Highest Hour: 450 (18:00 - 19:00)

8th Highest Hour: 347 (11:00 - 12:00)

6.68% Of Daily Total

8.98% Of Daily Total

7.51% Of Daily Total

5.79% Of Daily Total



**TRAFFIC SMITHY, INC**  
 626- 120TH AVENUE NE SUITE B102  
 BELLEVUE, WA 98005  
 PHONE- 425-688-7888 FAX- 425-688-7784

roadway: NE 49TH STREET  
 Location: WEST OF 137TH AVENUE

Date: 03/31/04  
 Day of Week: Wednesday

EB Traffic

TIME	:00	:05	:10	:15	:20	:25	:30	:35	:40	:45	:50	:55	Total
00:00	5	1	1	1	1	0	2	5	2	5	3	3	29
01:00	1	4	1	2	1	0	1	2	1	2	3	0	18
02:00	4	1	3	1	0	2	0	2	1	3	1	1	19
03:00	1	3	1	4	0	0	0	0	2	1	0	0	12
04:00	0	0	2	1	0	4	3	1	3	0	0	1	15
05:00	3	3	3	3	4	4	6	3	1	1	5	6	42
06:00	1	6	4	7	9	4	6	12	6	11	8	10	84
07:00	13	7	13	9	18	15	8	8	11	14	11	6	133
08:00	10	11	9	10	19	9	11	6	6	11	7	8	117
09:00	8	6	14	8	5	7	4	5	10	15	14	12	108
10:00	10	7	8	11	14	12	11	17	13	15	11	16	145
11:00	12	8	17	11	15	21	19	12	10	14	12	21	172
12:00	13	18	32	19	18	17	21	21	16	10	17	16	218
13:00	17	19	13	18	14	19	15	9	9	9	15	10	167
14:00	15	18	15	18	30	26	24	27	26	18	19	28	264
15:00	19	24	27	12	30	34	16	23	23	24	23	33	288
16:00	41	28	30	24	33	25	29	35	23	23	20	36	347
17:00	35	30	26	35	26	28	30	37	21	27	35	29	359
18:00	31	24	23	23	32	33	25	25	24	18	21	18	297
19:00	20	21	16	19	12	27	19	25	15	15	18	23	230
20:00	17	14	13	9	9	11	12	12	10	7	13	17	144
21:00	13	12	7	8	10	8	11	5	6	6	6	7	99
22:00	7	12	2	4	8	9	8	6	1	6	6	4	73
23:00	4	0	5	7	0	2	2	6	2	7	2	4	41

Daily Total: 3421

AM Peak Hour: 175 (10:35 - 11:35)

5.11% Of Daily Total

PM Peak Hour: 366 (16:55 - 17:55)

10.6% Of Daily Total

4th Highest Hour: 288 (15:00 - 16:00)

8.41% Of Daily Total

8th Highest Hour: 172 (11:00 - 12:00)

5.02% Of Daily Total

**TRAFFIC SMITHY, INC**  
 626- 120TH AVENUE NE SUITE B102  
 BELLEVUE, WA 98005  
 PHONE- 425-688-7888 FAX- 425-688-7784

Roadway: NE 49TH STREET  
 Location: WEST OF 137TH AVENUE

Date: 03/31/04  
 Day of Week: Wednesday

WB Traffic

TIME	:00	:05	:10	:15	:20	:25	:30	:35	:40	:45	:50	:55	Total
00:00	3	4	1	4	4	5	1	2	1	2	2	4	33
01:00	0	1	2	2	2	0	0	0	1	1	0	0	9
02:00	0	2	2	1	0	2	1	1	4	1	3	0	17
03:00	2	1	2	0	2	4	1	0	5	1	5	2	25
04:00	4	1	7	2	2	2	7	4	6	6	3	3	47
05:00	1	8	11	15	11	16	10	11	20	11	18	16	148
06:00	24	16	17	17	32	29	37	33	38	22	26	23	314
07:00	34	31	31	29	38	31	30	35	29	29	33	28	378
08:00	21	22	31	25	16	23	26	27	37	24	19	19	290
09:00	23	19	13	20	17	19	13	15	13	21	18	13	204
10:00	34	13	18	14	13	7	15	19	21	15	15	16	200
11:00	24	20	16	18	19	14	21	15	13	22	15	20	217
12:00	22	28	20	21	33	21	17	17	19	16	12	16	242
13:00	15	23	15	16	28	21	32	14	19	13	12	12	220
14:00	23	21	21	15	19	24	32	22	19	24	22	17	259
15:00	26	26	16	29	23	22	11	22	19	19	14	12	239
16:00	19	23	19	17	16	25	19	22	17	24	19	21	241
17:00	29	17	27	25	22	25	21	19	22	27	19	23	276
18:00	20	30	22	25	23	19	22	19	26	33	27	20	286
19:00	28	12	12	21	15	15	15	16	16	9	16	19	194
20:00	14	18	9	6	15	8	11	12	10	20	12	9	144
21:00	12	8	11	12	9	7	16	12	2	7	6	11	113
22:00	9	7	7	8	7	6	4	6	9	4	4	2	73
23:00	3	3	4	0	5	4	4	1	3	0	2	4	33

Daily Total: 4202

AM Peak Hour: 378 (07:00 - 08:00)

PM Peak Hour: 294 (18:05 - 19:05)

4th Highest Hour: 286 (18:00 - 19:00)

8th Highest Hour: 241 (16:00 - 17:00)

8.99% Of Daily Total

6.99% Of Daily Total

6.80% Of Daily Total

5.73% Of Daily Total