

Interval 60 min. 15 min.
 Binned(CL/SP) Count(volume)
Lane No 1 2

Direction Channel 1 _____
Direction Channel 2 _____
Data Hog # _____ Site #23W - _____

Counter No. 175877 Court ID SP#10-003
SR 205 RRT/RRQ _____ MP 36.75
Leg W Direction WB OSID D

Station Description ON NE 17TH ~~X~~ W/O NE 20TH AVE

Date	Day	Time	Comments	
4/19/10	Mon	1141	AM Manual (1) <u>5</u> (2) _____ Counter (1) <u>5</u> (2) _____	6.5 PM Manual (1) (2) _____ Counter (1) (2) _____
4/20/10	Tue	0925	AM Manual (1) <u>4</u> (2) _____ Counter (1) <u>4</u> (2) _____	6.6 PM Manual (1) (2) _____ Counter (1) (2) _____
4/21/10	Wed	0918	AM Manual (1) <u>1</u> (2) _____ Counter (1) <u>1</u> (2) _____	6.8 PM Manual (1) (2) _____ Counter (1) (2) _____
4/22/10	Thu	0759	AM Manual (1) <u>1</u> (2) _____ Counter (1) <u>1</u> (2) _____	6.5
			Manual (1) (2) _____ Counter (1) (2) _____	

Sketch

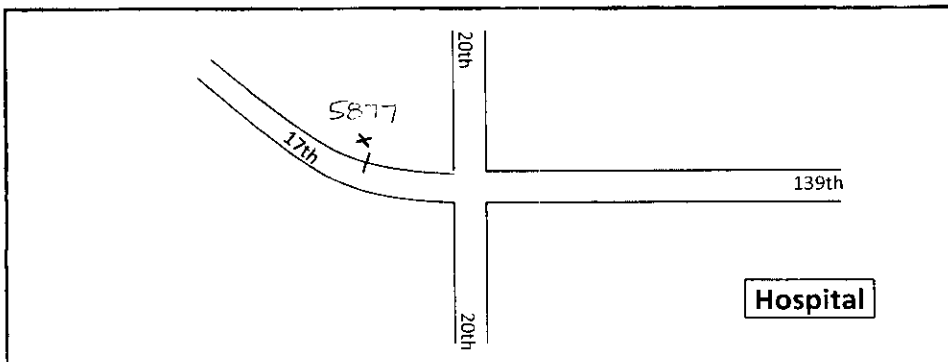

R. Hamrick
Field Person



Washington State
Department of Transportation

Diamond Traffic Counter

Interval 60 min. 15 min.
 Binned(CL/SP) Count(volume)
Lane No 1 2

Direction Channel 1 _____
Direction Channel 2 _____
Data Hog # _____ Site #23E - _____

Counter No. 172314 Count ID SP#10-003
SR 205 RRT/RRQ _____ MP 36.75
Leg W Direction EB OSID D

Station Description _ ON NE 17TH ~~ST~~ ^{AVE} W/O NE 20TH AVE

Date	Day	Time	Comments	
4/19/10	Mon	1143	AM Manual (1) <u>5</u> (2) _____ Counter (1) <u>5</u> (2) _____	6.5 PM Manual (1) _____ (2) _____ Counter (1) _____ (2) _____
4/20/10	Tue	0930	AM Manual (1) <u>4</u> (2) _____ Counter (1) <u>4</u> (2) _____	6.7 PM Manual (1) _____ (2) _____ Counter (1) _____ (2) _____
4/21/10	Wed	0921	AM Manual (1) <u>1</u> (2) _____ Counter (1) <u>1</u> (2) _____	7.0 PM Manual (1) _____ (2) _____ Counter (1) _____ (2) _____
4/22/10	Thu	0801	AM Manual (1) <u>1</u> (2) _____ Counter (1) <u>1</u> (2) _____	6.6 PM Manual (1) _____ (2) _____ Counter (1) _____ (2) _____
			Manual (1) _____ (2) _____ Counter (1) _____ (2) _____	

Sketch

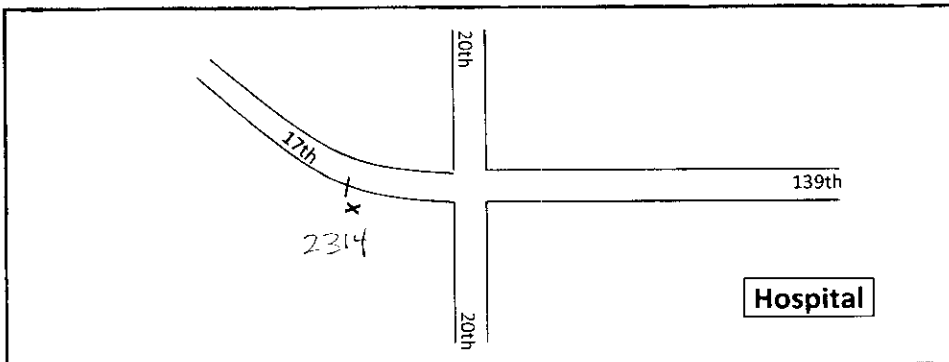

North

R. Hamrick

Field Person

SR 205 MP 036.75 OFF SYSTEM ID. D LEG W DIRECTION OF TRAFFIC WESTBOUND LANE ALL OF

COUNT IDENTIFIER 10-003 COUNTER NUMBER 175877 DESCRIPTION: ON NE 17TH AVE W/O NE 20TH AVE

04/19/10	MONDAY	AM HOURS	PM HOURS	AM TOTAL	PM TOTAL	DAILY TOTAL						
12	1	2	3	4	5	6	7	8	9	10	11	12
1	2	3	4	5	6	7	8	9	10	11	12	TOTAL
00-15												
15-30												
30-45												
45-00												
HOUR												
TOT												

04/20/10	TUESDAY	AM HOURS	PM HOURS	AM TOTAL	PM TOTAL	DAILY TOTAL						
12	1	2	3	4	5	6	7	8	9	10	11	12
1	2	3	4	5	6	7	8	9	10	11	12	TOTAL
00-15												
15-30												
30-45												
45-00												
HOUR												
TOT												

04/21/10	WEDNESDAY	AM HOURS	PM HOURS	AM TOTAL	PM TOTAL	DAILY TOTAL						
12	1	2	3	4	5	6	7	8	9	10	11	12
1	2	3	4	5	6	7	8	9	10	11	12	TOTAL
00-15												
15-30												
30-45												
45-00												
HOUR												
TOT												

AM PEAK HOUR 0730 TO 0830 VOLUME 45
 PM PEAK HOUR 1245 TO 0145 VOLUME 49

AM TOTAL 191
 PM TOTAL 273
 DAILY TOTAL 464

STATE OF WASHINGTON - DEPARTMENT OF TRANSPORTATION
 TRIP SYSTEM
 15 MINUTE TRAFFIC COUNT SUMMARY

SR	COUNT	IDENTIFIER	MP	10-003	OFF SYSTEM ID.	D	LEG W	DESCRIPTION:	ON NE	17TH AVE W/O NE	20TH AVE	LANE ALL	OF
04/22/10	12	1	2	3	4	5	6	7	8	9	10	11	12
	1	2	3	4	5	6	7	8	9	10	11	12	TOTAL
00-15			1			1	5	9					
15-30				1	1	7	6						
30-45					4	14	5						
45-00					1	3	8	12					
HOUR			1		2	9	34	32					
TOT													78

04/19/10 THRU 04/22/10
 TOTAL HOURS FOR COUNT 68

2 DAYS
 AVG WEEKDAY VOL 443 X SEASONAL ADJ. FACTOR 1.0000 = 443 X AXLE CORR FACTOR 1.0000 = ESTIMATED AVG DAILY TRAFFIC 443

AM PEAK HOUR 0615 TO 0715 VOLUME 38
 PM PEAK HOUR 0000 TO 0000 VOLUME 0

AM TOTAL 78
 PM TOTAL 0

04/19/10	MONDAY	AM HOURS	PM HOURS	TOT	AM PEAK HOUR 0000 TO 0000 VOLUME	PM PEAK HOUR 0345 TO 0445 VOLUME	AM TOTAL	PM TOTAL	DAILY TOTAL				
12	1	2	3	4	5	6	7	8	9	10	11	12	DAILY TOTAL
1	2	3	4	5	6	7	8	9	10	11	12		
00-15													
15-30													
30-45													
45-00													
HOUR													
TOT													518

04/20/10	TUESDAY	AM HOURS	PM HOURS	TOT	AM PEAK HOUR 0000 TO 0000 VOLUME	PM PEAK HOUR 0345 TO 0445 VOLUME	AM TOTAL	PM TOTAL	DAILY TOTAL				
12	1	2	3	4	5	6	7	8	9	10	11	12	DAILY TOTAL
1	2	3	4	5	6	7	8	9	10	11	12		
00-15													
15-30													
30-45													
45-00													
HOUR													
TOT													973

04/21/10	WEDNESDAY	AM HOURS	PM HOURS	TOT	AM PEAK HOUR 0715 TO 0815 VOLUME	PM PEAK HOUR 0430 TO 0530 VOLUME	AM TOTAL	PM TOTAL	DAILY TOTAL				
12	1	2	3	4	5	6	7	8	9	10	11	12	DAILY TOTAL
1	2	3	4	5	6	7	8	9	10	11	12		
00-15													
15-30													
30-45													
45-00													
HOUR													
TOT													878

AM PEAK HOUR 0730 TO 0830 VOLUME 80
 PM PEAK HOUR 0315 TO 0415 VOLUME 83

SR	COUNT	IDENTIFIER	MP	10-003	OFF SYSTEM ID.	D	LEG W	DESCRIPTION: ON NE 17TH AVE W/O NE 20TH AVE	DIRECTION OF TRAFFIC	BOTH WAYS	LANE ALL OF			
04/22/10	12	1	2	3	4	5	6	7	8	9	10	11	12	DAILY TOTAL
	1	2	3	4	5	6	7	8	9	10	11	12	TOTAL	
00-15	1		4		1	10	19							
15-30			1		3	15	20							
30-45					5	22	18							
45-00					2	4	22							
HOUR	1		5		3	13	69	57						148
TOT														

04/19/10 THRU 04/22/10 TOTAL HOURS FOR COUNT 67
 AM PEAK HOUR 0630 TO 0730 VOLUME 83
 PM PEAK HOUR 0000 TO 0000 VOLUME 0
 AM TOTAL 148
 PM TOTAL 0

2 DAYS AVG WEEKDAY VOL 926 X SEASONAL ADJ. FACTOR 1.0000 = 926 X AXLE CORR FACTOR 1.0000 = ESTIMATED AVG DAILY TRAFFIC 926
 PEAK HOUR PERCENTAGES: K = 10.48 D = 58.76
 PEAK HOUR LOCATION : VOLUME = 97 DATE: 04/20/10 TIME: 07:15 AM



Diamond Traffic Counter

Interval 60 min. 15 min.
 Binned(CL/SP) Count(volume)
 Lane No 1 2

Direction Channel 1 _____
 Direction Channel 2 _____
 Data Hog # _____ Site #21W - _____

Counter No. 175867 Count ID SP#10-003
 SR 205 RRT/RRQ _____ MP 36.75
 Leg E Direction WB OSID D

Station Description ON NE 139TH ST E/O NE 20TH AVE

Date	Day	Time	Comments	
4/19/10	Mon	1133	AM Manual (1) <u>5</u> (2) _____ Counter (1) <u>5</u> (2) _____	64 PM Manual (1) (2) _____ Counter (1) (2) _____
4/20/10	Tue	1000	AM Manual (1) <u>14</u> (2) _____ Counter (1) <u>14</u> (2) _____	66 PM Manual (1) (2) _____ Counter (1) (2) _____
4/21/10	Wed	0934	AM Manual (1) <u>7</u> (2) _____ Counter (1) <u>7</u> (2) _____	6.7 PM Manual (1) (2) _____ Counter (1) (2) _____
4/22/10	Thu	0715	AM Manual (1) <u>1</u> (2) _____ Counter (1) <u>1</u> (2) _____	6.4
			Manual (1) _____ (2) _____ Counter (1) _____ (2) _____	

Sketch

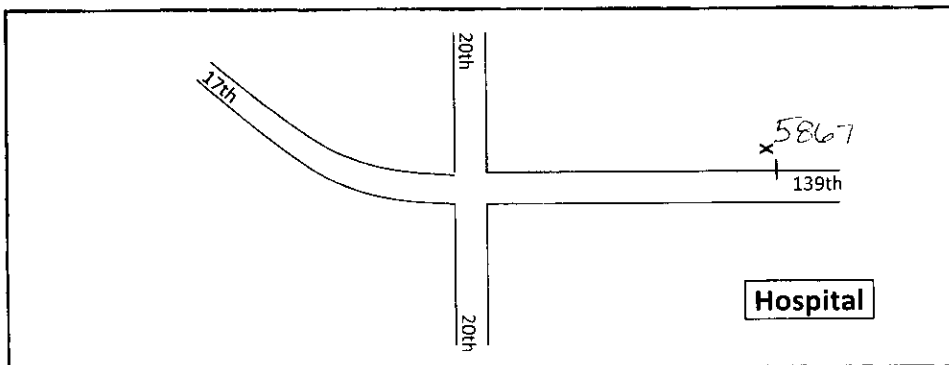

North

R. Hamrick

Field Person



Washington State
Department of Transportation

Diamond Traffic Counter

Interval 60 min. 15 min.
 Binned(CL/SP) Count(volume)
Lane No 1 2

Direction Channel 1 _____
Direction Channel 2 _____
Data Hog # _____ Site #21E - _____

Counter No. 178692 Count ID SP#10-003
SR 205 RRT/RRQ _____ MP 36.75
Leg E Direction EB OSID D

Station Description ON NE 139TH ST E/O NE 20TH AVE

Date	Day	Time	Comments	
4/19/10	Mon	1136	AM Manual (1) <u>5</u> (2) _____ Counter (1) <u>5</u> (2) _____	6.4 PM Manual (1) (2) _____ Counter (1) (2) _____
4/20/10	Tue	1005	AM Manual (1) <u>16</u> (2) _____ Counter (1) <u>16</u> (2) _____	6.6 PM Manual (1) (2) _____ Counter (1) (2) _____
4/21/10	Wed	0936	AM Manual (1) <u>10</u> (2) _____ Counter (1) <u>10</u> (2) _____	6.8 PM Manual (1) (2) _____ Counter (1) (2) _____
4/22/10	Thu	0718	AM Manual (1) <u>1</u> (2) _____ Counter (1) <u>1</u> (2) _____	6.3 PM Manual (1) (2) _____ Counter (1) (2) _____
			Manual (1) (2) _____ Counter (1) (2) _____	

Sketch

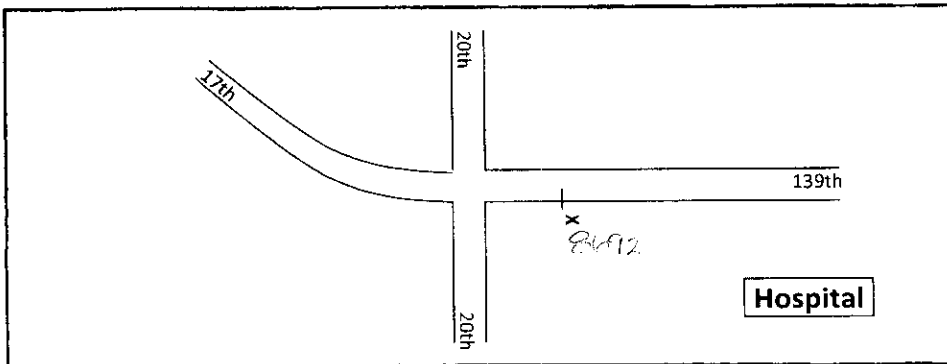

North

R. Hamrick

Field Person

SR 205 MP 036.75 OFF SYSTEM ID. D LEG E DIRECTION OF TRAFFIC WESTBOUND LANE ALL OF
 COUNT IDENTIFIER 10-003 COUNTER NUMBER 175867 DESCRIPTION: ON NE 139TH ST E/O NE 20TH AVE

COUNT	IDENTIFIER	DATE	AM HOURS												DAILY TOTAL
			1	2	3	4	5	6	7	8	9	10	11	12	
00-15	12	04/19/10	1	2	3	4	5	6	7	8	9	10	11	12	58
15-30	1		2	3	4	5	6	7	8	9	10	11	12	208	
30-45														195	
45-00														287	
TOT														389	
														481	
														341	
														185	
														124	
														93	
														75	
														44	
														17	
														2497	

AM PEAK HOUR 0000 TO 0000 VOLUME 0 AM TOTAL 58
 PM PEAK HOUR 0345 TO 0445 VOLUME 515 PM TOTAL 2439

COUNT	IDENTIFIER	DATE	AM HOURS												DAILY TOTAL
			1	2	3	4	5	6	7	8	9	10	11	12	
00-15	12	04/20/10	1	2	3	4	5	6	7	8	9	10	11	12	17
15-30	1		2	3	4	5	6	7	8	9	10	11	12	14	
30-45														19	
45-00														9	
TOT														27	
														83	
														163	
														206	
														173	
														220	
														197	
														223	
														214	
														317	
														304	
														434	
														354	
														165	
														138	
														85	
														106	
														50	
														18	
														3546	

AM PEAK HOUR 1000 TO 1100 VOLUME 220 AM TOTAL 1138
 PM PEAK HOUR 0430 TO 0530 VOLUME 442 PM TOTAL 2408

COUNT	IDENTIFIER	DATE	AM HOURS												DAILY TOTAL
			1	2	3	4	5	6	7	8	9	10	11	12	
00-15	12	04/21/10	1	2	3	4	5	6	7	8	9	10	11	12	18
15-30	1		2	3	4	5	6	7	8	9	10	11	12	10	
30-45														11	
45-00														6	
TOT														30	
														83	
														167	
														196	
														186	
														225	
														217	
														230	
														230	
														310	
														375	
														439	
														373	
														185	
														120	
														102	
														104	
														51	
														22	
														3700	

AM PEAK HOUR 1000 TO 1100 VOLUME 225 AM TOTAL 1159
 PM PEAK HOUR 0430 TO 0530 VOLUME 472 PM TOTAL 2541

SR 205	MP 036.75	OFF SYSTEM ID.	D	LEG E	DIRECTION OF TRAFFIC	WESTBOUND	LANE ALL	OF						
COUNT IDENTIFIER	10-003	COUNTER NUMBER	175867	DESCRIPTION:	ON NE 139TH ST E/O NE 20TH AVE									
04/22/10 THURSDAY		AM HOURS				PM HOURS		DAILY						
	12	1	2	3	4	5	6	7	8	9	10	11	12	TOTAL
	1	2	3	4	5	6	7	8	9	10	11	12	TOTAL	
00-15	4	4	4	1	3	4	16	40						
15-30	2	3	3	1	7	7	21							
30-45	2	6	3	2	13	13	25							
45-00	3	4	7	2	12	12	29							
HOUR														
TOT	11	17	13	8	9	36	91	40						225

AM PEAK HOUR 0615 TO 0715 VOLUME 115

PM PEAK HOUR 0000 TO 0000 VOLUME 0

AM TOTAL 225

PM TOTAL 0

04/19/10 THRU 04/22/10 TOTAL HOURS FOR COUNT 67

2 DAYS AVG WEEKDAY VOL 3623 X SEASONAL ADJ. FACTOR 1.0000 = 3623 X AXLE CORR FACTOR 1.0000 = ESTIMATED AVG DAILY TRAFFIC 3623

SR 205 MP 036.75 OFF SYSTEM ID. D LEG E DIRECTION OF TRAFFIC EASTBOUND LANE ALL OF

COUNT IDENTIFIER 10-003 COUNTER NUMBER 178692 DESCRIPTION: ON NE 139TH ST E/O NE 20TH AVE

04/19/10 MONDAY	AM HOURS												PM HOURS												DAILY TOTAL
	1	2	3	4	5	6	7	8	9	10	11	12	1	2	3	4	5	6	7	8	9	10	11	12	
12	1	2	3	4	5	6	7	8	9	10	11	12	1	2	3	4	5	6	7	8	9	10	11	12	1486
00-15																									
15-30																									
30-45																									
45-00																									
HOUR																									
TOT	15	5	6	1	4	19	54	138	191	152	168	119	161	194	182	163	162	146	145	100	80	49	24	15	2293

AM PEAK HOUR 0000 TO 0000 VOLUME 0
PM PEAK HOUR 0345 TO 0445 VOLUME 231

AM TOTAL 35
PM TOTAL 1451

04/20/10 TUESDAY	AM HOURS												PM HOURS												DAILY TOTAL
	1	2	3	4	5	6	7	8	9	10	11	12	1	2	3	4	5	6	7	8	9	10	11	12	
12	1	2	3	4	5	6	7	8	9	10	11	12	1	2	3	4	5	6	7	8	9	10	11	12	2251
00-15																									
15-30																									
30-45																									
45-00																									
HOUR																									
TOT	5	9	6	1	3	16	54	129	173	160	141	161	163	189	175	164	175	138	144	92	66	49	26	12	2251

AM PEAK HOUR 0815 TO 0915 VOLUME 174
PM PEAK HOUR 0115 TO 0215 VOLUME 190

AM TOTAL 858
PM TOTAL 1393

04/21/10 WEDNESDAY	AM HOURS												PM HOURS												DAILY TOTAL
	1	2	3	4	5	6	7	8	9	10	11	12	1	2	3	4	5	6	7	8	9	10	11	12	
12	1	2	3	4	5	6	7	8	9	10	11	12	1	2	3	4	5	6	7	8	9	10	11	12	872
00-15																									
15-30																									
30-45																									
45-00																									
HOUR																									
TOT	15	5	6	1	4	19	54	138	191	152	168	119	161	194	182	163	162	146	145	100	80	49	24	15	2293

AM PEAK HOUR 0800 TO 0900 VOLUME 191
PM PEAK HOUR 0130 TO 0230 VOLUME 199

AM TOTAL 872
PM TOTAL 1421

DOT-RNB515A-B

STATE OF WASHINGTON - DEPARTMENT OF TRANSPORTATION
TRIP SYSTEM
15 MINUTE TRAFFIC COUNT SUMMARY

DATE 04/26/10
TIME 12:55:01
PAGE 89

SR 205	MP 036.75	OFF SYSTEM ID. D	LEG E	DIRECTION OF TRAFFIC EASTBOUND	LANE ALL OF								
COUNT IDENTIFIER 10-003	COUNTER NUMBER 178692	DESCRIPTION: ON NE 139TH ST E/O NE 20TH AVE											
04/22/10 THURSDAY	AM HOURS			PM HOURS	DAILY TOTAL								
12	1	2	3	4	5	6	7	8	9	10	11	12	TOTAL
1	2	3	4	5	6	7	8	9	10	11	12	TOTAL	
00-15	1	2	1	1	3	1	22						
15-30	1	3	2	2	1	1	11						
30-45	6	1	1	2	1	15							
45-00	3	1	1	9	15								
HOUR	TOT	10	6	5	5	2	15	57	22				122

AM PEAK HOUR 0615 TO 0715 VOLUME 78
PM PEAK HOUR 0000 TO 0000 VOLUME 0

AM TOTAL 122
PM TOTAL 0

04/19/10 THRU 04/22/10
TOTAL HOURS FOR COUNT 67

2 DAYS
AVG WEEKDAY VOL 2272 X SEASONAL ADJ. FACTOR 1.0000 = 2272 X AXLE CORR FACTOR 1.0000 = ESTIMATED AVG DAILY TRAFFIC 2272

STATE OF WASHINGTON - DEPARTMENT OF TRANSPORTATION
TRIP SUMMARY
15 MINUTE TRAFFIC COUNT SUMMARY

SR 205 MP 036.75 OFF SYSTEM ID. D LEG E DIRECTION OF TRAFFIC BOTH WAYS LANE ALL OF

COUNT IDENTIFIER 10-003 COUNTER NUMBER 178692 DESCRIPTION: ON NE 139TH ST E/O NE 20TH AVE

04/19/10	MONDAY												DAILY TOTAL			
	12	1	2	3	4	5	6	7	8	9	10	11		12		
00-15																
15-30	12	1	2	3	4	5	6	7	8	9	10	11	12			
30-45	1	2	3	4	5	6	7	8	9	10	11	12				
45-00																
HOUR																
TOT																

AM PEAK HOUR 0000 TO 0000 VOLUME 0
PM PEAK HOUR 0345 TO 0445 VOLUME 746

AM TOTAL 93
PM TOTAL 3890

04/20/10	TUESDAY												DAILY TOTAL			
	12	1	2	3	4	5	6	7	8	9	10	11		12		
00-15																
15-30	7	7	8	8	1	2	21	54	82	70	83	79	92	102	119	105
30-45	7	6	8	8	3	5	8	73	96	79	92	83	102	102	122	124
45-00	4	2	4	4	1	17	36	85	90	88	99	100	113	121	98	149
HOUR																
TOT	22	23	25	10	13	43	137	292	379	333	361	358	386	403	492	468

AM PEAK HOUR 0800 TO 0900 VOLUME 379
PM PEAK HOUR 0400 TO 0500 VOLUME 609

AM TOTAL 1996
PM TOTAL 3801

04/21/10	WEDNESDAY												DAILY TOTAL			
	12	1	2	3	4	5	6	7	8	9	10	11		12		
00-15																
15-30	12	1	2	3	4	5	6	7	8	9	10	11	12			
30-45	9	5	4	3	2	2	7	32	108	91	99	84	105	105	151	134
45-00	7	4	4	3	1	12	35	76	115	90	96	94	101	118	110	130
HOUR																
TOT	33	15	17	7	14	49	137	305	387	338	393	336	391	424	492	538

AM PEAK HOUR 1000 TO 1100 VOLUME 393
PM PEAK HOUR 0415 TO 0515 VOLUME 619

AM TOTAL 2031
PM TOTAL 3962

DOT-RN8515A-B

STATE OF WASHINGTON - DEPARTMENT OF TRANSPORTATION
TRIP SYSTEM
15 MINUTE TRAFFIC COUNT SUMMARY

DATE 04/26/10
TIME 12:55:01
PAGE 91

SR 205 MP 036.75 OFF SYSTEM ID. D LEG E DIRECTION OF TRAFFIC BOTH WAYS LANE ALL OF

COUNT IDENTIFIER 10-003 COUNTER NUMBER 178692 DESCRIPTION: ON NE 139TH ST E/O NE 20TH AVE

04/22/10	THURSDAY	AM HOURS												DAILY TOTAL			
		1	2	3	4	5	6	7	8	9	10	11	12				
00-15	5	6	1	2	3	7	17	62									
15-30	2	6	5	5	2	10	32										
30-45	8	7	4	4	2	13	40										
45-00	6	4	8	2	4	21	59										
TOT	21	23	18	13	11	51	148	62									347

AM PEAK HOUR 0615 TO 0715 VOLUME 193
PM PEAK HOUR 0000 TO 0000 VOLUME 0

AM TOTAL 347
PM TOTAL 0

04/19/10 THRU 04/22/10
TOTAL HOURS FOR COUNT 67

2 DAYS AVG WEEKDAY VOL 5895 X SEASONAL ADJ. FACTOR 1.0000 = 5895 X AXLE CORR FACTOR 1.0000 = ESTIMATED AVG DAILY TRAFFIC 5895

PEAK HOUR PERCENTAGES: K = 12.65 D = 69.03
PEAK HOUR LOCATION : VOLUME = 746 DATE: 04/19/10 TIME: 03:45 PM

Diamond Traffic Counter

Interval 60 min. 15 min.
 Binned(CL/SP) Count(volume)
Lane No 1 2

Direction Channel 1 _____
Direction Channel 2 _____
Data Hog # _____ Site #22S - _____

Counter No. 175886 Count ID SP#10-003
SR 205 RRT/RRQ _____ MP 36.75
Leg N Direction SB OSID D

Station Description ON NE 20TH AVE N/O ~~139TH ST/17TH ST~~ NE 139TH ST/NE 17TH AVE

Date	Day	Time	Comments	
4/19/10	Mon	1151	AM Manual (1) <u>5</u> (2) _____ Counter (1) <u>5</u> (2) _____	6.4 PM Manual (1) _____ (2) _____ Counter (1) _____ (2) _____
4/20/10	Tue	0917	AM Manual (1) <u>37</u> (2) _____ Counter (1) <u>37</u> (2) _____	6.4 PM Manual (1) _____ (2) _____ Counter (1) _____ (2) _____
4/21/10	Wed	0915	AM Manual (1) <u>10</u> (2) _____ Counter (1) <u>10</u> (2) _____	6.8 PM Manual (1) _____ (2) _____ Counter (1) _____ (2) _____
4/22/10	Thu	0755	AM Manual (1) <u>1</u> (2) _____ Counter (1) <u>1</u> (2) _____	6.5 PM Manual (1) _____ (2) _____ Counter (1) _____ (2) _____
			Manual (1) _____ (2) _____ Counter (1) _____ (2) _____	

Sketch

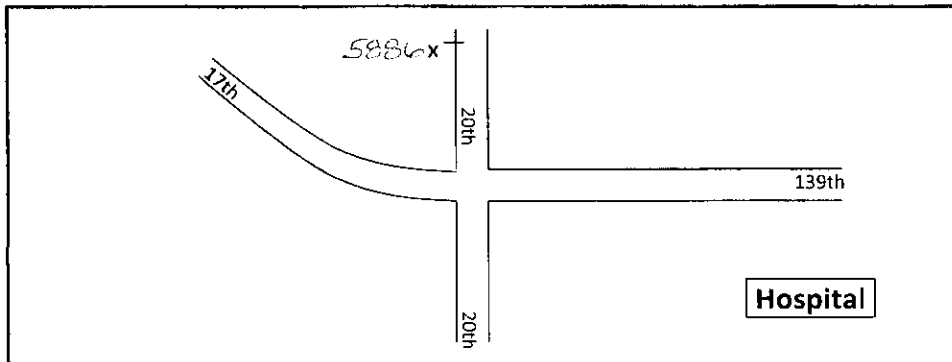

R. Hamrick

Field Person



Diamond Traffic Counter

Interval 60 min. 15 min.
 Binned(CL/SP) Count(volume)
 Lane No 1 2

Direction Channel 1 _____
 Direction Channel 2 _____
 Data Hog # _____ Site #22N - _____

Counter No. 175889 Count ID SP#10-003
 SR 205 RRT/RRQ _____ MP 36.75
 Leg N Direction NB OSID D

Station Description ON NE 20TH AVE N/O ~~139TH ST / 17TH ST~~ NE 139TH ST / NE 17TH AVE

Date	Day	Time	Comments	
4/19/10	Mon	1148	AM Manual (1) <u>5</u> (2) _____ Counter (1) <u>5</u> (2) _____	6.5 PM Manual (1) _____ (2) _____ Counter (1) _____ (2) _____
4/20/10	Tue	0953	AM Manual (1) <u>43</u> (2) _____ Counter (1) <u>43</u> (2) _____	6.7 PM Manual (1) _____ (2) _____ Counter (1) _____ (2) _____
4/21/10	Wed	0931	AM Manual (1) <u>13</u> (2) _____ Counter (1) <u>13</u> (2) _____	7.0 PM Manual (1) _____ (2) _____ Counter (1) _____ (2) _____
4/22/10	Thu	0753	AM Manual (1) <u>1</u> (2) _____ Counter (1) <u>1</u> (2) _____	6.5 PM Manual (1) _____ (2) _____ Counter (1) _____ (2) _____
			Manual (1) _____ (2) _____ Counter (1) _____ (2) _____	

Sketch

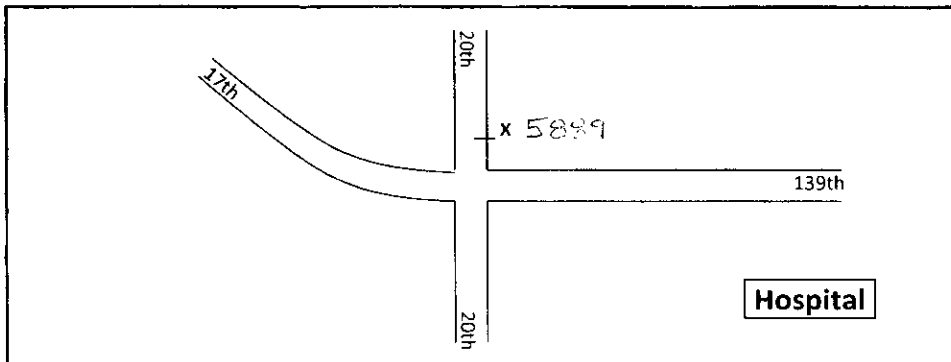

North

R. Hamrick

Field Person

SR 205 MP 036.75 OFF SYSTEM ID. D LEG N DIRECTION OF TRAFFIC BOTH WAYS LANE ALL OF

COUNT IDENTIFIER 10-003 COUNTER NUMBER 175889 DESCRIPTION: ON NE 20TH AVE N/O NE 139TH ST/NE 17TH AVE

04/19/10	MONDAY												DAILY TOTAL	
	AM HOURS													
	1	2	3	4	5	6	7	8	9	10	11	12		
00-15	12	1	2	3	4	5	6	7	8	9	10	11	12	
15-30	1	2	3	4	5	6	7	8	9	10	11	12		
30-45														
45-00														
HOUR														
TOT														

AM PEAK HOUR 0000 TO 0000 VOLUME 0
PM PEAK HOUR 0330 TO 0430 VOLUME 1350

AM TOTAL 0
PM TOTAL 9355

04/20/10	TUESDAY												DAILY TOTAL												
	AM HOURS																								
	1	2	3	4	5	6	7	8	9	10	11	12													
00-15	12	1	2	3	4	5	6	7	8	9	10	11	12												
15-30	1	2	3	4	5	6	7	8	9	10	11	12													
30-45																									
45-00																									
HOUR																									
TOT	46	35	22	25	42	113	343	712	814	828	908	1002	1135	1043	1153	1213	1260	1293	906	554	376	280	143	73	14319

AM PEAK HOUR 1100 TO 1200 VOLUME 1002
PM PEAK HOUR 0430 TO 0530 VOLUME 1336

AM TOTAL 4890
PM TOTAL 9429

04/21/10	WEDNESDAY												DAILY TOTAL												
	AM HOURS																								
	1	2	3	4	5	6	7	8	9	10	11	12													
00-15	12	1	2	3	4	5	6	7	8	9	10 <td>11</td> <td>12</td> <td></td>	11	12												
15-30	1	2	3	4	5	6	7	8	9	10	11	12													
30-45																									
45-00																									
HOUR																									
TOT	25	36	22	34	44	119	331	737	825	790	932	978	1035	1077	1170	1205	1253	1214	898	589	510	343	154	78	14399

AM PEAK HOUR 1100 TO 1200 VOLUME 978
PM PEAK HOUR 0400 TO 0500 VOLUME 1253

AM TOTAL 4873
PM TOTAL 9526

