



T

Interval 60 min. 15 min.
 Binned(CL/SP) Count(volume)
Lane No 1 2

Direction Channel 1 BW
Direction Channel 2 WB
Unique ID# _____

Counter No. 412298 Count ID HPMS
SR 501 RRT/RRQ _____ MP 16.91
Leg 2 Direction See 1,2 OSID _____

Station Description ON SR 501 E/O S MAIN St AVE / N MAIN St AVE

Date	Day	Time	Comments									
10/8/12	2	1251	<table border="0"> <tr> <td>Manual (1)</td> <td>1</td> <td>(2)</td> <td>1</td> <td rowspan="2">SET COUNTER OK DB/BJ</td> </tr> <tr> <td>Counter (1)</td> <td>1</td> <td>(2)</td> <td>1</td> </tr> </table> <p style="text-align: right;">6.3</p>	Manual (1)	1	(2)	1	SET COUNTER OK DB/BJ	Counter (1)	1	(2)	1
Manual (1)	1	(2)	1	SET COUNTER OK DB/BJ								
Counter (1)	1	(2)	1									
10/09	3	1158	<table border="0"> <tr> <td>Manual (1)</td> <td>12</td> <td>(2)</td> <td>5</td> <td rowspan="2">CHECK COUNTER OK</td> </tr> <tr> <td>Counter (1)</td> <td>12</td> <td>(2)</td> <td>5</td> </tr> </table> <p style="text-align: right;">6.6</p>	Manual (1)	12	(2)	5	CHECK COUNTER OK	Counter (1)	12	(2)	5
Manual (1)	12	(2)	5	CHECK COUNTER OK								
Counter (1)	12	(2)	5									
10/10	4	1002	<table border="0"> <tr> <td>Manual (1)</td> <td>3</td> <td>(2)</td> <td>2</td> <td rowspan="2">COUNTER CHECK OK</td> </tr> <tr> <td>Counter (1)</td> <td>3</td> <td>(2)</td> <td>2</td> </tr> </table> <p style="text-align: right;">6.2</p>	Manual (1)	3	(2)	2	COUNTER CHECK OK	Counter (1)	3	(2)	2
Manual (1)	3	(2)	2	COUNTER CHECK OK								
Counter (1)	3	(2)	2									
10/11	5	0930	<table border="0"> <tr> <td>Manual (1)</td> <td>3</td> <td>(2)</td> <td>2</td> <td rowspan="2">CHECK COUNTER OK</td> </tr> <tr> <td>Counter (1)</td> <td>3</td> <td>(2)</td> <td>2</td> </tr> </table> <p style="text-align: right;">6.2</p>	Manual (1)	3	(2)	2	CHECK COUNTER OK	Counter (1)	3	(2)	2
Manual (1)	3	(2)	2	CHECK COUNTER OK								
Counter (1)	3	(2)	2									
10/12	6	0902	<table border="0"> <tr> <td>Manual (1)</td> <td>1</td> <td>(2)</td> <td></td> <td rowspan="2">P/U COUNTER OK DB/BJ</td> </tr> <tr> <td>Counter (1)</td> <td>1</td> <td>(2)</td> <td></td> </tr> </table> <p style="text-align: right;">6.4</p>	Manual (1)	1	(2)		P/U COUNTER OK DB/BJ	Counter (1)	1	(2)	
Manual (1)	1	(2)		P/U COUNTER OK DB/BJ								
Counter (1)	1	(2)										

Sketch

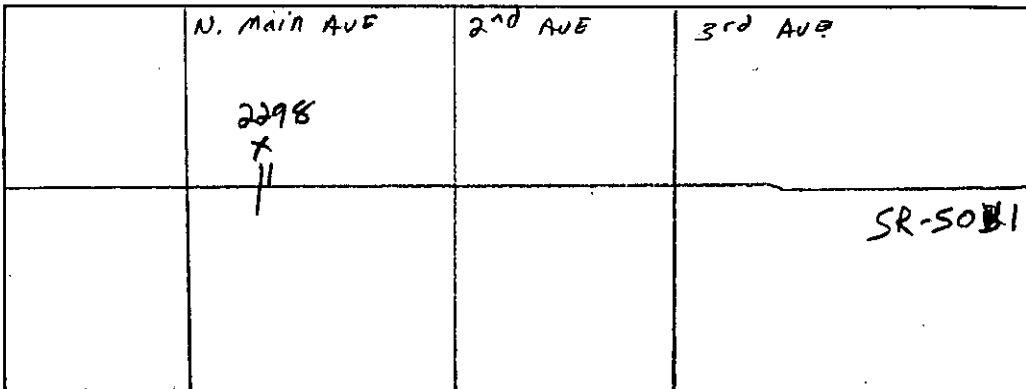

DB / BJ
Field Person

SR 501 MP 016.91 OFF SYSTEM ID. LEG 2 DIRECTION OF TRAFFIC WESTBOUND LANE ALL OF

COUNT IDENTIFIER HPMS COUNTER NUMBER 412298 DESCRIPTION: ON SR 501 E/O S MAIN ST/M MAIN ST

10/11/12 THURSDAY	AM HOURS	PM HOURS	AM TOTAL	PM TOTAL	DAILY TOTAL	
12	1	2	3	4	7	
1	2	3	4	5	9	
2	3	4	5	6	11	
3	4	5	6	7	13	
4	5	6	7	8	16	
5	6	7	8	9	19	
6	7	8	9	10	23	
7	8	9	10	11	27	
8	9	10	11	12	32	
9	10	11	12	1	37	
10	11	12	1	2	41	
11	12	1	2	3	45	
12	1	2	3	4	49	
13	2	3	4	5	53	
14	3	4	5	6	57	
15	4	5	6	7	61	
16	5	6	7	8	65	
17	6	7	8	9	69	
18	7	8	9	10	73	
19	8	9	10	11	77	
20	9	10	11	12	81	
21	10	11	12	1	85	
22	11	12	1	2	89	
23	12	1	2	3	93	
24	1	2	3	4	97	
25	2	3	4	5	101	
26	3	4	5	6	105	
27	4	5	6	7	109	
28	5	6	7	8	113	
29	6	7	8	9	117	
30	7	8	9	10	121	
31	8	9	10	11	125	
32	9	10	11	12	129	
33	10	11	12	1	133	
34	11	12	1	2	137	
35	12	1	2	3	141	
36	1	2	3	4	145	
37	2	3	4	5	149	
38	3	4	5	6	153	
39	4	5	6	7	157	
40	5	6	7	8	161	
41	6	7	8	9	165	
42	7	8	9	10	169	
43	8	9	10	11	173	
44	9	10	11	12	177	
45	10	11	12	1	181	
46	11	12	1	2	185	
47	12	1	2	3	189	
48	1	2	3	4	193	
49	2	3	4	5	197	
50	3	4	5	6	201	
TOT	3	4	4	6	17	1617

10/12/12 FRIDAY	AM HOURS	PM HOURS	AM TOTAL	PM TOTAL	DAILY TOTAL
12	1	2	3	4	7
1	2	3	4	5	9
2	3	4	5	6	11
3	4	5	6	7	13
4	5	6	7	8	15
5	6	7	8	9	17
6	7	8	9	10	19
7	8	9	10	11	21
8	9	10	11	12	23
9	10	11	12	1	25
10	11	12	1	2	27
11	12	1	2	3	29
12	1	2	3	4	31
13	2	3	4	5	33
14	3	4	5	6	35
15	4	5	6	7	37
16	5	6	7	8	39
17	6	7	8	9	41
18	7	8	9	10	43
19	8	9	10	11	45
20	9	10	11	12	47
21	10	11	12	1	49
22	11	12	1	2	51
23	12	1	2	3	53
24	1	2	3	4	55
25	2	3	4	5	57
26	3	4	5	6	59
27	4	5	6	7	61
28	5	6	7	8	63
29	6	7	8	9	65
30	7	8	9	10	67
31	8	9	10	11	69
32	9	10	11	12	71
33	10	11	12	1	73
34	11	12	1	2	75
35	12	1	2	3	77
36	1	2	3	4	79
37	2	3	4	5	81
38	3	4	5	6	83
39	4	5	6	7	85
40	5	6	7	8	87
41	6	7	8	9	89
42	7	8	9	10	91
43	8	9	10	11	93
44	9	10	11	12	95
45	10	11	12	1	97
46	11	12	1	2	99
47	12	1	2	3	101
48	1	2	3	4	103
49	2	3	4	5	105
50	3	4	5	6	107
TOT	7	5	2	4	146

10/08/12 THRU 10/12/12
 TOTAL HOURS FOR COUNT 92

3 DAYS
 AVG WEEKDAY VOL 1606 X SEASONAL ADJ. FACTOR 0.9400 = 1510 X AXLE CORR FACTOR 0.9326 = ESTIMATED AVG DAILY TRAFFIC 1408

FACTOR GROUP GR-02
 FACTOR GROUP GR-R3

AM PEAK HOUR 1030 TO 1130 VOLUME 116
 PM PEAK HOUR 0400 TO 0500 VOLUME 176

AM TOTAL 433
 PM TOTAL 1184

DOT-RNBS15A-8

STATE OF WASHINGTON - DEPARTMENT OF TRANSPORTATION
TRIP SUMMARY
15 MINUTE TRAFFIC COUNT SUMMARY

DATE 11/06/12
TIME 07:49:14
PAGE 41

SR 501 MP 016.91 OFF SYSTEM ID. LEG 2 DIRECTION OF TRAFFIC EASTBOUND LANE ALL OF
COUNT IDENTIFIER HPMS COUNTER NUMBER 412298 DESCRIPTION: ON SR 501 E/O S MAIN ST/N MAIN ST

10/08/12 MONDAY	12	1	2	3	4	5	6	7	8	9	10	11	12	DAILY TOTAL
AM HOURS	4	5	6	7	8	9	10	11	12	1	2	3	4	
PM HOURS	1	2	3	4	5	6	7	8	9	10	11	12		
00-15														
15-30														
30-45														
45-00														
TOT	81	71	56	74	80	64	41	25	12	5	8	517		
	AM PEAK HOUR 0000 TO 0000 VOLUME 0													AM TOTAL
	PM PEAK HOUR 0515 TO 0615 VOLUME 85													PM TOTAL
														517

10/09/12 TUESDAY	12	1	2	3	4	5	6	7	8	9	10	11	12	DAILY TOTAL
AM HOURS	4	5	6	7	8	9	10	11	12	1	2	3	4	
PM HOURS	1	2	3	4	5	6	7	8	9	10	11	12		
00-15														
15-30														
30-45														
45-00														
TOT	51	81	80	75	97	93	94	108	105	106	71	51	28	22
	AM PEAK HOUR 0700 TO 0800 VOLUME 92													AM TOTAL
	PM PEAK HOUR 0245 TO 0345 VOLUME 114													PM TOTAL
														469
														788
														1257

10/10/12 WEDNESDAY	12	1	2	3	4	5	6	7	8	9	10	11	12	DAILY TOTAL
AM HOURS	4	5	6	7	8	9	10	11	12	1	2	3	4	
PM HOURS	1	2	3	4	5	6	7	8	9	10	11	12		
00-15														
15-30														
30-45														
45-00														
TOT	79	79	71	94	80	62	97	100	127	85	72	75	39	22
	AM PEAK HOUR 0830 TO 0930 VOLUME 94													AM TOTAL
	PM PEAK HOUR 0400 TO 0500 VOLUME 127													PM TOTAL
														487
														771
														1258

DOT-RNB515A-B

STATE OF WASHINGTON - DEPARTMENT OF TRANSPORTATION
TRIP SYSTEM
15 MINUTE TRAFFIC COUNT SUMMARY

DATE 11/06/12
TIME 07:49:14
PAGE 42

SR 501

MP 016.91

OFF SYSTEM ID.

LEG 2

DIRECTION OF TRAFFIC EASTBOUND

LANE ALL OF

COUNT IDENTIFIER HPNS COUNTER NUMBER 412298 DESCRIPTION: ON SR 501 E/O S MAIN ST/N MAIN ST

10/11/12 THURSDAY		AM HOURS												PM HOURS												DAILY TOTAL			
COUNT	HPNS	1	2	3	4	5	6	7	8	9	10	11	12	1	2	3	4	5	6	7	8	9	10	11	12	AM TOTAL	PM TOTAL		
12	1	1	2	3	4	5	6	7	8	9	10	11	12	1	2	3	4	5	6	7	8	9	10	11	12	99	121	494	812
1	2	3	4	5	6	7	8	9	10	11	12	1	2	3	4	5	6	7	8	9	10	11	12	68	63	1311	1306		
TOT		5	5	3	10	23	41	95	68	63	90	94	79	68	99	121	104	94	81	82	39	15	18	12					

AM PEAK HOUR 0715 TO 0815 VOLUME 99
PM PEAK HOUR 0300 TO 0400 VOLUME 121

10/12/12 FRIDAY		AM HOURS												PM HOURS												DAILY TOTAL			
COUNT	HPNS	1	2	3	4	5	6	7	8	9	10	11	12	1	2	3	4	5	6	7	8	9	10	11	12	AM TOTAL	PM TOTAL		
12	1	1	2	3	4	5	6	7	8	9	10	11	12	1	2	3	4	5	6	7	8	9	10	11	12	69	0	209	0
1	2	3	4	5	6	7	8	9	10	11	12	1	2	3	4	5	6	7	8	9	10	11	12	69	0	138	209		
TOT		3	3	4	11	18	34	63	69																				

10/08/12 THRU 10/12/12
TOTAL HOURS FOR COUNT 92

3 DAYS AVG WEEKDAY VOL 1274 X SEASONAL ADJ. FACTOR 0.9400 = 1198 X AXLE CORR FACTOR 0.9326 = ESTIMATED AVG DAILY TRAFFIC 1117

FACTOR GROUP GR-02

FACTOR GROUP GR-R3

SR 501 MP 016.91 OFF SYSTEM ID. LEG 2 DIRECTION OF TRAFFIC BOTH WAYS LANE ALL OF
COUNT IDENTIFIER HPMS COUNTER NUMBER 412298 DESCRIPTION: ON SR 501 E/O S MAIN ST/N MAIN ST

10/11/12 THURSDAY	AM HOURS												PM HOURS												DAILY TOTAL
	1	2	3	4	5	6	7	8	9	10	11	12	1	2	3	4	5	6	7	8	9	10	11	12	
12	1	2	3	4	5	6	7	8	9	10	11	12	1	2	3	4	5	6	7	8	9	10	11	12	927
1	2	3	4	5	6	7	8	9	10	11	12	1	2	3	4	5	6	7	8	9	10	11	12	1996	
AM PEAK HOUR 1100 TO 1200 VOLUME 207																									AM TOTAL 927
PM PEAK HOUR 0345 TO 0445 VOLUME 286																									PM TOTAL 1996

10/12/12 FRIDAY	AM HOURS												PM HOURS												DAILY TOTAL
	1	2	3	4	5	6	7	8	9	10	11	12	1	2	3	4	5	6	7	8	9	10	11	12	
12	1	2	3	4	5	6	7	8	9	10	11	12	1	2	3	4	5	6	7	8	9	10	11	12	355
1	2	3	4	5	6	7	8	9	10	11	12	1	2	3	4	5	6	7	8	9	10	11	12	123	
AM PEAK HOUR 0800 TO 0900 VOLUME 123																									AM TOTAL 355
PM PEAK HOUR 0000 TO 0000 VOLUME 0																									PM TOTAL 0

10/08/12 THRU 10/12/12
TOTAL HOURS FOR COUNT 92

3 DAYS
AVG WEEKDAY VOL 2879 X SEASONAL ADJ. FACTOR 0.9400 = 2706 X AXLE CORR FACTOR 0.9326 = ESTIMATED AVG DAILY TRAFFIC 2524
FACTOR GROUP GR-02
FACTOR GROUP GR-R3
PEAK HOUR PERCENTAGES: K = 9.93 D = 58.39
PEAK HOUR LOCATION : VOLUME = 286 DATE: 10/11/12 TIME: 03:45 PM

Note: Count Lower